

Note: The depicted information is based on project data currently available. Project estimates and schedules will remain subject to further refinement as more definitive data becomes available.

### Map Legend

Right-of-Way Project	Interstate Highway
Utilities Project	State Highway
Roadway Project	U.S. Highway
Bridge Project	County Line
Toll Route	County Seat

# OKLAHOMA DEPARTMENT OF TRANSPORTATION

## 2017 to 2024 Construction Work Plan

### Division 5

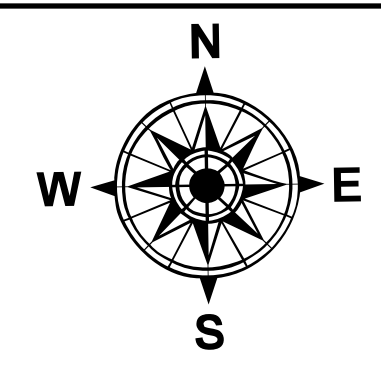

SH-33: GR DR SURF & BR OVER THE FARMRAIL R/R AND TWO RCBS LOCATED 13.1 MILES EAST OF THE US-183 JCT.	FFY 2019 GRADE, DRAINING, BRIDGE & SURFACE \$ 5,489,740
FFY 2017 RIGHT OF WAY \$ 286,000	FFY 2017 UTILITIES \$ 42,570
US-283: OVER DEAD WARRIOR CREEK	FFY 2017 BRIDGE & APPROACHES \$ 2,068,000
US-283 FR 8.0 MI NORTH OF THE BECKHAM C/L NORTH TO SH-47, IN CHEYENNE	FFY 2022 WIDEN, RESURFACE & BRIDGE \$ 9,576,044
I-40 BUSINESS IN ELK CITY: BRIDGE AND APPROACHES OVER THE EAST FORK OF ELK CREEK	FFY 2019 BRIDGE & APPROACHES \$ 1,438,420
I-40B: OVER ELK CREEK	FFY 2018 BRIDGE & APPROACHES \$ 3,473,160
I-40: SH-6 BOTH NB & SB BRIDGES OVER I-40 IN ELK CITY	FFY 2018 BRIDGE & APPROACHES \$ 9,385,360
FFY 2017 RIGHT OF WAY \$ 50,000	FFY 2017 UTILITIES \$ 9,485,360
SH-152, WIDEN AND RESURFACE BEGIN ON THE EAST SIDE OF THE SH-30 JCT AND EXTEND EAST 4.1 MILES.	FFY 2024 WIDEN & RESURFACE \$ 8,500,000
FFY 2019 RIGHT OF WAY \$ 327,000	FFY 2019 UTILITIES \$ 9,154,000
SH-152, WIDEN AND RESURFACE BEGIN AT THE TEXAS S/L AND EXTEND EAST TO THESH-30 JCT. THIS PROJECT HAS A 1.2 MILE EXCEPTION.	FFY 2023 WIDEN & RESURFACE \$ 8,861,000
FFY 2017 RIGHT OF WAY \$ 359,906	FFY 2017 UTILITIES \$ 359,906
I-40: RESURFACE FROM MILE MARKER 32.96 TO 40.00 WITH MINOR BRIDGE WORK.	FFY 2017 RESURFACE \$ 11,363,000
SH-34 OVER CRI & P RAILROAD	FFY 2021 BRIDGE & APPROACHES \$ 4,516,000
FFY 2017 RIGHT OF WAY \$ 39,313	FFY 2017 UTILITIES \$ 13,544
I-40B OVER THE NORTH FORK OF THE RED RIVER AND SHORT CREEK LOCATED 1.4 AND 1.8 MILES NORTH OF I-40 IN SAYRE.	FFY 2018 GRADE, DRAINING, BRIDGE & SURFACE \$ 11,518,490
I-40, REHAB EB & WB BRIDGES OVER THE N FORK OF RED RIVER	FFY 2021 BRIDGE REHABILITATION \$ 6,539,000
I-40: REHAB BRIDGES OVER US-283	FFY 2023 BRIDGE REHABILITATION \$ 4,750,000
I-40: REPLACE BRIDGES OVER TURKEY CR (EAST & WEST BOUND) AND SAND CR EASTBOUND	FFY 2024 BRIDGE & APPROACHES \$ 6,000,000
I-40 BUSINESS IN ERICK: BRIDGE AND APPROACHES OVER LITTLE TURKEY CREEK	FFY 2019 BRIDGE & APPROACHES \$ 2,168,760
SH-152 FROM N/S SH-6 JCT AND EXT EAST 4.0 MI	FFY 2017 GRADE, DRAINING, BRIDGE & SURFACE \$ 4,363,000
SH-6: OVER SADLER CREEK LOCATED	FFY 2019 BRIDGE & APPROACHES \$ 1,769,140
SH-34: OVER THE NORTH FORK OF THE RED RIVER & O'FLON	FFY 2022 GRADE, DRAINING, BRIDGE & SURFACE \$ 15,842,000
SH-6: BEGIN 5.2 MI. S. OF THE SH-55E JCT. IN BECKHAM CO. & EXT. N. 5.0 MI. (4 LANE DIVIDED - TURKEY), INCLUDES OLD PROJECT 15027(07).	FFY 2019 GRADE, DRAINING, BRIDGE & SURFACE \$ 15,042,000
SH-30: OVER ELM FORK OF THE RED RIVER	FFY 2017 BRIDGE & APPROACHES \$ 4,900,000
SH-6, RESURFACE THE NORTH BOUND LANES BEGIN 1.0 MILE NORTH OF SH-9 AND EXTEND NORTH 4.0 MILES.	FFY 2020 RESURFACE \$ 1,120,849
US-283, THE ELM FORK OF THE RED RIVER & OVERFLOW	FFY 2020 BRIDGE & APPROACHES \$ 11,089,720
SH-30: OVER SALT FORK OF RED RIVER. NEEDS TO STAY 100% STATE FUNDED.	FFY 2017 BRIDGE & APPROACHES \$ 8,053,000
SH-30: REPLACE THIRTEEN WOODEN ROADWAY SIZE BOXES, VARIOUS LOCATIONS	FFY 2022 GRADE, DRAIN & SURFACE \$ 1,500,000
FFY 2021 RIGHT OF WAY \$ 10,000	FFY 2021 UTILITIES \$ 1,520,000
SH-19, BRIDGE AND APPROACHES OVER THE N. FORK OF THE RED RIVER	FFY 2023 BRIDGE & APPROACHES \$ 9,000,000
FFY 2019 RIGHT OF WAY \$ 109,000	FFY 2019 UTILITIES \$ 109,000
SH-6: BRIDGE AND APPROACHES OVER UNNAMED CREEK	FFY 2019 BRIDGE & APPROACHES \$ 1,208,400
FFY 2017 RIGHT OF WAY \$ 34,215	FFY 2017 UTILITIES \$ 10,278
SH-5, OVER THE NORTH FORK OF THE RED RIVER & THE RED RIVER OVERFLOW	FFY 2020 BRIDGE & APPROACHES \$ 9,064,500
FFY 2017 RIGHT OF WAY \$ 79,360	FFY 2017 UTILITIES \$ 22,638
SH-5: BRIDGE AND APPROACHES OVER SANDY CREEK	FFY 2019 BRIDGE & APPROACHES \$ 2,530,220
US-283: BEGIN APPROX 0.5 MILE NORTH OF THE RED RIVER BRIDGE & EXTEND NORTH 4.25 MILE.	FFY 2019 WIDEN, RESURFACE & BRIDGE \$ 6,537,020

US-270: BEGIN 5.7 MILES SE OF THE SH-51 WEST JCT AND EXTEND SE 3.4 MILESTHROUGH THE SH-51 EAST JCT (CONSTRUCT AS 4 LANE DIV & REHAB EXISTING LANES)	FFY 2017 GRADE, DRAIN & SURFACE \$ 11,000,000
US-60: REPLACE BRIDGES OVER COTTONWOOD AND KIZER CREEKS	FFY 2024 BRIDGE & APPROACHES \$ 5,000,000
FFY 2021 RIGHT OF WAY \$ 100,000	FFY 2021 UTILITIES \$ 5,200,000
US-270, BEGIN 0.4 MI SE OF THE SH-51 E JCT AND EXTEND SE 4.9 MILES. TURKEY PROJECT (CONSTRUCT AS 4 LANE DIV & REHAB EXISTING LANES)	FFY 2020 GRADE, DRAINING, BRIDGE & SURFACE \$ 20,000,000
US-183: FROM 16.13 MILES N OF THE CUSTER C/L AND EXTEND NORTH 1.41 MILES. (STARTING AT THE NORTH CITY LIMITS OF TALOGA.) (ROADWAY PROTION)	FFY 2018 GRADE, DRAINING, BRIDGE & SURFACE \$ 3,877,950
US 270 FROM 5.4 MI SOUTH OF SH 51 EAST JCT AND EXT SE 3.0 MILES. TURKEY PROJECT (CONSTRUCT AS 4 LANE DIV & REHAB EXISTING LANES)	FFY 2021 GRADE, DRAIN & SURFACE \$ 13,000,000
SH-34, REPLACE THE S CANADIAN RIVER BRIDGE	FFY 2021 BRIDGE & APPROACHES \$ 12,500,000
FFY 2018 RIGHT OF WAY \$ 106,000	FFY 2018 UTILITIES \$ 109,000
SH 3/US 270 FROM 8.4 MI SE OF THE SH-51 EAST JCT AND EXT SE 5.0 MILES. TURKEY PROJECT (CONSTRUCT AS 4 LANE DIV & REHAB EXISTING LANES)	FFY 2023 GRADE, DRAIN & SURFACE \$ 16,000,000
US-270: BEGIN 6.35 MILES NN OF THE SH-50 JCT (NS-243) AND EXT SE 3.25 MILES. (CONST 4 LANE DIVIDED AND REHAB EXISTING LANES)	FFY 2024 GRADE, DRAIN & SURFACE \$ 12,000,000

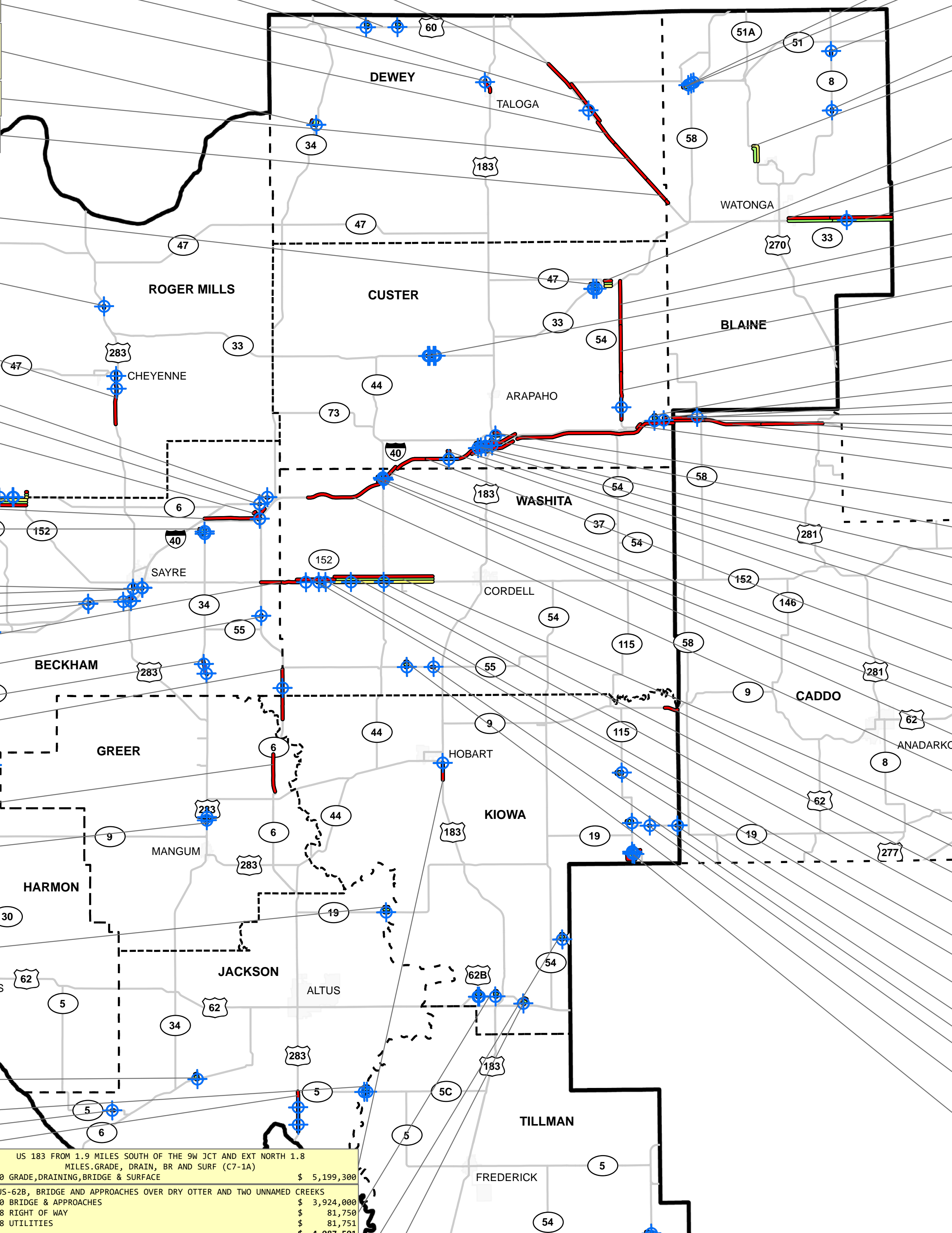

US 183 FROM 1.9 MILES SOUTH OF THE SW JCT AND EXT NORTH 1.8 MILES. GRADE, DRAIN, BR AND SURF (C7-1A)	FFY 2020 GRADE, DRAINING, BRIDGE & SURFACE \$ 5,199,300
US-62B, BRIDGE AND APPROACHES OVER DRY OTTER AND TWO UNNAMED CREEKS	FFY 2020 BRIDGE & APPROACHES \$ 3,924,000
FFY 2018 RIGHT OF WAY \$ 81,750	FFY 2018 UTILITIES \$ 81,751
SH-49, BRIDGE AND APPROACHES OVER AN UNNAMED CREEK	FFY 2020 BRIDGE & APPROACHES \$ 190,750
FFY 2018 RIGHT OF WAY \$ 54,500	FFY 2018 UTILITIES \$ 299,750
US-62B: OVER E. FORK DEEP RED CREEK, 2.4 MI EAST OF US-183	FFY 2019 BRIDGE & APPROACHES \$ 983,680
FFY 2017 RIGHT OF WAY \$ 39,000	FFY 2017 UTILITIES \$ 85,818
US-70, OVER BOTTLE AND SUTTLE CREEKS	FFY 2021 BRIDGE & APPROACHES \$ 3,617,000
FFY 2017 RIGHT OF WAY \$ 30,000	FFY 2017 UTILITIES \$ 25,327
SH-36 BRIDGE AND APPROACHES OVER A TRIBE OF LITTLE DEEP RED CREEK AND TWO BOX EXTENSIONS	FFY 2022 BRIDGE & APPROACHES \$ 2,181,000
FFY 2019 RIGHT OF WAY \$ 109,000	FFY 2019 UTILITIES \$ 189,000

SH-51, OVER N. CANADIAN RIVER & OVERFLOW	FFY 2018 BRIDGE & APPROACHES \$ 5,306,560
SH-58: OVER MINNEHAHA CREEK	FFY 2020 BRIDGE & APPROACHES \$ 1,616,819
FFY 2017 RIGHT OF WAY \$ 105,825	FFY 2017 UTILITIES \$ 20,158
SH-8: BRIDGE AND APPROACHES OVER SPRING CREEK	FFY 2018 BRIDGE & APPROACHES \$ 1,854,000
SH-8: BRIDGE AND APPROACHES OVER SALT CREEK	FFY 2018 BRIDGE & APPROACHES \$ 2,678,000
SH-51A: CURVE REALIGNMENT, LOCATED 7.5 MILES SOUTH OF SOUTHWARD RW FOR 20932(04)	FFY 2018 RIGHT OF WAY \$ 141,110
FFY 2018 UTILITIES \$ 169,950	SH-33, RECONSTRUCT PAVEMENT BEG 0.37 M EAST OF SH-47 AND EXT EAST .67 MILE IN THE CITY OF THOMAS (WEST SIDE OF 10TH STREET TO EAST SIDE OF 1ST STREET)
FFY 2023 RECONSTRUCT-NO ADDED LANES \$ 5,500,000	FFY 2019 RIGHT OF WAY \$ 272,500
FFY 2019 UTILITIES \$ 272,500	SH-3: BEGIN 1.0 MILE EAST OF THE US-270 JCT IN WATONGA AND EXTEND EAST 4.5 MILES.
SH-3: BEGIN 5.0 MILES EAST OF THE US-270 JCT IN WATONGA AND EXTEND EAST.41 MILES TO THE KINGFISHER C/L.	FFY 2022 WIDEN & RESURFACE \$ 6,761,000
FFY 2018 UTILITIES \$ 7,006,665	FFY 2018 UTILITIES \$ 245,665
SH-33, RECONSTRUCT PAVEMENT BEG 0.37 M EAST OF SH-47 AND EXT EAST .67 MILE IN THE CITY OF THOMAS (WEST SIDE OF 10TH STREET TO EAST SIDE OF 1ST STREET)	FFY 2023 WIDEN & RESURFACE \$ 7,828,000
FFY 2023 RECONSTRUCT-NO ADDED LANES \$ 5,500,000	FFY 2018 UTILITIES \$ 478,928
FFY 2019 RIGHT OF WAY \$ 272,500	FFY 2019 UTILITIES \$ 8,366,928
SH-54, BEGIN 11.8 MI NORTH OF I-40, EW-92, AND EXT NORTH 4.8 MILES TO SH-33	FFY 2017 WIDEN & RESURFACE \$ 5,341,000
SH-33: OVER EAST & WEST BARNITZ CREEK & O'FLOWS	FFY 2018 BRIDGE & APPROACHES \$ 7,060,650
SH-54: BEGIN 6.8 NORTH OF I-40 AND EXT NORTH 5.0 MI.	FFY 2019 WIDEN & RESURFACE \$ 6,924,980
SH-54, BEGIN 1.8 NORTH OF THE I-40 JCT (NORTH WEATHERFORD CITY LIMITS) AND EXTEND NORTH 5.0 MILES.	FFY 2022 WIDEN, RESURFACE & BRIDGE \$ 7,890,000
AIRPORT ROAD OVER I-40	FFY 2021 BRIDGE & APPROACHES \$ 6,000,000
FFY 2017 RIGHT OF WAY \$ 106,000	FFY 2017 UTILITIES \$ 105,998
I-40 NORTH FRONTAGE ROAD, OVER LITTLE DEEP CREEK	FFY 2019 BRIDGE & APPROACHES \$ 1,240,200
FFY 2017 UTILITIES \$ 25,056	FFY 2017 UTILITIES \$ 1,265,256
SH-58 OVER DEER CREEK	FFY 2017 BRIDGE & APPROACHES \$ 3,900,000
I-40: REHAB CABLE BARRIER FROM MP 66 TO 88 AND OTHER VARIOUS LOCATIONS.	FFY 2024 CABLE BARRIER \$ 3,000,000
I-40 RESURFACE BEGIN AT MP 86.27 TO MP 89.72.	FFY 2023 RESURFACE \$ 7,600,000
I-40: RESURFACE BEGINNING AT MP 95.76 TO MP 102.2	FFY 2024 RESURFACE \$ 9,600,000
I-40: RESURFACE FROM MP 89.72 TO MP 95.76.	FFY 2024 RESURFACE \$ 9,000,000
I-40: MODIFY THE I-40 EAST BOUND ON RAMP TO EXTEND TO THE SOUTH FRONTAGE ROAD. PHASE III WORK WITH 20% WEATHERFORD PARTICIPATION.	FFY 2019 GRADE, DRAIN & SURFACE \$ 1,272,000
I-40B OVER THE WASHITA RIVER	FFY 2021 BRIDGE & APPROACHES \$ 10,263,000
FFY 2017 UTILITIES \$ 102,046	FFY 2017 UTILITIES \$ 10,365,046
I-40: REPLACE BRIDGES ON US-183 OVER I-40	FFY 2024 BRIDGE & APPROACHES \$ 5,500,000
I-40: INTERCHANGE AND INTERSECTION MODIFICATION AT EXIT 65, I-40B WEST JCT IN CLINTON. (PHASE I WORK)	FFY 2024 GRADE, DRAINING, BRIDGE & SURFACE \$ 10,000,000
FFY 2023 RIGHT OF WAY \$ 5,000,000	FFY 2023 UTILITIES \$ 5,000,000
I-40, REHAB EB AND WB BRIDGES OVER NEPTUNE ROAD & RR IN CLINTON	FFY 2022 BRIDGE REHABILITATION \$ 5,574,000
I-40 RESURFACE FROM MP 64.0 TO MP 68.7	FFY 2022 SURFACE \$ 10,700,000
I-40 FRONTAGE ROAD, BRIDGE AND APPROACHES OVER DRY CREEK LOCATED	FFY 2022 BRIDGE & APPROACHES \$ 957,000
FFY 2019 RIGHT OF WAY \$ 27,250	FFY 2019 UTILITIES \$ 1,011,500
I-40: RESURFACE BEGINNING AT MP 59 AND EXTEND EAST TO MP 64.	FFY 2020 RESURFACE \$ 8,175,000
I-40: RESURFACE FROM MP 53 TO MP 59	FFY 2019 RESURFACE \$ 9,864,360
I-40 NORTH FRONTAGE ROAD: BRIDGE AND APPROACHES OVER SAND CREEK	FFY 2018 BRIDGE & APPROACHES \$ 742,630
SH-44, OVER TURKEY CREEK & OVERFLOW	FFY 2020 BRIDGE & APPROACHES \$ 2,035,030
FFY 2017 RIGHT OF WAY \$ 105,825	FFY 2017 UTILITIES \$ 56,600
I-40: RESURFACE FROM MP 45 TO MP 53	FFY 2018 RESURFACE \$ 8,284,000
SH-152: BEGIN 0.15 MILE EAST OF SH-44 AND EXTEND EAST 5.05 MILES.	FFY 2022 WIDEN & RESURFACE \$ 6,731,000
FFY 2017 RIGHT OF WAY \$ 377,000	FFY 2017 UTILITIES \$ 696,642
SH-9, MONEY PLACE HOLDER FOR A PROJECT SHARED BY DIVISION 5 & 7. DIVISION 7 IS TO TAKE THE LEAD UNDER JP 21714(04).	FFY 2019 GRADE, DRAIN & SURFACE \$ 4,770,000
SH-152: OVER EAST ELK CREEK. PROJECT INCLUDES THE SH-44 INTERSECTION.	FFY 2018 BRIDGE & APPROACHES \$ 2,735,680
SH-152 FROM 5.8 MI EAST OF THE BECKHAM C/L EAST 5.0 MI	FFY 2021 WIDEN, RESURFACE & BRIDGE \$ 7,137,000
FFY 2017 RIGHT OF WAY \$ 214,000	FFY 2017 UTILITIES \$ 303,120
SH-152 OVER TRAIL CR	FFY 2017 BRIDGE & APPROACHES \$ 2,145,000
SH-152 FROM 1.8 MI EAST OF THE BECKHAM C.L EAST 4.0 MI	FFY 2019 WIDEN, RESURFACE & BRIDGE \$ 3,347,480
SH-115 OVER 2 UNNAMED CREEKS	FFY 2021 BRIDGE & APPROACHES \$ 1,400,000
FFY 2019 RIGHT OF WAY \$ 163,500	FFY 2019 UTILITIES \$ 54,500
SH-19, BRIDGE AND APPROACHES OVER UNNAMED CREEK	FFY 2018 BRIDGE & APPROACHES \$ 1,171,110
SH-55: BRIDGE AND APPROACHES OVER LITTLE ELK CREEK	FFY 2018 BRIDGE & APPROACHES \$ 2,721,260
SH-19: BRIDGE AND APPROACHES OVER AN UNNAMED CREEK	FFY 2018 BRIDGE & APPROACHES \$ 1,442,000
SH-55 OVER AN UNNAMED CREEK	FFY 2021 BRIDGE & APPROACHES \$ 1,210,000
FFY 2019 RIGHT OF WAY \$ 54,500	FFY 2019 UTILITIES \$ 54,500
SH-115, THREE BRIDGES, TWO OVER TRIB OF SADDLE MTN CRK AND ONE OVER SADDLEMTN CRK	FFY 2020 BRIDGE & APPROACHES \$ 2,834,000
FFY 2018 RIGHT OF WAY \$ 81,751	FFY 2018 UTILITIES \$ 2,997,501