

Notes

Proposed Roadway Section



Divided Highway Typical Roadway Section

Typical includes: Three 12-foot-wide driving lanes in each direction, 10-foot-wide shoulders, and a center median with a concrete barrier wall and lighting.

District 3

ODOT District 3 Engineer: Ron Brown, P.E.

Total Road Miles*: 1,780.31 **Total Interstate Miles*:** 128.03 **Total Bridges**:** 932

Counties:

Cleveland, Coal, Garvin, Hughes, Johnston, Lincoln, **McClain**, Okfuskee, Pontotoc, Pottawatomie, Seminole

*Totals DO NOT include Toll Roads

**Totals DO NOT include County Bridges

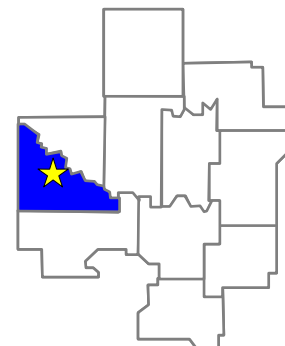

McClain County,
Oklahoma

Important Dates



For more information about this project, contact:
(405) 325-3269 or Engage@odot.ok.gov



PUBLIC OPEN HOUSE

February 5, 2026
I-35 Roadway Improvements Between
Purcell and Goldsby
Job Piece # 36185(04)

Location: Goldsby Community Center
100 E Center Rd. | Goldsby, OK 73093
When: 5:00 pm – 7:00 pm

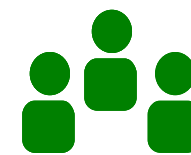

MEETING PURPOSE

To learn about the planned highway work, share your thoughts, and get answers about the I-35 roadway improvements. This will be a come-and-go type meeting with no presentation. Project team members will be on hand to answer questions.



PROJECT DESCRIPTION

The Oklahoma Department of Transportation (ODOT) and the Federal Highway Administration (FHWA) are planning to improve I-35. The project is between Purcell and Goldsby, OK. It starts at Johnson Road and heads north for about 2.3 miles. The intent is to widen I-35 to add a driving lane in both directions. These changes are needed to make the highway safer and help traffic flow more smoothly. Right now, I-35 is unable to handle the high volume of traffic it gets every day, which is expected to increase to 56,800 vehicles per day by 2050.

ODOT proposes the following:

- Adding one driving lane in each direction of I-35
- Widening shoulders to 10 feet
- Constructing a concrete barrier and adding lighting between northbound and southbound traffic
- Improving the northbound on-ramp and southbound off-ramp at Johnson Road
- Replacing or extending drainage structures

I-35 will stay open during construction. Two lanes of traffic will be maintained in both directions, and the Johnson Road and Ladd Road exits will not be closed.

No new right-of-way will be required for this project.

PLEASE PROVIDE YOUR COMMENTS BY
FEBRUARY 19, 2026

Submitted comments are subject to public review.
Personal information will not be shared.



www.odot.org/PublicMeetings

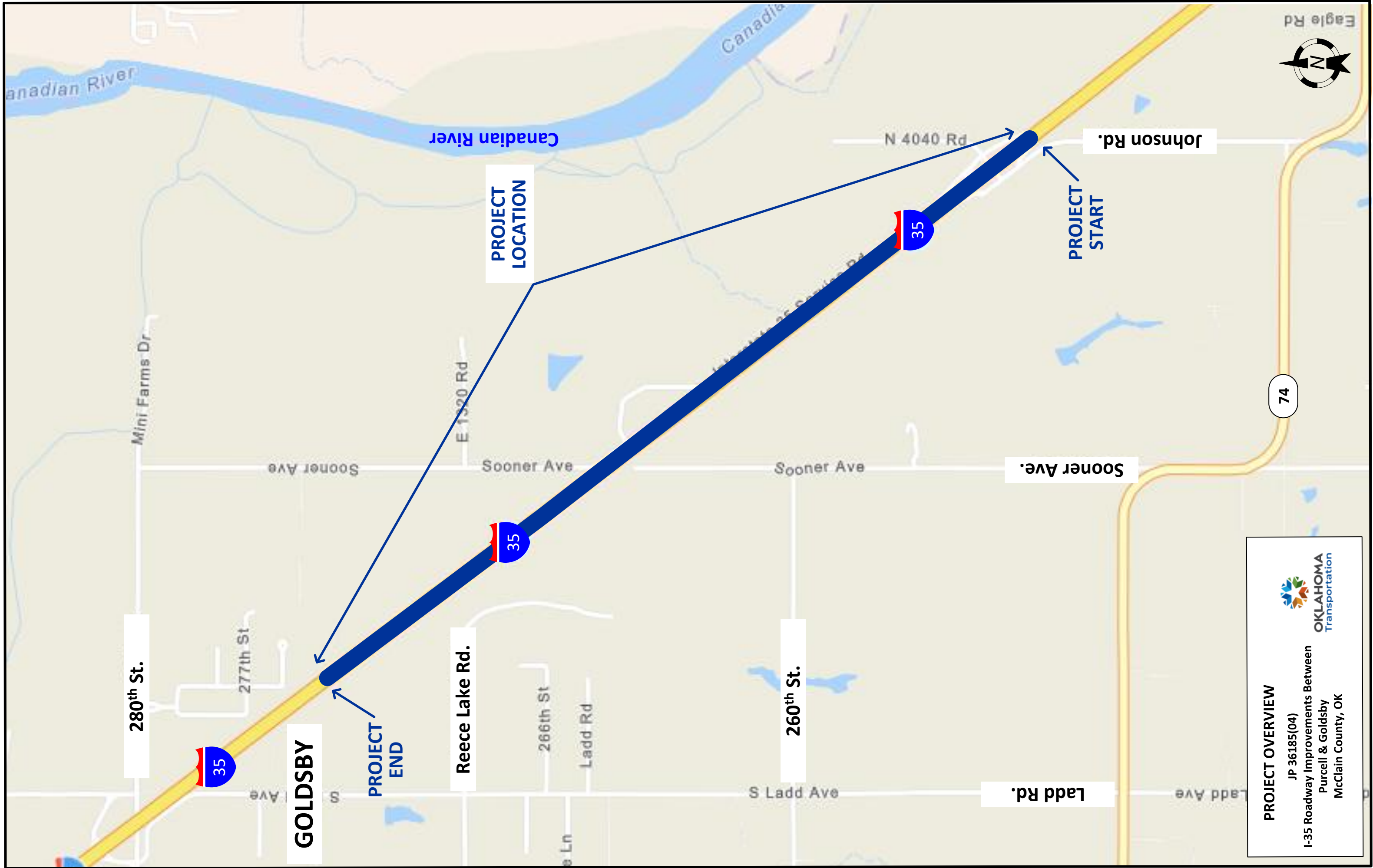

PROJECT OVERVIEW

JP 36185(04)
I-35 Roadway Improvements Between
Purcell & Goldsby
McClain County, OK

 **OKLAHOMA**
Transportation