

Amshore Osage, LLC  
100 Park Avenue, Suite 700  
Oklahoma City, OK 73102

October \_\_, 2016

**VIA HAND DELIVERY**

Osage County Board of Commissioners  
c/o  
Osage County Clerk  
Osage County Courthouse  
600 Grandview Avenue, #304  
Pawhuska, Oklahoma 74056

**NOTICE RELATED TO CONSTRUCTION OF A WIND ENERGY FACILITY**

Pursuant to Section 160.21 of Title 17 of the Oklahoma Statutes ("Section 160.21") and Section 165:35-45-4 of the Oklahoma Administrative Code ("Section 165:35-45-4"), Amshore Osage, LLC ("Company"), hereby submits to the Board of the Osage County Commissioners a copy of the notification (including all exhibits) previously submitted to the Commission concerning the construction of the Amshore Osage Wind Energy Project.

Please do not hesitate to contact us with any questions regarding this notification.

Sincerely yours,

Jeff Neves  
Vice President

cc: Scott Hilton, Osage County Commissioner, District 2 (*via overnight courier – 2850 W. 133<sup>rd</sup> Street North, Skiatook, Oklahoma 74070*)  
Darren McKinney, Kay County Commissioner, District 3 (*via overnight courier – PO Box 543, Fairfax, Oklahoma 74637*)

Exhibit C  
(Proof of Notice)

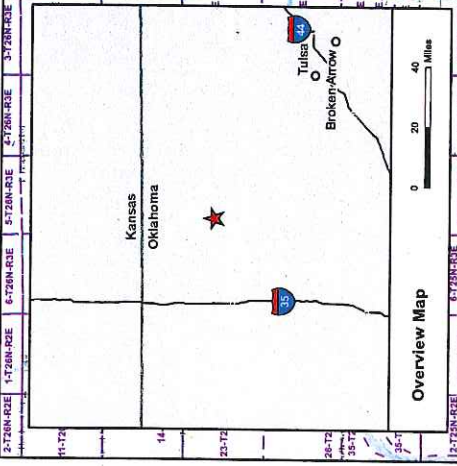
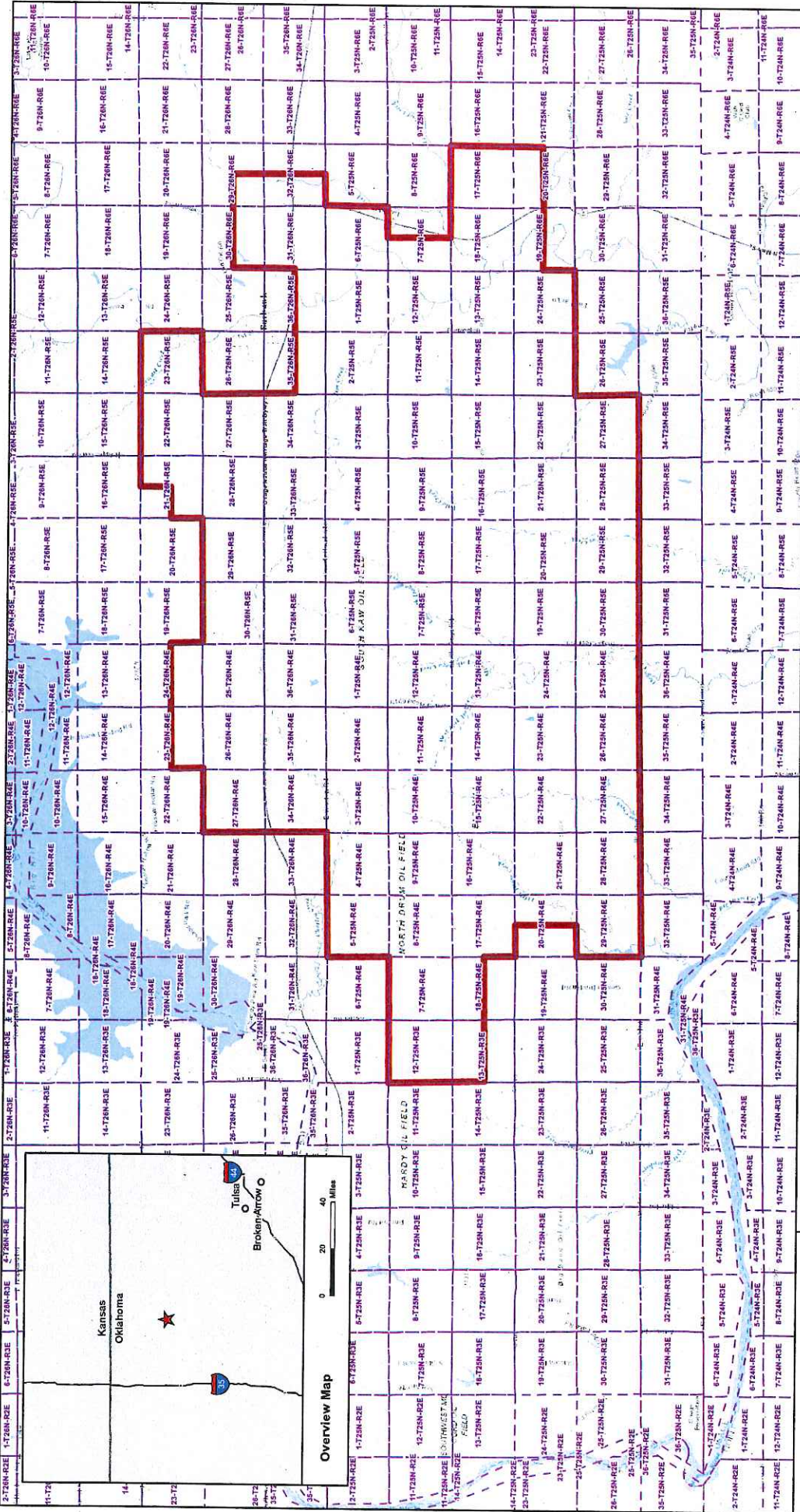

1221 South Maple Expressway, Suite 225  
 Ardmore, Oklahoma 73401-2222  
 www.energyrenewalpartners.com

Project Location: Osage County, Oklahoma

0 1.5 Miles

**Amshore Osage, LLC**  
**Amshore Osage Wind Project**  
 Site Location

**Legend**  
 General Project Area  
 Section Boundary

**EXHIBIT B**

Prepared by: B. Richards      Date: 10/27/2016