

Duke Energy Renewables Wind, LLC
550 S. Caldwell Street, Ste 600/NAS06
Charlotte, NC 28202

RECEIVED
PUBLIC UTILITY
DIVISION

2016 JUL 1 PM 2 17

July 1, 2016

VIA HAND DELIVERY

Oklahoma Corporation Commission
P.O. Box 52000
Oklahoma City, OK 73152-2000

Attn: Fairo Mitchell
Chief of Water and Energy
Public Utility Division

NOTICE RELATED TO CONSTRUCTION OF A WIND ENERGY FACILITY

Pursuant to Section 160.21 of Title 17 of the Oklahoma Statutes ("Section 160.21"), and in advance of certain rules that are to be promulgated by the Oklahoma Corporation Commission ("Commission"), Duke Energy Renewables Wind, LLC ("Company"), hereby notifies the Commission of the construction of the Frontier Windpower III Project, (the "Project") located in Kay County, Oklahoma.

The Project has been under active development for several years. The most recent FAA form 7460-1 filing was made on June 3, 2016. A summary of the June 3, 2016 FAA form 7460-1 filings for each wind turbine tower location within the Project boundary is attached as Exhibit A. Exhibit B to this letter presents a diagram indicating the Project boundary. As of the date of this notice, and based on the best publicly available data, Company attests, that the Project design is in full compliance with the setbacks set forth in Section 160.20 of Title 17 of the Oklahoma Statutes.

In accordance with the notification requirements of Section 160.21, this notice will also be subsequently provided to the Board of the Kay County Commissioners. Evidence of that forthcoming notice is provided as Exhibit C. Since no Project facilities are located within an incorporated area of a municipality, no additional notice is required under Section 160.21.

Future correspondence regarding this matter should be directed to the following Company representative:

Graham Furlong
Duke Energy
550 S. Caldwell Street, Suite 600/NAS06
Charlotte, NC 28202

July __, 2016
Page 2

704-382-1911 Telephone
980-373-8645 Fax

Sincerely yours,

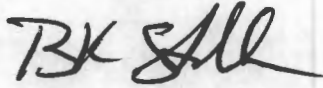

Brian K. Stallman
Vice President

cc: Brandy Wreath, Director, Public Utility Division (*with all exhibits, via overnight courier*
– *Jim Thorpe Building, 2101 N. Lincoln, Oklahoma City, OK 73105*)
Natasha Scott, Deputy General Counsel for Public Utilities, General Counsel's Office
(*with all exhibits, via overnight courier – Jim Thorpe Building, 2101 N. Lincoln,*
Oklahoma City, OK 73105)

Exhibit A

(Summary of FAA Filings)

Below is a table containing filing numbers, structure name and height, location and elevation for each of the Project's turbines which were included with the notices of permanent construction filed with the FAA. As was previously mentioned, the Project will be located in Kay County, Oklahoma and will not be located within the city limits of any municipality. Each turbine will have white paint and synchronized red lights as determined by the FAA lighting plan.

ASN	Structure Name	Latitude (NAD83)	Longitude (NAD83)	Elevation (ft)	Structure Height (ft)	Date Accepted (FAA)
2016-WTW-6026-OE	Frontier III-1	36° 48' 52.641" N	97° 6' 59.363" W	1075	492	6/3/2016
2016-WTW-6027-OE	Frontier III-2	36° 48' 58.343" N	97° 6' 40.480" W	1061	492	6/3/2016
2016-WTW-6028-OE	Frontier III-3	36° 49' 14.531" N	97° 5' 43.743" W	1051	492	6/3/2016
2016-WTW-6029-OE	Frontier III-4	36° 49' 16.179" N	97° 5' 27.699" W	1065	492	6/3/2016
2016-WTW-6030-OE	Frontier III-5	36° 49' 2.604" N	97° 4' 57.249" W	1044	492	6/3/2016
2016-WTW-6031-OE	Frontier III-6	36° 49' 7.610" N	97° 4' 42.578" W	1065	492	6/3/2016
2016-WTW-6032-OE	Frontier III-7	36° 49' 46.483" N	97° 5' 30.688" W	1066	492	6/3/2016
2016-WTW-6033-OE	Frontier III-8	36° 49' 48.130" N	97° 5' 14.642" W	1061	492	6/3/2016
2016-WTW-6034-OE	Frontier III-9	36° 49' 50.706" N	97° 4' 41.885" W	1064	492	6/3/2016
2016-WTW-6035-OE	Frontier III-10	36° 49' 50.805" N	97° 4' 25.723" W	1083	492	6/3/2016
2016-WTW-6036-OE	Frontier III-11	36° 49' 52.593" N	97° 3' 39.464" W	1092	492	6/3/2016
2016-WTW-6037-OE	Frontier III-12	36° 50' 2.840" N	97° 3' 25.079" W	1111	492	6/3/2016
2016-WTW-6038-OE	Frontier III-13	36° 50' 5.060" N	97° 3' 9.159" W	1112	492	6/3/2016
2016-WTW-6039-OE	Frontier III-14	36° 50' 52.757" N	97° 3' 21.999" W	1114	492	6/3/2016
2016-WTW-6040-OE	Frontier III-15	36° 50' 55.631" N	97° 3' 7.026" W	1125	492	6/3/2016
2016-WTW-6041-OE	Frontier III-16	36° 50' 56.803" N	97° 2' 39.505" W	1152	492	6/3/2016
2016-WTW-6042-OE	Frontier III-17	36° 50' 57.092" N	97° 2' 21.211" W	1147	492	6/3/2016
2016-WTW-6043-OE	Frontier III-18	36° 51' 1.343" N	97° 2' 6.797" W	1143	492	6/3/2016
2016-WTW-6044-OE	Frontier III-19	36° 51' 8.059" N	97° 0' 30.795" W	1118	492	6/3/2016
2016-WTW-6045-OE	Frontier III-20	36° 51' 8.090" N	97° 0' 13.834" W	1130	492	6/3/2016
2016-WTW-6046-OE	Frontier III-21	36° 51' 4.691" N	96° 59' 57.410" W	1089	492	6/3/2016
2016-WTW-6047-OE	Frontier III-22	36° 50' 13.544" N	97° 2' 17.703" W	1134	492	6/3/2016
2016-WTW-6048-OE	Frontier III-23	36° 50' 32.368" N	97° 1' 34.596" W	1149	492	6/3/2016
2016-WTW-6049-OE	Frontier III-24	36° 50' 32.834" N	97° 1' 15.816" W	1141	492	6/3/2016
2016-WTW-6050-OE	Frontier III-25	36° 50' 38.691" N	97° 1' 1.871" W	1153	492	6/3/2016
2016-WTW-6051-OE	Frontier III-26	36° 50' 39.175" N	97° 0' 41.408" W	1170	492	6/3/2016
2016-WTW-6052-OE	Frontier III-27	36° 50' 38.580" N	97° 0' 25.470" W	1141	492	6/3/2016
2016-WTW-6053-OE	Frontier III-28	36° 49' 44.497" N	97° 2' 1.105" W	1140	492	6/3/2016

2016-WTW-6054-OE	Frontier III-29	36° 49' 45.083" N	97° 1' 44.550" W	1147	492	6/3/2016
2016-WTW-6055-OE	Frontier III-30	36° 49' 46.728" N	97° 1' 29.339" W	1143	492	6/3/2016
2016-WTW-6056-OE	Frontier III-31	36° 49' 50.625" N	97° 1' 14.804" W	1161	492	6/3/2016
2016-WTW-6057-OE	Frontier III-32	36° 49' 51.271" N	97° 0' 57.452" W	1160	492	6/3/2016
2016-WTW-6058-OE	Frontier III-33	36° 49' 51.218" N	97° 0' 40.916" W	1174	492	6/3/2016
2016-WTW-6059-OE	Frontier III-34	36° 49' 50.370" N	97° 0' 24.569" W	1185	492	6/3/2016
2016-WTW-6060-OE	Frontier III-35	36° 49' 42.583" N	96° 59' 51.969" W	1198	492	6/3/2016
2016-WTW-6061-OE	Frontier III-36	36° 49' 43.170" N	96° 59' 34.625" W	1170	492	6/3/2016
2016-WTW-6062-OE	Frontier III-37	36° 49' 43.083" N	96° 59' 19.275" W	1194	492	6/3/2016
2016-WTW-6063-OE	Frontier III-38	36° 49' 44.687" N	96° 59' 1.830" W	1160	492	6/3/2016
2016-WTW-6064-OE	Frontier III-39	36° 49' 49.876" N	96° 58' 29.424" W	1163	492	6/3/2016
2016-WTW-6065-OE	Frontier III-40	36° 49' 50.605" N	96° 58' 13.290" W	1192	492	6/3/2016
2016-WTW-6066-OE	Frontier III-41	36° 49' 52.361" N	96° 57' 57.292" W	1217	492	6/3/2016
2016-WTW-6067-OE	Frontier III-42	36° 50' 1.035" N	96° 57' 44.229" W	1234	492	6/3/2016
2016-WTW-6068-OE	Frontier III-43	36° 49' 10.651" N	97° 1' 12.404" W	1139	492	6/3/2016
2016-WTW-6069-OE	Frontier III-44	36° 49' 10.863" N	97° 0' 56.689" W	1152	492	6/3/2016
2016-WTW-6070-OE	Frontier III-45	36° 49' 11.577" N	97° 0' 38.553" W	1159	492	6/3/2016
2016-WTW-6071-OE	Frontier III-46	36° 49' 10.908" N	97° 0' 11.335" W	1173	492	6/3/2016
2016-WTW-6072-OE	Frontier III-47	36° 49' 13.299" N	96° 59' 55.442" W	1190	492	6/3/2016
2016-WTW-6073-OE	Frontier III-48	36° 48' 56.611" N	96° 59' 25.356" W	1192	492	6/3/2016
2016-WTW-6074-OE	Frontier III-49	36° 48' 56.701" N	96° 59' 8.818" W	1157	492	6/3/2016
2016-WTW-6075-OE	Frontier III-50	36° 48' 59.086" N	96° 58' 52.541" W	1154	492	6/3/2016
2016-WTW-6076-OE	Frontier III-51	36° 49' 1.105" N	96° 58' 30.899" W	1163	492	6/3/2016
2016-WTW-6077-OE	Frontier III-52	36° 49' 7.664" N	96° 58' 15.590" W	1191	492	6/3/2016
2016-WTW-6078-OE	Frontier III-53	36° 49' 22.341" N	96° 58' 3.683" W	1212	492	6/3/2016
2016-WTW-6079-OE	Frontier III-54	36° 49' 24.346" N	96° 57' 48.145" W	1212	492	6/3/2016
2016-WTW-6080-OE	Frontier III-55	36° 48' 4.575" N	97° 0' 58.275" W	1134	492	6/3/2016
2016-WTW-6081-OE	Frontier III-56	36° 48' 6.282" N	97° 0' 40.247" W	1151	492	6/3/2016
2016-WTW-6082-OE	Frontier III-57	36° 48' 17.452" N	97° 0' 22.469" W	1170	492	6/3/2016
2016-WTW-6083-OE	Frontier III-58	36° 48' 18.961" N	97° 0' 7.243" W	1181	492	6/3/2016
2016-WTW-6084-OE	Frontier III-59	36° 48' 6.882" N	96° 59' 36.673" W	1199	492	6/3/2016
2016-WTW-6085-OE	Frontier III-60	36° 48' 6.834" N	96° 59' 21.350" W	1188	492	6/3/2016
2016-WTW-6086-OE	Frontier III-61	36° 48' 18.443" N	96° 59' 4.234" W	1164	492	6/3/2016
2016-WTW-6087-OE	Frontier III-62	36° 48' 23.355" N	96° 58' 48.429" W	1135	492	6/3/2016
2016-WTW-6088-OE	Frontier III-63	36° 48' 20.518" N	96° 58' 26.521" W	1134	492	6/3/2016
2016-WTW-6089-OE	Frontier III-64	36° 47' 31.092" N	97° 0' 41.657" W	1131	492	6/3/2016
2016-WTW-6090-OE	Frontier III-65	36° 47' 32.592" N	97° 0' 24.806" W	1150	492	6/3/2016
2016-WTW-6091-OE	Frontier III-66	36° 47' 30.362" N	97° 0' 8.291" W	1162	492	6/3/2016
2016-WTW-6092-OE	Frontier III-67	36° 47' 32.756" N	96° 59' 52.615" W	1169	492	6/3/2016

2016-WTW-6093-OE	Frontier III-68	36° 47' 33.484" N	96° 59' 34.455" W	1187	492	6/3/2016
2016-WTW-6094-OE	Frontier III-69	36° 47' 33.552" N	96° 59' 19.104" W	1201	492	6/3/2016
2016-WTW-6095-OE	Frontier III-70	36° 46' 21.658" N	97° 0' 26.049" W	1134	492	6/3/2016
2016-WTW-6096-OE	Frontier III-71	36° 46' 22.947" N	97° 0' 10.394" W	1150	492	6/3/2016
2016-WTW-6097-OE	Frontier III-72	36° 46' 41.962" N	96° 59' 53.178" W	1166	492	6/3/2016
2016-WTW-6098-OE	Frontier III-73	36° 46' 43.744" N	96° 59' 37.602" W	1173	492	6/3/2016
2016-WTW-6099-OE	Frontier III-74	36° 46' 42.361" N	96° 59' 21.971" W	1167	492	6/3/2016
2016-WTW-6100-OE	Frontier III-75	36° 46' 39.620" N	96° 59' 6.191" W	1180	492	6/3/2016

Exhibit B
(Project Diagram)

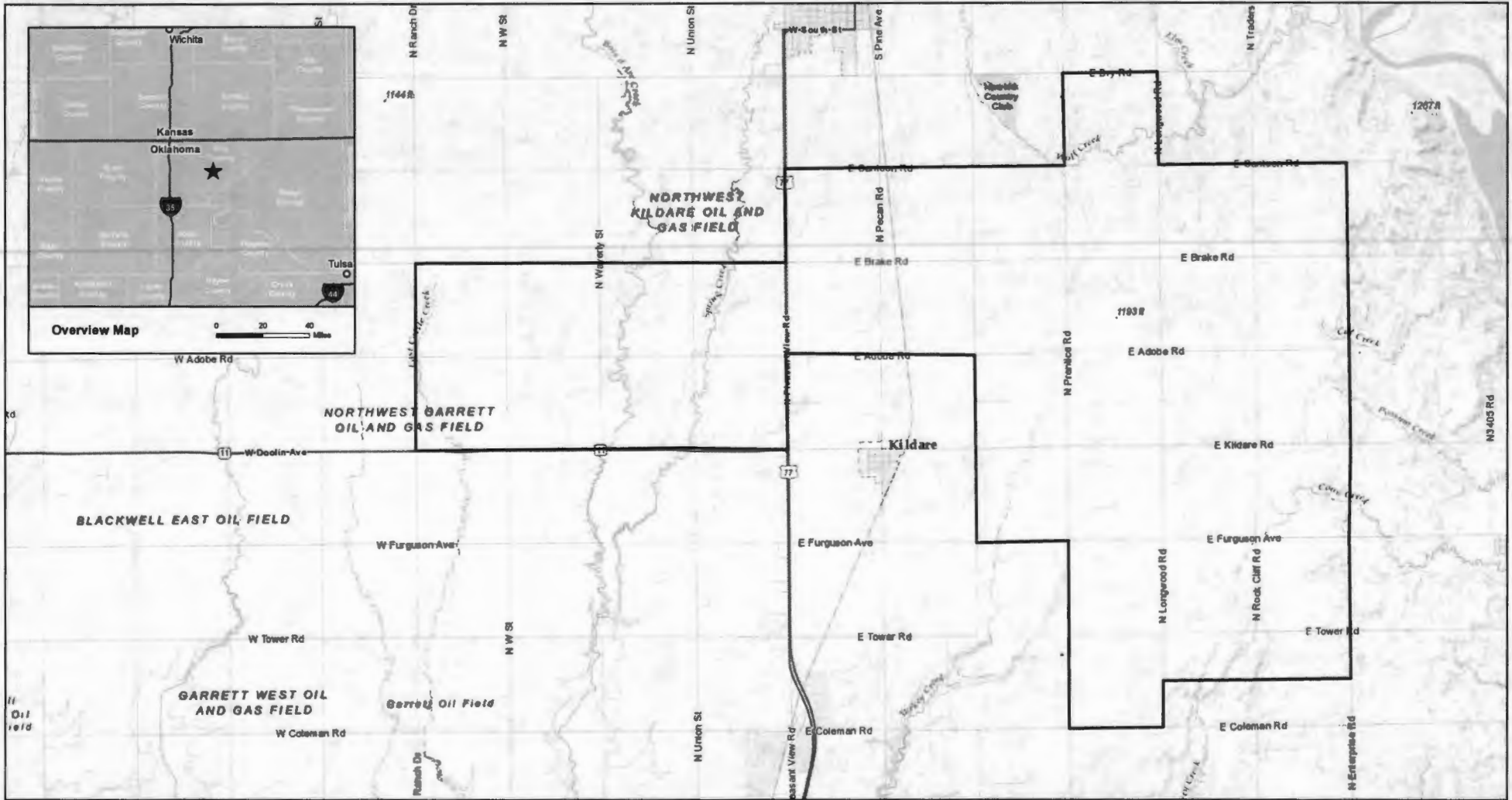

101 W. Worthington Ave., Suite 120
 Charlotte, North Carolina 28203
 980-949-8523
 www.energyrenewalpartners.com



Legend
 □ General Project Area

Duke Energy Renewables
Frontier III Windpower Project
 Site Location

Project Location: Key County, Oklahoma

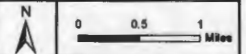

EXHIBIT B

Prepared by: B. Richards Date: 6/15/2016