

RECEIVED
PUBLIC UTILITY
DIVISION

2015 DEC 7 PM 3 18

Frontier Windpower II, LLC
c/o Duke Energy Renewables Wind, LLC
550 S. Caldwell Street, Ste 600/NAS06
Charlotte, NC 28202

December 7, 2015

VIA HAND DELIVERY

Oklahoma Corporation Commission
P.O. Box 52000
Oklahoma City, OK 73152-2000

Attn: Fairo Mitchell
Chief of Water and Energy
Public Utility Division

NOTICE RELATED TO CONSTRUCTION OF A WIND ENERGY FACILITY

Pursuant to Section 160.21 of Title 17 of the Oklahoma Statutes ("Section 160.21"), and in advance of certain rules that are to be promulgated by the Oklahoma Corporation Commission ("Commission"), Frontier Windpower II, LLC ("Company"), hereby notifies the Commission of the construction of the Frontier Windpower II Project, (the "Project") located in Kay County, Oklahoma.

The Project has been under active development for several years. The most recent FAA form 7460-1 filing was made on December 7, 2015. A summary of the December 7, 2015 FAA form 7460-1 filings for each wind turbine tower location within the Project boundary is attached as Exhibit A. Exhibit B to this letter presents a diagram indicating the Project boundary. As of the date of this notice, and based on the best publicly available data, Company attests, that the Project design is in full compliance with the setbacks set forth in Section 160.20 of Title 17 of the Oklahoma Statutes.

In accordance with the notification requirements of Section 160.21, this notice will also be subsequently provided to the Board of the Kay County Commissioners. Evidence of that forthcoming notice is provided as Exhibit C. Since no Project facilities are located within an incorporated area of a municipality, no additional notice is required under Section 160.21.

Future correspondence regarding this matter should be directed to the following Company representative:

Graham Furlong
Duke Energy
550 S. Caldwell Street, Suite 600/NAS06
Charlotte, NC 28202

704-382-1911 Telephone
980-373-8645 Fax

Sincerely yours,



Brian K. Stallman
Vice President

cc: Brandy Wreath, Director, Public Utility Division (*with all exhibits, via overnight courier*
– *Jim Thorpe Building, 2101 N. Lincoln, Oklahoma City, OK 73105*)

Natasha Scott, Deputy General Counsel for Public Utilities, General Counsel's Office
(*with all exhibits, via overnight courier* – *Jim Thorpe Building, 2101 N. Lincoln,*
Oklahoma City, OK 73105)

Exhibit A

(Summary of FAA Filings)

Below is a table containing filing numbers, structure name and height, location and elevation for each of the Project's turbines which were included with the notices of permanent construction filed with the FAA. As was previously mentioned, the Project will be located in Kay County, Oklahoma and will not be located within the city limits of any municipality. Each turbine will have white paint and synchronized white lights.

ASN	Structure Name	NAD83 Latitude	NAD83 Longitude	Elevation (ft)	Structure Height (ft)	Date Accepted (FAA)
2015-WTW-11883-OE	Frontier II-14	36° 48' 20.646" N	97° 10' 8.491" W	1027	492	12/7/2015
2015-WTW-11884-OE	Frontier II-15	36° 48' 21.321" N	97° 9' 52.771" W	1043	492	12/7/2015
2015-WTW-11885-OE	Frontier II-16	36° 48' 21.169" N	97° 9' 36.937" W	1064	492	12/7/2015
2015-WTW-11886-OE	Frontier II-17	36° 48' 22.972" N	97° 9' 16.834" W	1079	492	12/7/2015
2015-WTW-11887-OE	Frontier II-22	36° 48' 29.264" N	97° 7' 38.223" W	1068	492	12/7/2015
2015-WTW-11888-OE	Frontier II-23	36° 48' 33.674" N	97° 7' 24.328" W	1074	492	12/7/2015
2015-WTW-11889-OE	Frontier II-50	36° 48' 0.056" N	97° 7' 39.128" W	1059	492	12/7/2015
2015-WTW-11890-OE	Frontier II-51	36° 48' 2.533" N	97° 7' 24.089" W	1072	492	12/7/2015

Exhibit B
(Project Diagram)

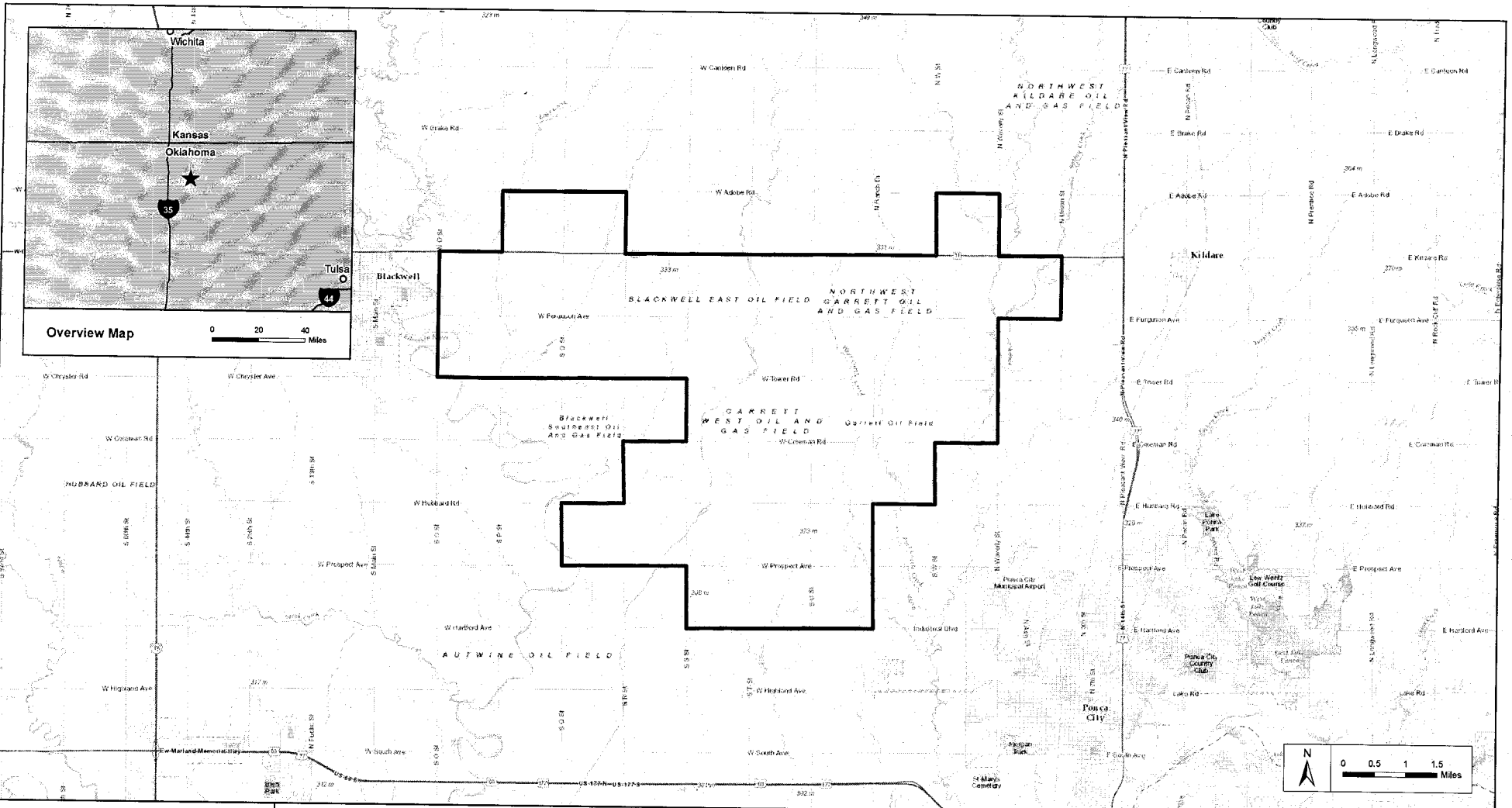

305 Camp Craft Road, Suite 575
 West Lake Hills, Texas 78746
 512-222-1125
 www.energyrenewalpartners.com



Legend
 General Project Area

Duke Energy Renewables Frontier II Windpower Project

Site Location

EXHIBIT
B