



News from the **Oklahoma Corporation Commission**

Matt Skinner, Public Information

Phone: (405) 521-4180

m.skinner@occemail.com

May 8, 2018

Media Advisory

Directive issued for further disposal well volume reductions in Covington/Douglas area

Because of recent earthquake activity in the Covington/Douglas area of Garfield County, the Oklahoma Corporation Commission's Oil and Gas Conservation Division (OGCD) has issued a directive for further reductions in oil and gas wastewater disposal well volumes.

Under the directive, all average daily volumes of Arbuckle disposal wells within 10 miles of the earthquake activity will be reduced another 20 percent.

Further, operators of those wells which have reduced their depth to avoid injecting too close to the basement rock will be required to verify the well's bottom hole plug integrity.

The directive applies to 23 active disposal wells. The total daily average reduction is 11,226 barrels a day. This is in addition to past directives that reduced volumes.

Researchers are in broad agreement that disposal into the Arbuckle formation in Oklahoma poses the largest potential risk for induced seismicity.

- OCC -

All OCC advisories and releases are available at
www.occeweb.com

Editors, Producers: A map showing the wells covered by the directive is attached, as is the most recent earthquake count.

Covington North & South

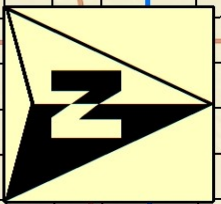

Date: 4/20/2018

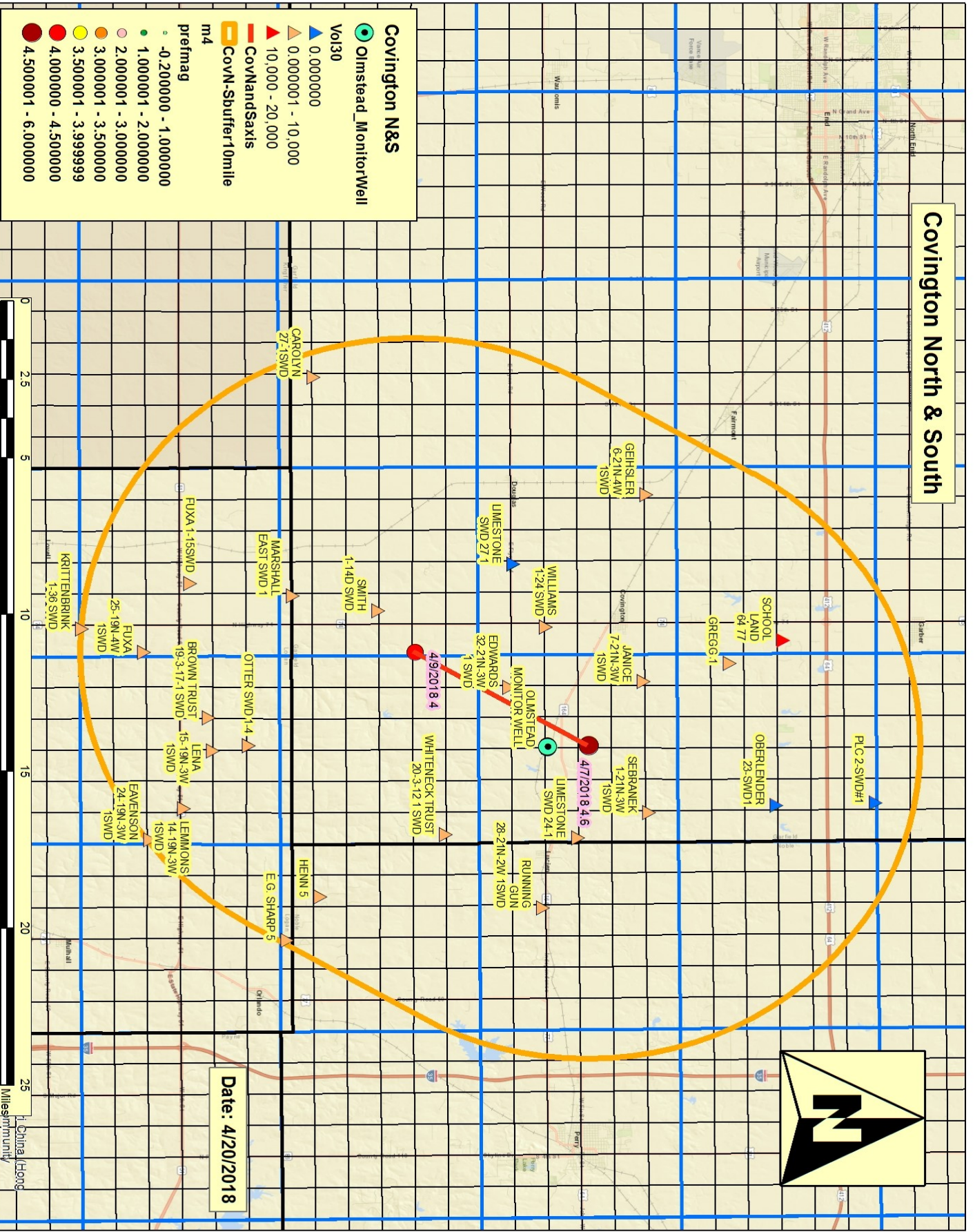

Earthquake Count 2.7+ OGS Catalog 2015 - 2018

Statewide EQ/day
Year to Year
a.o. May 8, 2018

2015: 5.41
2016: 3.62
2017: 1.68
2018: 1.20

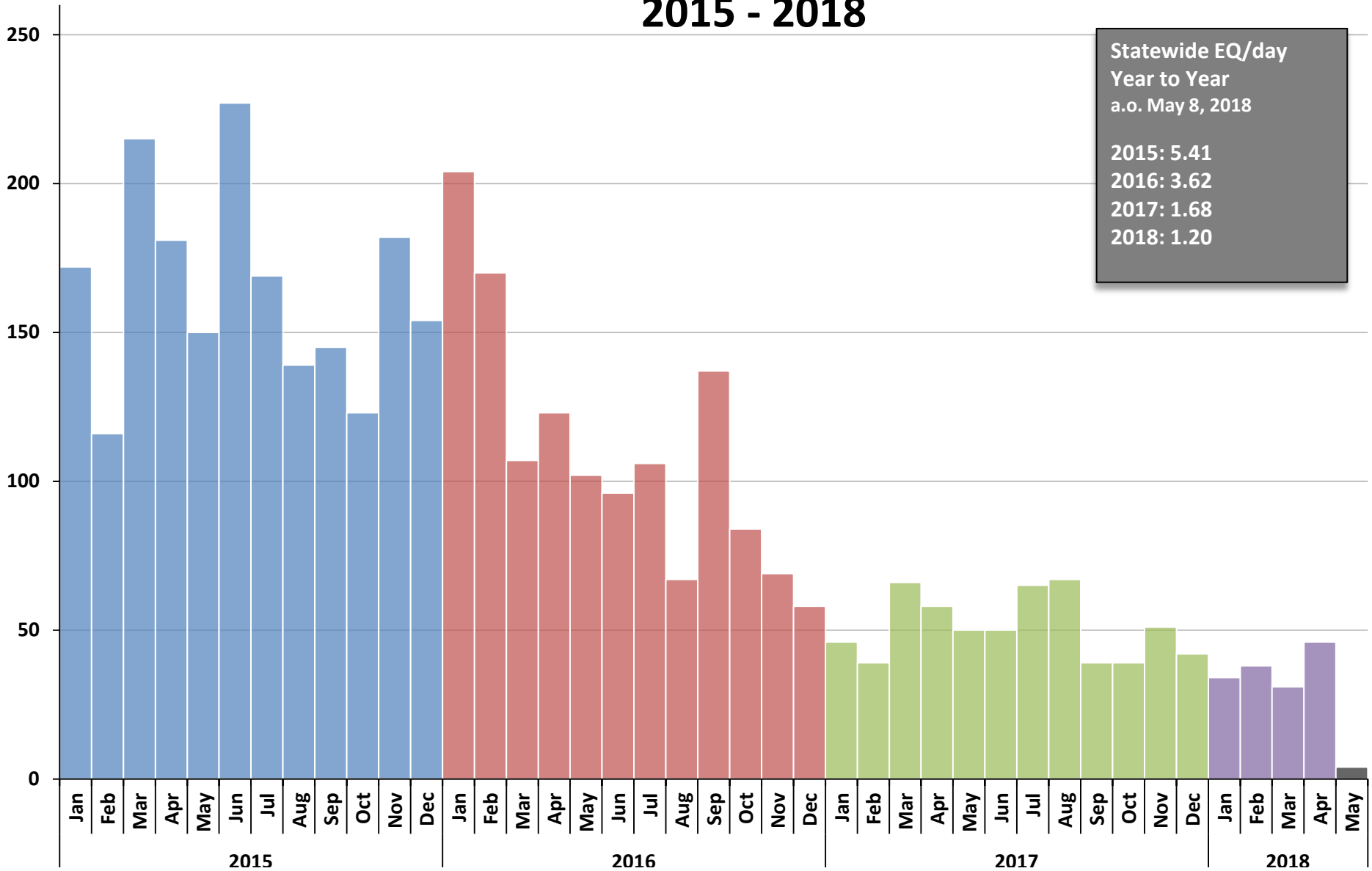

Earthquake Count 2.7+ OGS Catalog 2015 - 2018

Statewide EQ/day
Year to Year
a.o. May 8, 2018

2015: 5.41
2016: 3.62
2017: 1.68
2018: 1.20

