

COPY

State of Oklahoma
Department of Mines
2915 N. Classen Blvd., Ste. 213
Oklahoma City, OK 73106

PERMIT RENEWAL APPLICATION FORM

OAC 460:10-19-5 RECEIVED

DEC 26 2024

DEPT. OF MINES

Date 10/23/24

Current Permit Number LE1774-A Mine Name or Number _____

K. ROSS TRUCKING INC 918 425 5558 Keithross@tulsahughes.net
Name of Company, Corporation, Partnership, Individual Telephone Number Email Address

5802 N. YALE AVE
Street, R.F.D., Box No.

TULSA
City

OK
State

74117
Zip Code

Section 4 Township 20 N Range 13 E County TULSA

Section _____ Township _____ Range _____ County _____

Renewal Term Requested: Life of mine Original Permit Term: 01/01/2000 to 12/31/24

Permitted Acreage approved: 16.0 Bonded Acreage approved: 16.6

Is a permitted acreage increase needed: ☒ NO ☐ YES

Permit acreage increases must be applied for as a new permit application in accordance with OAC 460:10-19-5. (b), (2), (B)

I, (Company Official) Angela Ross Certify that the (Company, Corporation, Individual(s) K. ROSS TRUCKING INC has the right and power by Legal Estate owned to mine the land for which this renewal application is made. We hereby certify that all details contained in this Permit Renewal Request are true and correct to the best of my knowledge. We fully understand that any willful misrepresentation of facts will be cause for permit revocation.

Signature of Company Official Angela Ross Position Sec.

Subscribed and sworn to before me this 10/24/24 day of _____

My Commission expires 10/06/25 Notary Public Katrina Faith Marr

Complete applications for renewal must be submitted prior to the expiration of the permit.
Copies of all Issued Permits or Licenses from other agencies must be attached to this request.

OCT 28 2024

DEPT. OF MINES

RECEIVED

DEC 26 2024

DEPT. OF MINES

State of Oklahoma
Department of Mines
2915 N. Classen Blvd., Ste. 213
Oklahoma City, OK 73106

COMPLIANCE AND RELATED INFORMATION

Section 2

ODM Permit Number

(Office Use Only)

Date 12-26-24

K. ROSS TRUCKING INC 918 425 5558
Name of Company, Corporation, Partnership, Individual Telephone Number

5802 N. YALE AVE TULSA OK 74117
Mailing Address City State Zip Code

NOTE: Answer all questions on this form. (If no answer, write "none"). Properly identify and secure any attached exhibits, if used. Please refer to the specific item number of this form.

Identification of Interests - In compliance with Section 460:10-11-5 of the Rules and Regulations for Non-Coal Surface Mining and Reclamation, the APPLICANT is required to furnish the following:

460:10-11-5(b)

1. Applicant is (check one box below):

Sole Proprietorship ☐ LLC ☐ Corporation ☒ Partnership ☐ Other _____

2a. Please Provide the names of every officer, partner, director, or other person performing similar to director of the applicant.

Keith Ross 5802 N. YALE TULSA OK 74117 Pres
Name Address City State Zip Position

Keith Ross III 6344 N. St Louis TULSA OK 74126 V. Pres
Name Address City State Zip Position

Jeanette Kirk 5802 N YALE TULSA OK 74117 Sec./Treasur
Name Address City State Zip Position

Angela Ross 2201 E. 56th St N TULSA OK 74130 Assistant Sec.
Name Address City State Zip Position

Name Address City State Zip Position

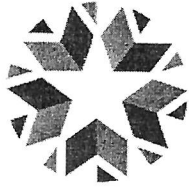

OKLAHOMA

Tax Commission



K. ROSS TRUCKING CO.
5802 N YALE AVE
TULSA OK 74117-2406

Date Issued: August 22, 2023

Letter ID: L0095353792

Taxpayer ID: **-***5905

TRO

Licenses/Permits at this Location

SALES TAX PERMIT

County TULSA COUNTY

Holders of an Oklahoma Sales Tax Permit will find notice of penalties for violation of the Oklahoma Sales Tax code at tax.ok.gov

If the sales tax permit at this location becomes invalid then all associated permits will become invalid. If the business changes location or ownership or is discontinued for any reason, this permit must be returned to the Oklahoma Tax Commission for cancellation WITH AN EXPLANATION ON THE REVERSE SIDE.

Sales Account ID

STS-10052367-05

Site Permit Number

136265728

Business Location	Industry Code	City Code	Site Effective	Expires
K-ROSS TRUCKING 5802 N YALE AVE TULSA OK 74117-2406	44419 444190	7288	July 16, 1990	August 20, 2026

PLEASE POST IN CONSPICUOUS PLACE

Mark Wood, Chairman
Shelly Paulk, Vice-Chairman
Charles Prater, Secretary Member

Non-Transferable

RECEIVED

OCT 28 2024

DEPT. OF MINES

RECEIVED

NOV 18 1907

DEPT. OF MINE

RECEIVED

CBOA- 1683

DEC 26 2024

TULSA COUNTY BOARD OF ADJUSTMENT

201 West 5th Street, Suite 600 • Tulsa, Oklahoma 74103 • (918)584-7526 • FAX (918)583-1024

DEPT. OF MINES

DATE FILED 9/15/99 PUBLIC HEARING DATE 10/19/99 REC'D BY JC

PRESENT ZONING AG S/T/R 403 CZM 22 ATLAS 0 PD 15

Is tract within a city's fenceline? Yes No Referral? Yes No City Tulsa

GENERAL LOCATION: N & W of NW 1/4 E. 56th St. No. & N. YALE

PRESENT USE: Vacant USE UNIT 24

RECORD OWNER: KEITH ROSS

Does record owner consent to the filing of this application? Yes No

If Applicant is other than owner, indicate interest:

Variance - Sections:

Special Exception-Section: 310 Table 1 Appeal from Administrative Official

List the variances or special exceptions or appeals below. A site plan is required. You may attach any photographs or other factual information that will help the Board determine the merits of your application.

Requests a special exception to allow mining/dirt and mineral processing and removal (Gravel, in an AG zoned district (top soil removal)

Legal Description of all property under application (must be a complete lot of record):

NE SW NE, S 1/2 SW NE, NW SE, NE SW SE, E 1/2 SE of Section 4,

TOWNSHIP 20 NORTH, RANGE 13 EAST, TULSA COUNTY, OK

I CERTIFY THAT THE SUBMITTED INFORMATION IS TRUE AND CORRECT.

Name: [Print] KEITH ROSS Telephone: (918) 425-5558

Address: 2201 E. 56th N City/State TULSA, OK Zip 74130

Signature: Keith Ross Date: 09/14/99

APPLICANT - DO NOT WRITE BELOW THIS LINE

FEES:

APPLICATION FEE: \$ 125.00

NEWSPAPER PUBLICATION: \$ 70.00

300-FEET PROP. OWNERS REPORT (Tulsa County) \$ 25.00

Estimated names: base fee \$25 + Additional Names \$

Sub-total: \$ 95.00

Applicant providing mailing list Receipt Number: 990042 TOTAL FEES: \$ 220.00

PREVIOUS CASE NUMBERS (Specify E or V): Subject Tract:

Surrounding Area:

CBOA Action: Cont. to Nov 16. App. W/Cont. DATE / VOTE: 3-0-0. 10.19.99

PLAT NAME & NUMBER OR WAIVER: 4-0-0. 11.16.99

PLATTING REQUIREMENTS

For any land which has been granted a special exception by the Board of Adjustment for a use within Use Units 2, 4, 5, 8, or 20, no building permit or zoning clearance permit may be issued until that portion of the tract on which the permit is sought has been included within a subdivision plat or replat, as the case may be, submitted to and approved by the Planning Commission, and filed of record in the office of the County Clerk where the property is situated. Provided that the Planning Commission, pursuant to their exclusive jurisdiction over subdivision plats, may waive the platting requirement upon a determination that the above stated purposes have been achieved by previous platting or could not be achieved by a plat or replat."

I do hereby certify that I have read and understand the above mentioned requirements and that I will plat, replat or have the platting requirements waived for the subject property being identified in case number _____.

Applicant's Signature

Date

AUTHORIZATION FOR INCOG TO OBTAIN NAMES/ADDRESSES OF PROPERTY OWNERS WITHIN 300 FEET

I authorize the INCOG Staff to obtain property owner's names and addresses as required for application number CPDA-1683. I understand that INCOG Staff will utilize ownership information from the Tulsa County Assessor's computer records, which may not incorporate recent ownership changes. INCOG is not responsible for the accuracy, completeness and/or currency of the ownership information obtained. I also understand that the applicant is responsible for providing INCOG with any and all updates or corrections necessary to have this ownership list comply with legal notice requirements at least 25 days prior to the public hearing date of this application.

X Keith Davis
Signature

9-15-99
Date

INCOG
Names Obtained By

FILE COPY

Case No. 1682 (continued)

Board Action:

On **MOTION** of **ALBERTY**, the Board voted 3-0-0 (Alberty, Dillard, Walker "aye"; no "nays", no "abstentions"; Looney, Tyndall, "absent") to **APPROVE** a **Special Exception** to permit a home occupation (beauty shop) in an RE District, finding that the Special Exception will be in harmony with the spirit and intent of the Code, and will not be injurious to the neighborhood or otherwise detrimental to the public welfare; **SECTION 410. PRINCIPAL USES PERMITTED IN RESIDENTIAL DISTRICTS** and a **Variance** of the front setback from 35' to 20' to permit an addition, finding that it meets the requirements of Section 1670.3; **SECTION 430. BULK AND AREA REQUIREMENTS IN RESIDENTIAL DISTRICTS**, subject to the conditions of the Home Occupation Guidelines and subject to the front building line aligns with the existing house and does not encroach on what is already there, on the following described property:

Lot 8, Block 2, Hill 'n' Dale Acres, a subdivision in Tulsa County, State of Oklahoma.

Case No. 1683

Action Requested:

Special Exception to allow mining/dirt removal (non-coal) in an AG zoned district. **SECTION 310. PRINCIPAL USES PERMITTED IN THE AGRICULTURE DISTRICT**, located N & W of NW/c E. 56th St. N. & N. Yale.

Comments and Questions:

Mr. Bruce reviewed Staff Comments from the Case Report.

Presentation:

The applicant, **Keith Ross**, was represented by **Gene Heinecke**, 2817 East 34th Street, Tulsa, OK, submitted a site plan (Exhibit H-1). Mr. Ross is applying for a non-coal mining permit from the Oklahoma Department of Mines. The property consists of 160 acres in size. Ms. Heinecke mentioned that 160 acres will be put on the mine application but after review, they will not use all of the 160 acres for mining. The mining will be 2' to 5' deep. Mr. Ross currently operates a mining operation directly to the west of the subject property. That mine is not part of this application.

Comments and Questions:

Mr. Alberty asked the applicant if she is familiar with the Oklahoma Department of Mines requirements, is there any reason why they cannot comply with all of their requirements? Ms. Heinecke replied that they have the permit ready and has spoken with the Bureau of Mines and the various other departments

Case No. 1683 (continued)

involved. They are asking for a wetlands determination, which is one of the requirements.

Mr. Alberty asked the applicant what the future plan for reclamation is? Ms. Heinecke stated that the land is currently agriculture in nature and it will be returned to pastureland. There will also be a small retention pond that will be built to the Department of Mines specifications.

Mr. Alberty inquired as to what kind of traffic will be at this site? Ms. Heinecke responded that she did not know.

Ms. Heinecke stated that there are currently two Williams pipelines that cross the property. One is Ammonia and the other is Petroleum. Williams has already been contacted and they will mark the area.

Interested Parties:

Dwight Smith, 35 East 18th Street, Tulsa, OK 74119, stated that he represents Texhoma Royalty Corporation. Mr. Smith explained that his client owns the property to the northwest of the subject property. Highway 75 runs adjacent to their property and exists 56th Street North and 66th Street North. The Tulsa Speedway is located just off of 66th Street North. The racing facility operates about 30 weekends a year and attracts 6,000 to 7,000 patrons per weekend. The facility itself consists of 30 acres of his client's 100 acres. Mr. Smith informed the Board that his client is opposed to the mining of this property. Mr. Smith feels that granting the application is not in keeping with the spirit and intent of the Code and allowing a 30 acre mining operation will not encourage industrial, commercial or residential growth. They do not feel the application should not cover the entire 160 acres but only the exact area where the mining will take place. It was explained to the Board that East 56th Street North is a narrow two lane street that is not capable of handling the heavy truck traffic. Mr. Smith suggested that nobody knows about detailed plans for the site. Detention, drainage, depth of removal, silt trapping systems, etc. and other such issues have not even been discussed and those are critical issues in mining. Mr. Smith urged the Board to deny the application and urged the applicant to present an environmental impact study.

Comments and Questions:

Mr. Alberty asked Mr. Smith if he heard the applicant's presentation and by her stating that they will restrict the initial phase of mining to the 30 acres and does that change his objection in any way? Mr. Smith stated that his client would be opposed to an unlimited 30 acre application as well. Mr. Smith suggested that if the Board is inclined to look at that option, obviously the remediation condition should be a part of granting the application as should the size restriction.

Case No. 1683 (continued)

Mr. Alberty stated that as far as the traffic is concerned, the mining operation would certainly have a lesser impact on the area than the speedway currently does.

Applicant's Rebuttal:

Ms. Heinecke approached the Board with a site plan of the area showing the proposed location of the mining operation and explained the layout of the property to the Board. Ms. Heinecke explained that the entire 160 acres will not be mined at the same time. Her client will mine one small area, finish the site, then move to another part of the property and begin mining that area.

Mr. Alberty stated that he would like to see more detailed drawings, showing the intent for the entire 160 acres, before the Board takes final action on this application. He would also like for the applicant to meet with Mr. Smith and his clients and work out any potential conflicts. Mr. Alberty feels that he could support the mining operation with the initial 30 acre phase based upon what Ms. Heinecke has proposed.

Board Action:

On **MOTION** of **ALBERTY**, the Board voted 3-0-0 (Alberty, Dillard, Walker "aye"; no "nays", no "abstentions"; Looney, Tyndall, "absent") to **CONTINUE** Case No. 1683 to the meeting of November 16, 1999.

* * * * *

OTHER BUSINESS

Board Action:

On **MOTION** of **DILLARD**, the Board voted 3-0-0 (Alberty, Dillard, Walker "aye"; no "nays", no "abstentions"; Looney, Tyndall, "absent") to **APPROVE** the 2000 County Board of Adjustment Meeting Schedule.

* * * * *

There being no further business, the meeting was adjourned at 2:40 p.m.

Date approved: _____

11/16/99
Robert L. Walker
Chair

Mr. Looney in at 1:40 p.m.

Case No. 1683

Action Requested:

Special Exception to Allow mining/dirt removal (non-coal) in an AG zoned district.
SECTION 310. PRINCIPAL USES PERMITTED IN THE AGRICULTURE DISTRICT, located north and west of the northwest corner of East 56th Street North and North Yale.

Staff Comments:

Mr. Bruce stated that the area under application is 130 acres and the total ownership is 160 acres. The area mined will be a maximum of 30 acres and in the future there will be a stock pond that will be mined to a depth of a maximum of ten feet. He indicated that the applicant will discuss some minor changes today.

Presentation:

Vance Hall, representing K. Ross Trucking, Inc., 5615 East 80th Place, Tulsa, Oklahoma 74136, submitted a letter of agreement and site plan (Exhibit A-1) and stated he does have some minor modifications to the letter of agreement. Mr. Hall cited the changes to the letter of agreement. Mr. Hall stated that the letter submitted constitutes the agreement reached between his client and the protestant's attorney.

Comments and Questions:

Mr. Alberty asked if there is a timetable on when his client will attempt to mine the remaining acreage of the 130 acres that is not under application today. Mr. Alberty further questioned if the mining will be held to the five-foot maximum depth. In response, Mr. Hall stated that his client does not have current plans to mine the remainder of the acreage except to have hauls roads and stockpiles as needed. Mr. Hall indicated that his client will store his equipment on the acreage as well. Mr. Hall stated that the remainder acreage will not be under the application to the Oklahoma State Department of Mines. Mr. Hall indicated that if his client desires to mine the remainder of the acreage he will have to apply for a modification to the mining permit.

Interested Parties Comments:

Dwayne Smith, 35 East 18th Street, Tulsa, Oklahoma 74119, representing Texhoma Royalty Corporation, stated that he did meet with the application and all objections have been resolved. He reported that Texhoma Royalty Corporation withdraws their objection, subject to the condition that all of the conditions in the letter of agreement (Exhibit A-1) are set out as conditions imposed on the special exception by the Board. He requested that the letter of agreement be made a part of the record.

Case No. 1683 (continued)

Board Action:

On **MOTION** of **ALBERTY**, the Board voted 4-0-0 (Alberty, Dillard, Looney, Walker aye"; no "nays", no "abstentions"; Tyndall "absent") to **APPROVE** a Special Exception to Allow mining/dirt removal (non-coal) in an AG zoned district.

SECTION 310. PRINCIPAL USES PERMITTED IN THE AGRICULTURE DISTRICT, subject to the letter of agreement (Exhibit A-1) and subject to detail site plan approval by the Board prior to initiating mining of the area not considered a part of the original 30 acres, finding that the special exception will be in harmony with the spirit and intent of the Code, and will not be injurious to the neighborhood or otherwise detrimental to the public welfare, on the following described property:

NE, SW, NE, S/2, SW, NE, NW, SE, NE, SW, SE, E/2, SE of Section 4,
T-20-N, R-13-3, Tulsa County, State of Oklahoma.

HALL GEOLOGICAL SERVICES, LLC
5615 East 80th Place
Tulsa, OK 74136
URL: www.hgs-llc.com
(918) 481-5866 Fax: (918) 492-3184
November 16, 1999

Dwight L. Smith, Esq.
Levinson, Smith, and Abrahamson
35 East 18th Street
Tulsa, Oklahoma 74119

TRANSMITTED BY FAX

Re: Application for special exception to allow mining/dirt removal (non-coal) in an AG zoned District; parts of Sec. 4, T20N, R13E, Tulsa County, Oklahoma
CBOA 1683

Dear Mr. Smith:

On November 10, Jean Heinecke and I met with you and Tom Coates to discuss the referenced application for a special exception to zoning. We discussed the concerns that you expressed during the October 19 INCOG Board of Adjustment hearing. At the conclusion of the meeting, we agreed that K. Ross Trucking, Inc. would modify its applications as described herein if your client, Texhoma Royalty Corporation, will cease its opposition to the proposed non-coal (soil) mining operation.

Pursuant to our agreement, I have listed certain details and modifications of the K. Ross Trucking mine plan that may become conditions of 1) the special exception to zoning and 2) the non-coal mining permit. Provided that Texhoma Royalty Corporation agrees in writing that it will not oppose the subject mining operation and the related special exception to zoning, K. Ross Trucking agrees to these provisions:

1. The 160-acre tract described in the initial special exception application and in the initial non-coal mining permit application will be reduced to 130 acres by removing the 30-acre tract in the NE $\frac{1}{4}$ of Section 4 from zoning and non-coal mining permit applications.
2. The active mine area within the 130-acre permit area will be limited to soil mining and to no more than 30 acres, not including access and storage areas where no excavation will occur.
3. K. Ross Trucking may, at its sole discretion, construct a stock pond as a part of the reclamation plan; the depth of the pond below the ground surface will not exceed ten feet and the areal extent of the pond excavation will not exceed five acres.
4. Except for the area of the stock pond described above, the depth of excavation will not exceed five feet below the ground surface. (The K. Ross Trucking non-coal mining permit application describes mining depths of from two to five feet.)
5. The active mining (soil excavation) will be limited to the areas that are determined to contain no wetlands by the U. S. Department of Agriculture Natural Resources Conservation Service or by the U. S. Army Corps of Engineers.
6. Areas disturbed by mining (soil excavation) will be restored to pasture in a manner approved by the Oklahoma Department of Mines.
7. No further special exception applications to allow mining or dirt removal from the 30 excluded acres described above in the NE $\frac{1}{4}$ of Section 4, T20N, R13E, may be presented or considered before January 1, 2015.

K. Ross Trucking

Non-Coal Mining (Soil Excavation)
Special Exception to Zoning

Exhibit A-1

8. The "Site Plan" attached hereto, marked as Exhibit "A" illustrates many of the above conditions, including those set forth in paragraphs numbered one, two and three, and is adopted by this reference.

K. Ross Trucking will not request the modifications to the original applications for special exception to zoning and non-coal mining permit unless Texhoma Royalty Corporation agrees in writing that it will not oppose the non-coal mining (soil excavation) described herein. Please ask your client to confirm the tentative agreement that we reached at the mine site last week.

Sincerely,
Hall Geological Services, LLC



R. Vance Hall, CPG

Attachment: EXHIBIT "A" – SITE PLAN

XC: Jay Stump

EXHIBIT A

TULSA COUNTY BOARD OF ADJUSTMENT (CBOA) - CASE # 1683

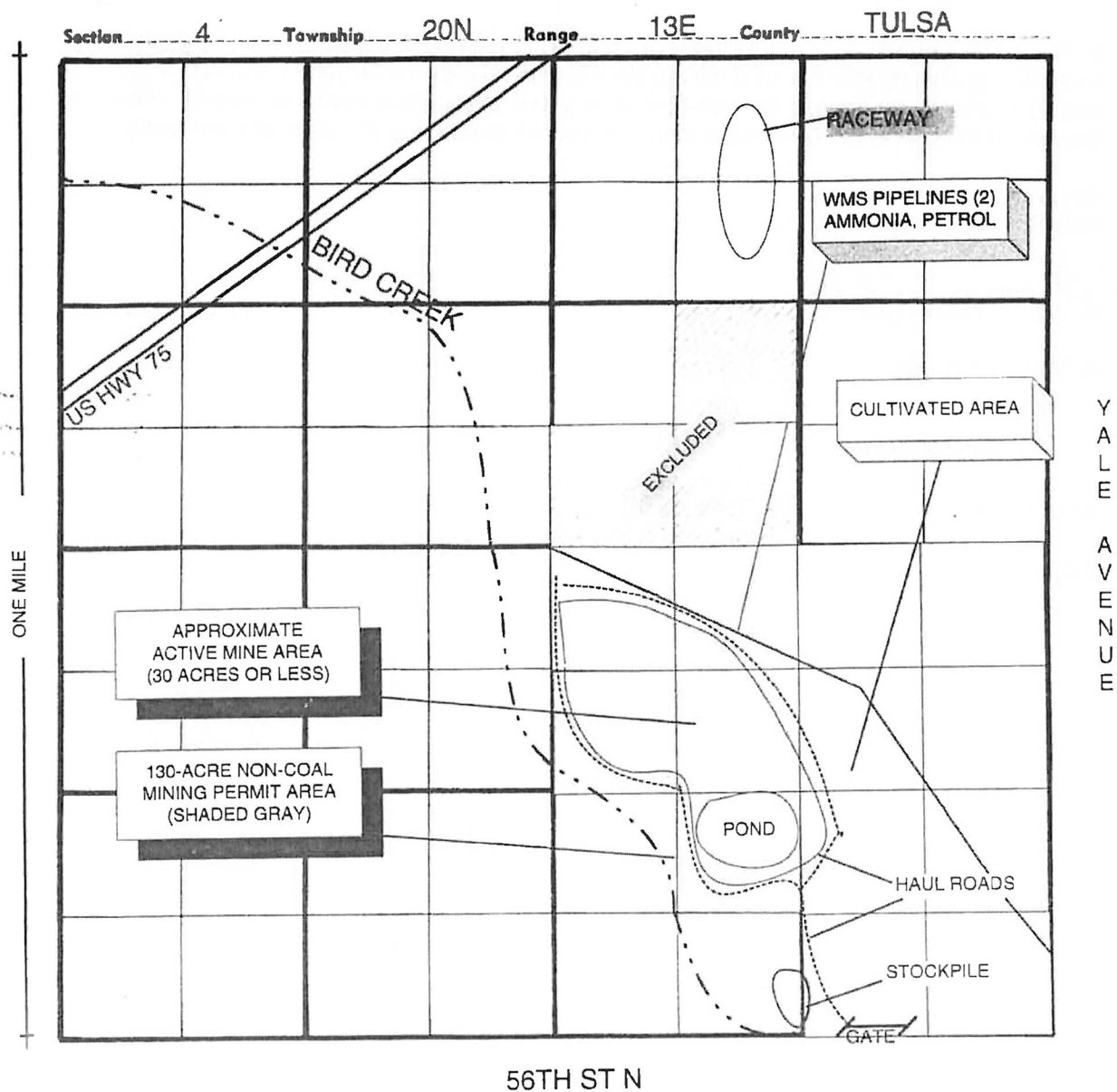

SITE PLAN

Special Exception Request

K. ROSS TRUCKING, INC.

November 1999



BOARD OF ADJUSTMENT CASE REPORT

ATLAS: 0
STR: 403
CZM: 22

NO.: 1683
PD: 15

HEARING DATE: October 19, 1999

APPLICANT: Keith Ross

ACTION REQUESTED: Special Exception to allow mining/dirt removal (non-coal) in an AG zoned district.
SECTION 310. PRINCIPAL USES PERMITTED IN THE AGRICULTURE DISTRICT

LOCATION: N & W of NW/c E. 56th St. N. & N. Yale

ZONED: AG

PRESENT USE: vacant

TRACT SIZE: irregular

LEGAL DESCRIPTION: NE, SW, NE, S/2, SW, NE, NW, SE, NE, SW, SE, E/2 SE of Section 4, T-20-N, R-13-E,
Tulsa County, State of Oklahoma

RELEVANT PREVIOUS ACTIONS:

ANALYSIS OF SURROUNDING AREA: The subject property is surrounded by AG and IM zoning/uses

STAFF COMMENTS:

The subject site is located at the northwest corner of Yale Avenue and East 56th Street North and is approximately 160 acres in size. Hwy 75 is approximately ¼ mile to the northwest. The primary access to the site will be off of 56th Street North. A portion of Bird Creek, which flows northwest/southeast in this area, is located in the west-central portion of the site. The proposed area of disturbance is shown to be something less than 30 acres.

The surrounding area is primarily vacant, it appears that some level of removal has occurred directly to the west on the west side of the creek.

Staff does not have information at this time regarding depth of removal, detention/drainage/silt trapping systems or the applicant's state permit status.

**BOARD OF ADJUSTMENT
CASE REPORT**

ATLAS: 0
STR: 403
CZM: 22

NO.: 1683
PD: 15

HEARING DATE: October 19, 1999 /November 16, 1999

APPLICANT: Keith Ross

ACTION REQUESTED: Special Exception to allow mining/dirt removal (non-coal) in an AG zoned district.
SECTION 310. PRINCIPAL USES PERMITTED IN THE AGRICULTURE DISTRICT

LOCATION: N & W of NW/c E. 56th St. N. & N. Yale

ZONED: AG

PRESENT USE: vacant

TRACT SIZE: irregular

LEGAL DESCRIPTION: NE, SW, NE, S/2, SW, NE, NW, SE, NE, SW, SE, E/2 SE of Section 4, T-20-N, R-13-E,
Tulsa County, State of Oklahoma

RELEVANT PREVIOUS ACTIONS:

ANALYSIS OF SURROUNDING AREA: The subject property is surrounded by AG and IM zoning/uses

STAFF COMMENTS:

October 19, 1999:

The subject site is located at the northwest corner of Yale Avenue and East 56th Street North and is approximately 160 acres in size. Hwy 75 is approximately ¼ mile to the northwest. The primary access to the site will be off of 56th Street North. A portion of Bird Creek, which flows northwest/southeast in this area, is located in the west-central portion of the site. The proposed area of disturbance is shown to be something less than 30 acres.

The surrounding area is primarily vacant, it appears that some level of removal has occurred directly to the west on the west side of the creek.

Staff does not have information at this time regarding depth of removal, detention/drainage/silt trapping systems or the applicant's state permit status.

November 16, 1999:

The item was continued at the October meeting.

Staff has not received additional information.

BOA CASE REPORT SUMMARY

DATE OF FINAL ACTION	CASE NUMBER	SUMMARY	S-T-R 403
0/21/1980	CBOA-0009	The Board approved a variance to allow oil and gas wells and related storage located north and east of the northeast corner of North Harvard Avenue and East 56th Street North. SW SW Section 4 T20N R13E	
6/24/1983	CBOA-0204	On June 18, 1982 the Board approved a special exception to allow a sanitary landfill in an AG zoned district. On June 24th, 1983 the Board voted to deny a request from the building inspector to rescind the special exception approval. Property being located on the north side of 56th Street North and on the south side of Highway 75.	
7/15/1986	CBOA-0666	The Board approved a special exception to allow a Use Unit 2 (rifle and pistol range) per concept plan and conditions for the Tulsa County Sheriff's office in an IM zoned district. Property being located east of the southeast corner of 66th Street North and U.S. Highway 75. LAUSEN PARK ADD. B 1 L 1	
4/15/1997	CBOA-1497	Board approved a special exception to permit a 100' PCS monopole antenna tower in a AG district per plan submitted. Subject to a 110% setback from any abutting properties and removal if the antenna is abandoned for 180days, designed for collocation. Located 3404 East 66th Street North GOVT LOT 4 NW NW	

Section 4 Township 20N Range 13E County TULSA



56TH ST N

SITE PLAN

Special Exception Request

K. ROSS TRUCKING, INC.

September 1999

TULSA COUNTY BOARD OF ADJUSTMENT (CBOA) - **1683**

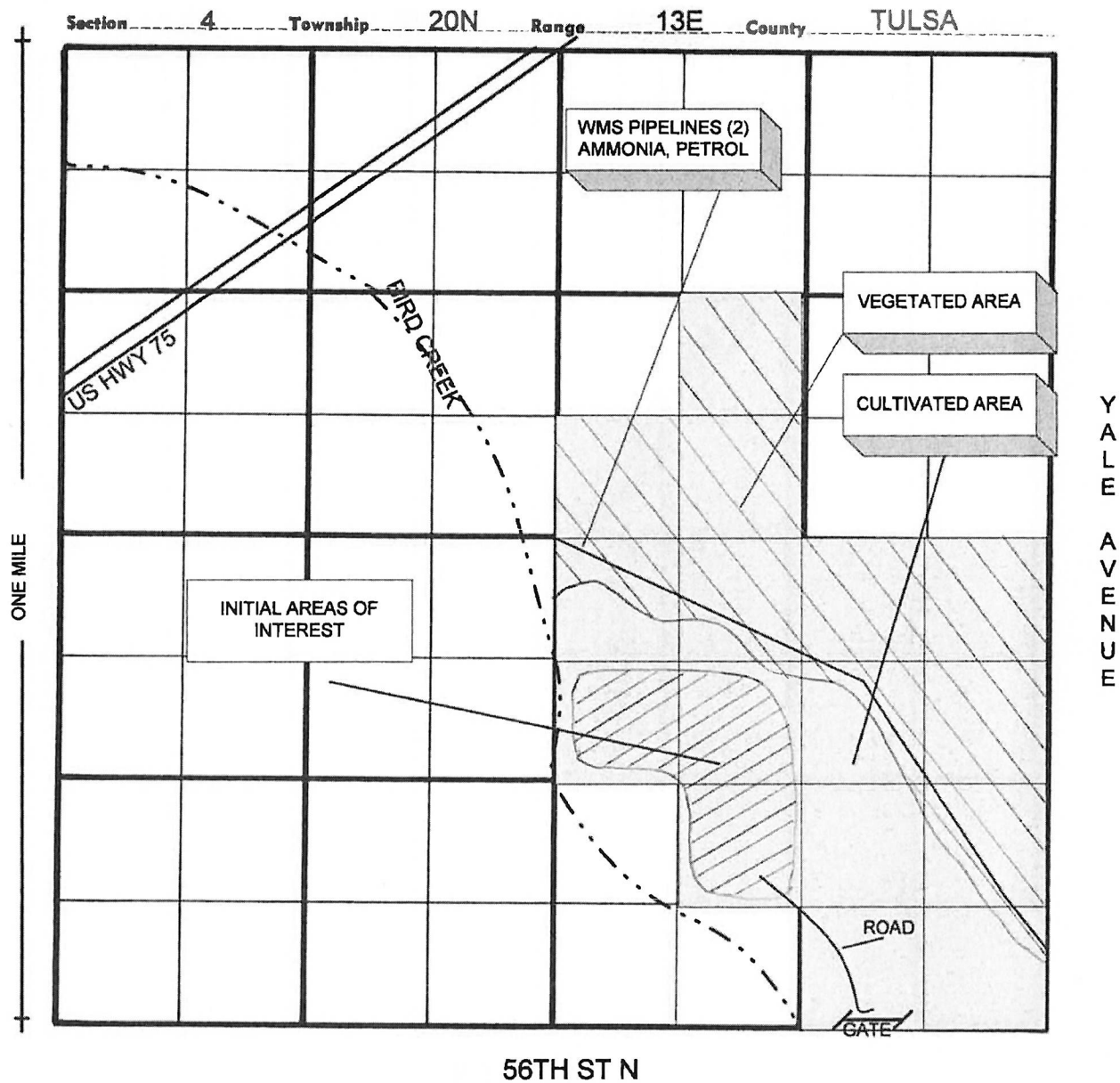

SITE PLAN

Special Exception Request

K. ROSS TRUCKING, INC.

September 1999



TULSA COUNTY BOARD OF ADJUSTMENT
CASE NO. 1683
OFFICIAL RECORD: EXHIBIT 11-1
ENTERED IN THE 10-19-99
MINUTES OF THE TULSA COUNTY BOARD OF ADJUSTMENT.

K. ROSS TRUCKING, INC.

SPECIAL EXCEPTION REQUEST
September 1999

REQUESTS FOR A VARIANCE:

1. Application of the zoning ordinance requirements to this particular piece of property will create unnecessary hardship.

The business, K. Ross Trucking, Inc., cannot exist without the exception.

2. There are conditions which are peculiar to this piece of property which do not apply to other properties in the same zoning district.

A market exists for soil materials found on this property.

3. The variance, if granted, will not cause substantial detriment to the public good or impair the purpose and intent of the zoning ordinance or the comprehensive plan.

The variance, if granted, will benefit the public good by providing fill material to construction contractors and the City of Tulsa.

HALL GEOLOGICAL SERVICES, LLC**5615 East 80th Place
Tulsa, OK 74136****(918) 481-5866 Fax: (918) 492-3184****URL: www.hgs-llc.com****November 15, 1999**

Post/lt	Date	# of pages
Fax No. R7673	11/15/99	2
To	Scott Bruce	
Fax#	583-1024	
From	Vance Hall	
Phone#	481-5866	

963

Dwight L. Smith, Esq.
Levinson, Smith, and Abrahamson
35 East 18th Street
Tulsa, Oklahoma 74119

TRANSMITTED BY FAX

Re: Application for special exception to allow mining/dirt removal (non-coal) in an AG zoned District; parts of Sec. 4, T20N, R13E, Tulsa County, Oklahoma
CBOA 1683

Dear Mr. Smith:

On November 10, Jean Heinecke and I met with you and Tom Coates to discuss the referenced application for a special exception to zoning. We discussed the concerns that you expressed during the October 19 INCOG Board of Adjustment hearing. At the conclusion of the meeting, we agreed that K. Ross Trucking, Inc. would modify its applications as described herein if your client, Texhoma Royalty Corporation, will cease its opposition to the proposed non-coal (soil) mining operation.

Pursuant to our agreement, I have listed certain details and modifications of the K. Ross Trucking mine plan that may become conditions of 1) the special exception to zoning and 2) the non-coal mining permit. Provided that Texhoma Royalty Corporation agrees in writing that it will not oppose the subject mining operation and the related special exception to zoning, K. Ross Trucking agrees to these provisions:

1. The 160-acre tract described in the initial special exception application and in the initial non-coal mining permit application will be reduced to 130 acres by removing the 30-acre tract in the NE $\frac{1}{4}$ of Section 4 from zoning and non-coal mining permit applications.
2. The active mine area within the 130-acre permit area will be limited to no more than 30 acres, not including access and storage areas where no excavation will occur.
3. K. Ross Trucking may, at its sole discretion, construct a stock pond as a part of the reclamation plan; the depth of the pond below the ground surface will not exceed ten feet and the areal extent of the pond excavation will not exceed five acres.
4. Except for the area of the stock pond described above, the depth of excavation will not exceed five feet below the ground surface. (The K. Ross Trucking non-coal mining permit application describes mining depths of from two to five feet.)
5. The active mining (soil excavation) will be limited to the areas that are determined to contain no wetlands by the U. S. Department of Agriculture Natural Resources Conservation Service or by the U. S. Army Corps of Engineers.
6. Areas disturbed by mining (soil excavation) will be restored to pasture in a manner approved by the Oklahoma Department of Mines.
7. K. Ross Trucking will not request a special exception to zoning to allow non-coal mining or dirt removal for the 30 acres it owns in the NE $\frac{1}{4}$ of Sec. 4, T20N, R13E, Tulsa County, Oklahoma, before January 1, 2015.

K. Ross Trucking

Non-Coal Mining (Soil Excavation)
Special Exception to Zoning

K. Ross Trucking will not request the modifications to the original applications for special exception to zoning and non-coal mining permit unless Texhoma Royalty Corporation agrees in writing that it will not oppose the non-coal mining (soil excavation) described herein. Please ask your client to confirm the tentative agreement that we reached at the mine site last week.

Sincerely,
Hall Geological Services, LLC

R. Vance Hall, CPG

Enclosure: Property Map (Faxed November 11, 1999 by Jean T. Heinecke)

XC: Jay Stump

19605

HALL GEOLOGICAL SERVICES, LLC
 5615 East 80th Place
 Tulsa, OK 74136
 (918) 481-5866 Fax: (918) 492-3184
 URL: www.hgs-llc.com
 November 15, 1999

Post/lt	Date	# of pages
Fax Note RT673	11/15/99	2
To	Scott Bruce	
Fax#	583-1024	
From	Vance Hall	
Phone#	481-5866	

Dwight L. Smith, Esq.
 Levinson, Smith, and Abrahamson
 35 East 18th Street
 Tulsa, Oklahoma 74119

TRANSMITTED BY FAX

Re: Application for special exception to allow mining/dirt removal (non-coal) in an AG zoned District; parts of Sec. 4, T20N, R13E, Tulsa County, Oklahoma
 CBOA 1683

Dear Mr. Smith:

On November 10, Jean Heinecke and I met with you and Tom Coates to discuss the referenced application for a special exception to zoning. We discussed the concerns that you expressed during the October 19 INCOG Board of Adjustment hearing. At the conclusion of the meeting, we agreed that K. Ross Trucking, Inc. would modify its applications as described herein if your client, Texhoma Royalty Corporation, will cease its opposition to the proposed non-coal (soil) mining operation.

Pursuant to our agreement, I have listed certain details and modifications of the K. Ross Trucking mine plan that may become conditions of 1) the special exception to zoning and 2) the non-coal mining permit. Provided that Texhoma Royalty Corporation agrees in writing that it will not oppose the subject mining operation and the related special exception to zoning, K. Ross Trucking agrees to these provisions:

1. The 160-acre tract described in the initial special exception application and in the initial non-coal mining permit application will be reduced to 130 acres by removing the 30-acre tract in the NE¼ of Section 4 from zoning and non-coal mining permit applications.
2. The active mine area within the 130-acre permit area will be limited to no more than 30 acres, not including access and storage areas where no excavation will occur.
3. K. Ross Trucking may, at its sole discretion, construct a stock pond as a part of the reclamation plan; the depth of the pond below the ground surface will not exceed ten feet and the areal extent of the pond excavation will not exceed five acres.
4. Except for the area of the stock pond described above, the depth of excavation will not exceed five feet below the ground surface. (The K. Ross Trucking non-coal mining permit application describes mining depths of from two to five feet.)
5. The active mining (soil excavation) will be limited to the areas that are determined to contain no wetlands by the U. S. Department of Agriculture Natural Resources Conservation Service or by the U. S. Army Corps of Engineers.
6. Areas disturbed by mining (soil excavation) will be restored to pasture in a manner approved by the Oklahoma Department of Mines.
7. K. Ross Trucking will not request a special exception to zoning to allow non-coal mining or dirt removal for the 30 acres it owns in the NE¼ of Sec. 4, T20N, R13E, Tulsa County, Oklahoma, before January 1, 2015.

K. Ross Trucking

Non-Coal Mining (Soil Excavation)
 Special Exception to Zoning

K. Ross Trucking will not request the modifications to the original applications for special exception to zoning and non-coal mining permit unless Texhoma Royalty Corporation agrees in writing that it will not oppose the non-coal mining (soil excavation) described herein. Please ask your client to confirm the tentative agreement that we reached at the mine site last week.

Sincerely,
Hall Geological Services, LLC

R. Vance Hall, CPG

Enclosure: Property Map (Faxed November 11, 1999 by Jean T. Heinecke)

XC: Jay Stump

HALL GEOLOGICAL SERVICES, LLC

5615 East 80th Place

Tulsa, OK 74136

URL: www.hgs-llc.com

(918) 481-5866 Fax: (918) 492-3184

November 16, 1999

ADJUSTMENT
MINUTES OF THE TULSA COUNTY BOARD OF
ENTERED IN THE
OFFICIAL RECORD: EXHIBIT
CASE NO. 1683
TULSA COUNTY BOARD OF ADJUSTMENT
TRANSMITTED BY FAX

Dwight L. Smith, Esq.
Levinson, Smith, and Abrahamson
35 East 18th Street
Tulsa, Oklahoma 74119

Re: Application for special exception to allow mining/dirt removal (non-coal) in an AG zoned District; parts of Sec. 4, T20N, R13E, Tulsa County, Oklahoma
CBOA 1683

Dear Mr. Smith:

On November 10, Jean Heinecke and I met with you and Tom Coates to discuss the referenced application for a special exception to zoning. We discussed the concerns that you expressed during the October 19 INCOG Board of Adjustment hearing. At the conclusion of the meeting, we agreed that K. Ross Trucking, Inc. would modify its applications as described herein if your client, Texhoma Royalty Corporation, will cease its opposition to the proposed non-coal (soil) mining operation.

Pursuant to our agreement, I have listed certain details and modifications of the K. Ross Trucking mine plan that may become conditions of 1) the special exception to zoning and 2) the non-coal mining permit. Provided that Texhoma Royalty Corporation agrees in writing that it will not oppose the subject mining operation and the related special exception to zoning, K. Ross Trucking agrees to these provisions:

1. The 160-acre tract described in the initial special exception application and in the initial non-coal mining permit application will be reduced to 130 acres by removing the 30-acre tract in the NE $\frac{1}{4}$ of Section 4 from zoning and non-coal mining permit applications.
2. The active mine area within the 130-acre permit area will be limited to soil mining and to no more than 30 acres, not including access and storage areas where no excavation will occur.
3. K. Ross Trucking may, at its sole discretion, construct a stock pond as a part of the reclamation plan; the depth of the pond below the ground surface will not exceed ten feet and the areal extent of the pond excavation will not exceed five acres.
4. Except for the area of the stock pond described above, the depth of excavation will not exceed five feet below the ground surface. (The K. Ross Trucking non-coal mining permit application describes mining depths of from two to five feet.)
5. The active mining (soil excavation) will be limited to the areas that are determined to contain no wetlands by the U. S. Department of Agriculture Natural Resources Conservation Service or by the U. S. Army Corps of Engineers.
6. Areas disturbed by mining (soil excavation) will be restored to pasture in a manner approved by the Oklahoma Department of Mines.
7. No further special exception applications to allow mining or dirt removal from the 30 excluded acres described above in the NE $\frac{1}{4}$ of Section 4, T20N, R13E, may be presented or considered before January 1, 2015.

K. Ross Trucking

Non-Coal Mining (Soil Excavation)
Special Exception to Zoning

8. The "Site Plan" attached hereto, marked as Exhibit "A" illustrates many of the above conditions, including those set forth in paragraphs numbered one, two and three, and is adopted by this reference.

K. Ross Trucking will not request the modifications to the original applications for special exception to zoning and non-coal mining permit unless Texhoma Royalty Corporation agrees in writing that it will not oppose the non-coal mining (soil excavation) described herein. Please ask your client to confirm the tentative agreement that we reached at the mine site last week.

Sincerely,
Hall Geological Services, LLC

A handwritten signature in cursive script, reading "R. Vance Hall".

R. Vance Hall, CPG

Attachment: EXHIBIT "A" – SITE PLAN

XC: Jay Stump

EXHIBIT A

TULSA COUNTY BOARD OF ADJUSTMENT (CBOA) - CASE # 1683

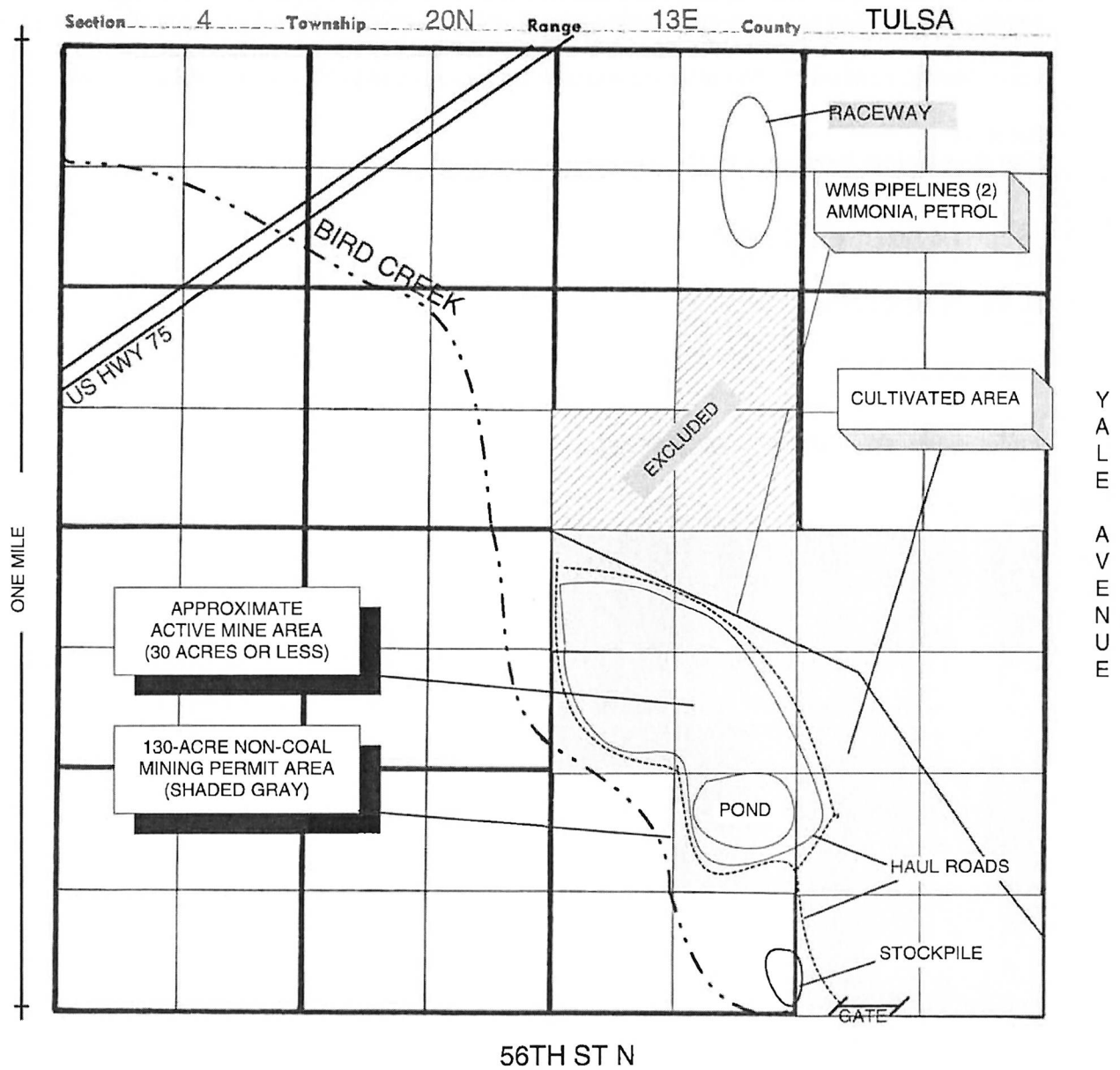

SITE PLAN

Special Exception Request

K. ROSS TRUCKING, INC.

November 1999



HALL GEOLOGICAL SERVICES, LLC
5615 East 80th Place
Tulsa, OK 74136
(918) 481-5866 Fax: (918) 492-3184
URL: www.hgs-llc.com
November 15, 1999

Post#	Date	# of pages
Fax Note R7673	11/15/99	2
To	Scott Bruce	
Fax#	583-1024	
From	Vance Hall	
Phone#	481-5866	

130 ac app
 30 ac mine
 deep 10' in pond area

TRANSMITTED BY FAX

5' outside pond.

Dwight L. Smith, Esq.
 Levinson, Smith, and Abrahamson
 35 East 18th Street
 Tulsa, Oklahoma 74119

Re: Application for special exception to allow mining/dirt removal (non-coal) in an AG zoned District; parts of Sec. 4, T20N, R13E, Tulsa County, Oklahoma
 CBOA 1683

Dear Mr. Smith:

On November 10, Jean Heinecke and I met with you and Tom Coates to discuss the referenced application for a special exception to zoning. We discussed the concerns that you expressed during the October 19 INCOG Board of Adjustment hearing. At the conclusion of the meeting, we agreed that K. Ross Trucking, Inc. would modify its applications as described herein if your client, Texhoma Royalty Corporation, will cease its opposition to the proposed non-coal (soil) mining operation.

Pursuant to our agreement, I have listed certain details and modifications of the K. Ross Trucking mine plan that may become conditions of 1) the special exception to zoning and 2) the non-coal mining permit. Provided that Texhoma Royalty Corporation agrees in writing that it will not oppose the subject mining operation and the related special exception to zoning, K. Ross Trucking agrees to these provisions:

1. The 160-acre tract described in the initial special exception application and in the initial non-coal mining permit application will be reduced to 130 acres by removing the 30-acre tract in the NE $\frac{1}{4}$ of Section 4 from zoning and non-coal mining permit applications.
2. The active mine area within the 130-acre permit area will limited to no more than 30 acres, not including access and storage areas where no excavation will occur.
3. K. Ross Trucking may, at its sole discretion, construct a stock pond as a part of the reclamation plan; the depth of the pond below the ground surface will not exceed ten feet and the areal extent of the pond excavation will not exceed five acres.
4. Except for the area of the stock pond described above, the depth of excavation will not exceed five feet below the ground surface. (The K. Ross Trucking non-coal mining permit application describes mining depths of from two to five feet.)
5. The active mining (soil excavation) will be limited to the areas that are determined to contain no wetlands by the U. S. Department of Agriculture Natural Resources Conservation Service or by the U. S. Army Corps of Engineers.
6. Areas disturbed by mining (soil excavation) will be restored to pasture in a manner approved by the Oklahoma Department of Mines.
7. K. Ross Trucking will not request a special exception to zoning to allow non-coal mining or dirt removal for the 30 acres it owns in the NE $\frac{1}{4}$ of Sec. 4, T20N, R13E, Tulsa County, Oklahoma, before January 1, 2015.

K. Ross Trucking

Non-Coal Mining (Soil Excavation)
 Special Exception to Zoning

K. Ross Trucking will not request the modifications to the original applications for special exception to zoning and non-coal mining permit unless Texhoma Royalty Corporation agrees in writing that it will not oppose the non-coal mining (soil excavation) described herein. Please ask your client to confirm the tentative agreement that we reached at the mine site last week.

Sincerely,
Hall Geological Services, LLC

R. Vance Hall, CPG

Enclosure: Property Map (Faxed November 11, 1999 by Jean T. Heinecke)

XC: Jay Stump

HALL GEOLOGICAL SERVICES, LLC
5615 East 80th Place
Tulsa, OK 74136
(918) 481-5866 Fax: (918) 492-3184
URL: www.hgs-llc.com
November 15, 1999

Post#
 Fax Note R7673
 To Jay Stump
 Fax# 583-1024
 From Vance Hall
 Phone# 481-5866

Dwight L. Smith, Esq.
 Levinson, Smith, and Abrahamson
 35 East 18th Street
 Tulsa, Oklahoma 74119

TRANSMITTED BY FAX

Re: Application for special exception to allow mining/dirt removal (non-coal) in an AG zoned District; parts of Sec. 4, T20N, R13E, Tulsa County, Oklahoma
CBOA 1683

Dear Mr. Smith:

On November 10, Jean Heinecke and I met with you and Tom Coates to discuss the referenced application for a special exception to zoning. We discussed the concerns that you expressed during the October 19 INCOG Board of Adjustment hearing. At the conclusion of the meeting, we agreed that K. Ross Trucking, Inc. would modify its applications as described herein if your client, Texhoma Royalty Corporation, will cease its opposition to the proposed non-coal (soil) mining operation.

Pursuant to our agreement, I have listed certain details and modifications of the K. Ross Trucking mine plan that may become conditions of 1) the special exception to zoning and 2) the non-coal mining permit. Provided that Texhoma Royalty Corporation agrees in writing that it will not oppose the subject mining operation and the related special exception to zoning, K. Ross Trucking agrees to these provisions:

1. The 160-acre tract described in the initial special exception application and in the initial non-coal mining permit application will be reduced to 130 acres by removing the 30-acre tract in the NE $\frac{1}{4}$ of Section 4 from zoning and non-coal mining permit applications.
2. The active mine area within the 130-acre permit area will be limited to no more than 30 acres, not including access and storage areas where no excavation will occur.
3. K. Ross Trucking may, at its sole discretion, construct a stock pond as a part of the reclamation plan; the depth of the pond below the ground surface will not exceed ten feet and the areal extent of the pond excavation will not exceed five acres.
4. Except for the area of the stock pond described above, the depth of excavation will not exceed five feet below the ground surface. (The K. Ross Trucking non-coal mining permit application describes mining depths of from two to five feet.)
5. The active mining (soil excavation) will be limited to the areas that are determined to contain no wetlands by the U. S. Department of Agriculture Natural Resources Conservation Service or by the U. S. Army Corps of Engineers.
6. Areas disturbed by mining (soil excavation) will be restored to pasture in a manner approved by the Oklahoma Department of Mines.
7. K. Ross Trucking will not request a special exception to zoning to allow non-coal mining or dirt removal for the 30 acres it owns in the NE $\frac{1}{4}$ of Sec. 4, T20N, R13E, Tulsa County, Oklahoma, before January 1, 2015.

K. Ross Trucking

Non-Coal Mining (Soil Excavation)
 Special Exception to Zoning

K. Ross Trucking will not request the modifications to the original applications for special exception to zoning and non-coal mining permit unless Texhoma Royalty Corporation agrees in writing that it will not oppose the non-coal mining (soil excavation) described herein. Please ask your client to confirm the tentative agreement that we reached at the mine site last week.

Sincerely,
Hall Geological Services, LLC



R. Vance Hall, CPG

Enclosure: Property Map (Faxed November 11, 1999 by Jean T. Heinecke)

XC: Jay Stump

**NOTICE OF HEARING BEFORE THE BOARD OF ADJUSTMENT
COUNTY OF TULSA, OKLAHOMA**

PD 15

**North & West of Northwest corner East 56th Street North & North Yale
Case No. 1683**

F

Notice is hereby given that a public hearing will be held before the Board of Adjustment, in **Room 119, Administration Building, 500 South Denver, Tulsa, Oklahoma at 1:30 p.m., on October 19, 1999**, to consider the application of Keith Ross for a Special Exception to allow mining/dirt removal (non-coal) in an AG zoned district. The property is located: North & West of Northwest corner East 56th Street North & North Yale. Legal Description: NE, SW, NE, S/2, SW, NE, NW, SE, NE, SW, SE, E/2 SE of Section 4, T-20-N, R-13-E, Tulsa County, State of Oklahoma, and being located in an AG zoned district. All persons interested in this matter may be present at this hearing and present their objections to or arguments for the request.

For information call: (918) 584-7526.

Refer to County Board of Adjustment Case No. 1683



CBOA-1683
TFXHOMA ROYALTY CORP
3405 DEL MONTE
HOUSTON TX 77019

CBOA-1683
K ROSS TRUCKING CO
2201 E 56TH ST N
TULSA OK 74130

CBOA-1683
INDUSTRIES FOR TULSA INC
616 S BOSTON
TULSA OK 74119-1222

CBOA-1683
INDUSTRIES FOR TULSA INC
616 S BOSTON
TULSA OK 74119-1222

CBOA-1683
VOLENTINE, RAY C & LORI &
RICHARD & CHERRIE STUNKARD
10717 S DELAWARE
TULSA OK 74137

CBOA-1683
INTERNATIONAL AMERICAN
CERAMICS INC
C/O AVTAX INC
P O BOX 35527
TULSA OK 74153-0527

CBOA-1683
MCCLUSKEY, WM H ETAL
C/O EVA ANN & GUY PICKARD
7301 MISSION RD STE 323
PRAIRIE VILLAGE KS 66208

CBOA-1683
MCCLUSKEY, WM H ETAL
C/O EVA ANN & GUY PICKARD
7301 MISSION RD STE 323
PRAIRIE VILLAGE KS 66208

CBOA-1683
INDUSTRIES FOR TULSA
C/O AVTAX INC
PO BOX 35527
TULSA OK 74153-0527

CBOA-1683
SHAW, JAY LLOYD & NEELY SUE
6106 N YALE
TULSA OK 74117

CBOA-1683
HACKER, WILLIAM LEE & VIOLET O
6200 N YALE
TULSA OK 74117-2407

CBOA-1683
INDUSTRIES FOR TULSA INC
616 S BOSTON
TULSA OK 74119-1222

CBOA-1683
TULSA COUNTY
500 S DENVER RM 320
TULSA OK 74103-3832

CBOA-1683
SHAW, JACK L & ELEANOR
6100 N YALE AV
TULSA OK 74117-2405

CBOA-1683
CHRISTMAS, CLIFFORD & CHERYL
6212 N YALE AVE
TULSA OK 74126

CBOA-1683
WATERS, REGINA & HENRY MONROE
C/O GEORGE D MONROE
1111 E YOUNG ST
TULSA OK 74106-3930

CBOA-1683
LAMBERT, PATSY MARIE
PO BOX 6545
TULSA OK 74156

CBOA-1683
LAMBERT, PATSY MARIE
PO BOX 6545
TULSA OK 74156

CBOA-1683
INDUSTRIES FOR TULSA INC
616 S BOSTON
TULSA OK 74119-1222

CBOA-1683
ROSS, KEITH & DARLENE
2201 E 56TH ST N
TULSA OK 74130

CBOA-1683
VOLENTINE, RAY C & LORI &
RICHARD & CHERRIE STUNKARD
10717 S DELAWARE
TULSA OK 74137

CBOA-1683
VOLENTINE, RAY C & LORI &
RICHARD & CHERRIE STUNKARD
10717 S DELAWARE
TULSA OK 74137

CBOA-1683
TULSA COUNTY
500 S DENVER RM 320
TULSA OK 74103-3832

CBOA-1683
TULSA COUNTY
500 S DENVER RM 320
TULSA OK 74103-3832

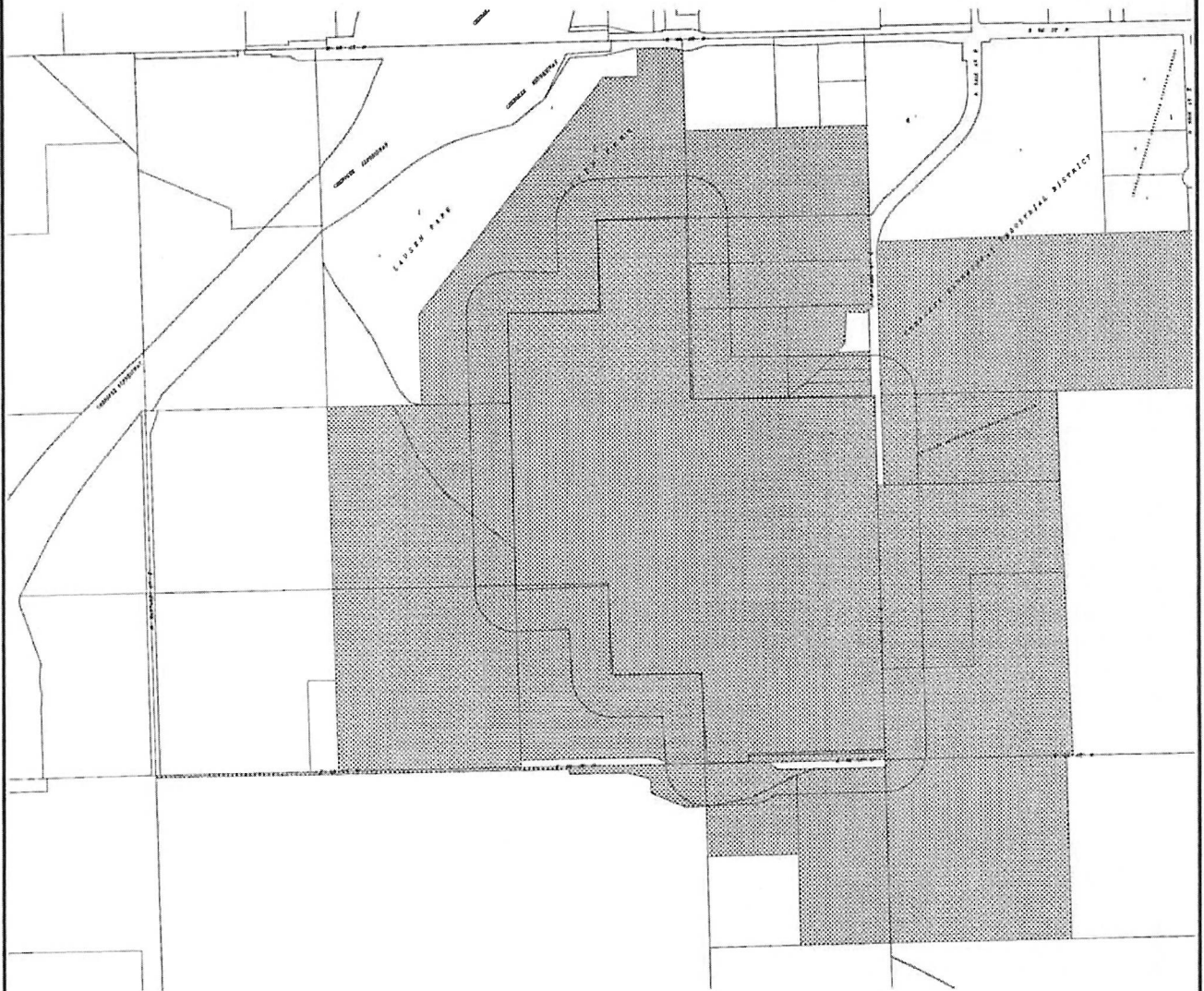

nina
Sep 29, 1999

INCOG

1"=1237'

PUBLISHER'S AFFIDAVIT

NOT OF HRG-Appli. Keith Ross, PD 15, N & W of
NW/c E. 56th St. N. & N. Yale.

PUBLICATION DATE(S)

9/29/99

NUMBER

1683

Invoice No. 57744 C

LEGAL NOTICE

STATE OF OKLAHOMA

COUNTY OF TULSA

} SS

I, of lawful age, being duly sworn, am a legal representative of The Tulsa Daily Commerce & Legal News of Tulsa, Oklahoma, a daily newspaper of general circulation in Tulsa County, Oklahoma, printed in the English Language and published in the City of Tulsa in Tulsa County, State of Oklahoma, regularly, continuously and uninterruptedly published in the County for a period of more than 104 consecutive weeks prior to the first publication of the attached notice and having paid circulation therein and with admission to the United States mails as second class mail matter and printed in Tulsa, Tulsa County, where delivered to the United States mail.

That said notice, a true copy of which is attached hereto, was published in the regular edition of said newspaper during the period and time of publication and not in a supplement, on the ABOVE LISTED DATE(S)

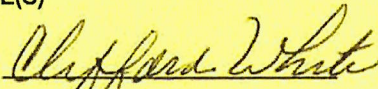
(Representative Signature)

Subscribed and sworn to me this 30th day of
September, 99

Notary Public

My Commission Expires

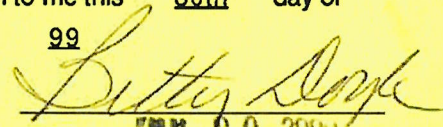
JAN 30 2000

Customer INDIAN NATIONS COUNCIL OF
GOVERNMENT

1717 201 W. 5th St., Ste 600
TULSA, OK 74103

Publisher's Fee \$38.00

C 57744

Published in the Tulsa Daily
Commerce & Legal News
on September 29, 1999.

NOTICE OF HEARING BEFORE
THE BOARD OF ADJUSTMENT
COUNTY OF TULSA,
OKLAHOMA

PD 15 N & W of NW/c E. 56th
St. N. & N. Yale
CASE NO. 1683

F
Notice is hereby given that a public hearing will be held before the Board of Adjustment, in Room 119, Administration Building, 500 South Denver, Tulsa, Oklahoma at 1:30 p.m., on October 19, 1999, to consider the application of Keith Ross for a Special Exception to allow mining/dirt removal (non-coal) in an AG zoned district. The property is located: N & W of NW/c E. 56th St. N. & N. Yale. Legal Description: NE, SW, NE, S/2, SW, NE, NW, SE, NE, SW, SE, E/2 SE of Section 4, T-20-N, R-13-E, Tulsa County, State of Oklahoma, and being located in an AG zoned district. All persons interested in this matter may be present at this hearing and present their objections to or arguments for the request. For information call (918) 584-7526.

Jenna Bedwell

From: ross trucking <dumptrucks_ross@yahoo.com>
Sent: Thursday, December 26, 2024 2:32 PM
To: Jenna Bedwell
Subject: Re: [EXTERNAL] Re: K. Ross Trucking - Review of Renewal Application
Attachments: CBOA-1683.pdf

RECEIVED

DEC 26 2024

DEPT. OF MINES

Forwarding you INCOG original permit and it is still active, with no expiration date

there are no other permits

On Thursday, December 26, 2024 at 01:54:33 PM CST, Jenna Bedwell <jenna.bedwell@mines.ok.gov> wrote:

Thank you, Ms. Ross. Please send whatever correspondence or documents you have related to INCOG, NRCS, or county flood plain management.

If you have any additional questions, please call me – 405-522-9843.

Jenna

From: ross trucking <dumptrucks_ross@yahoo.com>
Sent: Thursday, December 26, 2024 1:21 PM
To: Jenna Bedwell <jenna.bedwell@mines.ok.gov>
Subject: [EXTERNAL] Re: K. Ross Trucking - Review of Renewal Application

On Thursday, December 26, 2024 at 12:32:49 PM CST, Jenna Bedwell <jenna.bedwell@mines.ok.gov> wrote:

Good afternoon,

Attached is the letter and enclosures that was mailed on November 1. Please review and call me at 405-522-9843.

The permit fee was received on October 28, 2024 (copy attached).

Thank you,
Jenna

Jenna Bedwell

Chief of Minerals Permitting/Executive Assistant to the Director
Oklahoma Department of Mines
2915 N. Classen Blvd., Suite 213
Oklahoma City, OK 73106
Tel: 405-522-9843
Fax: 405-424-4932

PERMIT RENEWAL APPLICATION FORM

OAC 460:10-19-5

Date 10/23/24

Current Permit Number LE1774-A Mine Name or Number _____

K. ROSS TRUCKING INC 918 4255558 Keithross@hughes.net
Name of Company, Corporation, Partnership, Individual Telephone Number Email Address

5802 N. YALE AVE TULSA OK 74117
Street, R.F.D., Box No. City State Zip Code

Section 4 Township 20 N Range 138 County TULSA

Section _____ Township _____ Range _____ County _____

Renewal Term Requested: _____ Original Permit Term: _____

Permitted Acreage approved: _____ Bonded Acreage approved: _____

Is a permitted acreage increase needed: ☒ NO ☐ YES

Permit acreage increases must be applied for as a new permit application in accordance with OAC 460:10-19-5. (b), (2), (B)

I, (Company Official) Angela Ross Certify that the (Company, Corporation, Individual(s) K. ROSS TRUCKING INC has the right and power by Legal Estate owned to mine the land for which this renewal application is made. We hereby certify that all details contained in this Permit Renewal Request are true and correct to the best of my knowledge. We fully understand that any willful misrepresentation of facts will be cause for permit revocation.

Signature of Company Official Angela Ross Position _____

Subscribed and sworn to before me this 10/24/24 day of _____
My Commission expires 10/06/25 Notary Public Katrina Faith Marr

Complete applications for renewal must be submitted prior to the expiration of the permit. Copies of all Issued Permits or Licenses from other agencies must be attached to this request.

OCT 28 2024

DEPT. OF MINES

