

State of Oklahoma
Department of Mines
2915 N. Classen Blvd., Ste. 213
Oklahoma City, OK 73106

APPLICATION FOR PERMIT TO ENGAGE IN NON-COAL MINING

The Mining Lands Reclamation Act, O.S., 2016 721-728

Section 1

RECEIVED

MAR - 3 2026

DEPT. OF MINES

ODM Permit Number 1887-F
(Office Use Only)

Date 04-Feb-2026

Number of years permit plan is requested: Lifetime of Mine

Dolese Bros. Co. (405) 235-2311
Name of Company, Corporation, Partnership, Individual Telephone Number

8300 N. Oklahoma Ave. Oklahoma City OK 73144
Mailing Address City State Zip Code

rbutler@dolese.com
Email Address

Hereby make application for a permit to mine (type of mineral): Natural Sand

by the following method: Surface Underground

Specify Method:

Quarrying Stripping Dredging Pumping Auger Mining
Hydraulic Mining Other _____

Guthrie Sand Plant
Mine Name or Number (Optional)

Guthrie
Nearest Town

21, 22, 27, & 28
Section(s)

17N 02W Logan
Township Range County

Section(s)

Township Range County

Section(s)

Township Range County

Type of perimeter markers to be used: Steel fence posts with color banded PVC pipe caps and existing fence lines.

RECEIVED

MAR - 3 2026

DEPT. OF MINES

Operational Section General Characteristics of the Mine

NOTE: All of the following questions must be thoroughly answered regarding your mining operation for the intended life of the mine.

1. Answer **all** of the following that apply:

1a. If this is an application for a **NEW** permit, indicate the total acreage at the site to be covered by the permit: N/A

Will this application replace a limited use permit? Yes No

Limited Use Permit No: N/A

1b. If this application is for the **RENEWAL** of a mining permit, indicate the mining permit number and the total (overall) acreage covered by the existing permit.

Mining Permit No: N/A Total Permitted Acreage: N/A

1c. If this application is for the **REVISION** of a mining permit, indicate the mining permit number and the total (overall) acreage covered by the existing permit:

Mining Permit No: L.E.-1887-E Total Permitted Acreage: 1,016

Does this request involve the acreage **within** the previously approved permitted boundary?

Yes No

If yes, indicate the acreage to be covered by this revision: N/A

Does this request involve acreage to be added to the previously approved permitted boundary?

Yes No

If yes, indicate the acreage to be added by this request: 21

If no was indicated, please explain the revision request: _____

This request will be considered an amendment to the permit (Title 45 SS 724 J.).

The application must be submitted as required by and in accordance with OAC:10-19-4.(d).

1d. If this application for the **TRANSFER** of a mining permit, indicate the mining permit number and the total (overall) acreage covered by the existing permit.

Mining Permit No: N/A Total Permitted Acreage: N/A

Name of Company: N/A

1e. If this application for the **PURCHASE** of a mining permit, indicate the mining permit number and the total (overall) acreage covered by the existing permit.

Mining Permit No: N/A Total Permitted Acreage: N/A

Name of Company: N/A

Will additional acreage be affected? Yes No

If yes, indicate how much additional acreage will be added: N/A

All the acreage within the "Operational Section must include the proposed mine excavation(s), processing plants, haul roads, stockpiles, and any refuse/waste areas or tailing ponds.

Total Permitted and Bonded Acres and Mapping Requirements

2. Will you file bond covering all your mining acreage under your plan or will you file for an incremental mining plan?

Total Permit Acres: 1,033 Incremental Bonding: Yes No

Please show your acreage below. If you have indicated incremental mining plan, then your acreage will be progressive to each incremental area. Prior to the issuance of this permit, a bonding map must be included detailing the sequence proposed for incremental bonding.

460:10-9-6. Mine maps should be accurate drawings, aerial photographs, or enlarged topographic maps of the entire mine area and of a scale sufficient to clearly illustrate the following:

(1) Outline of the area to be permitted detailing the affected areas, incremental mining areas, planned future reserves if requested by the applicant, buffer zones, easements, and rights-of-ways, for the number of years the permit is requested.

460:10-21-4. (b) An operator shall not disturb surface acreage or extend any underground shafts, tunnels, or operations prior to receipt of approval from the Department of a performance bond covering the surface acreage to be affected.

(1) Liability on the performance bond shall cover all non-coal surface mining and reclamation operations to be conducted within the permit area. Except for limited use permits, after the amount of the bond has been determined for the permit area in accordance with Subchapter 23 of this Chapter, the permittee or applicant may either file:

- (A) The entire performance bond required during the term of the permit;*
- (B) A cumulative bond schedule and the sequence of release of acreage as it progresses through varying reclamation phases and for the addition of acreage as it is affected. The amount of bond required to obtain a permit shall include the full reclamation cost of the initial area being affected; or*
- (C) An incremental bond schedule and the new performance bond required for the first increment in the schedule.*

(2) When the operator elects to "increment" the amount of the performance bond during the term of the permit, he shall identify the initial and successive incremental areas for bonding on the permit application map submitted for approval as provided in Subchapter 17 of this Chapter and shall specify the proportion of the total bond amount required for the term of the permit which will be filed prior to commencing operations on each incremental area. The schedule amount of each performance bond increment shall be filed with the Department at least 45 days prior to the commencement of non-coal surface mining and reclamation operations in the next incremental area.

A separate schedule detailing each increment must be attached to the application. An Incremental bonding map must be submitted if the total permitted acreage is not covered by bond.

Total Acreage to be covered by the permit: 1,033

REQUIRED Bond coverage: Minimum bond shall be \$2,000.00.

Type: Surety: Cash: Check: Certificate of Deposit:
Letter of Credit: Other: _____

Bond Number Identification: 107802578 Amount of Bond Coverage: \$ 1,141,500.00
Bond coverage submitted must be a total of the first increment or the entire permitted acreage requested.

RECEIVED

MAR - 3 2026

State of Oklahoma
Department of Mines
2915 N. Classen Blvd., Ste. 213
Oklahoma City, OK 73106

DEPT. OF MINES

LEGAL ESTATE

Name of Legal Estate Owner: Dolese Bros. Co.

Mailing Address: 8300 N. Oklahoma Ave. Oklahoma City, OK 73114

Telephone Number: (405) 235-2311

21, 22, 27, and 28 17N 02W Logan
Section(s) Township Range County

Section(s) Township Range County

Is the permit application area owned or leased? Owned Leased

I, Leland Meiser certify that I am the owner of the
(Legal Estate Owner)

Legal estate of the property being represented in this Application for a Non-Coal Mining Permit, and that the
(Company, Corporation, Individual(s)) Dolese Bros. Co.
have the right to mine this property.

Signature of Legal Estate Owner: *Leland Meiser*

Subscribed and sworn to before me this 9th day of February 20 26

My Commission expires 6-15-2027 Notary Public *Savannah Owen*

IF THE OWNER OF THE LEGAL ESTATE OF THE PROPERTY CHANGES, A NEW LEGAL ESTATE FORM MUST BE SIGNED BY THE NEW OWNER OF THE LEGAL ESTATE. IF THERE ARE MULTIPLE OWNERS OF THE PROPERTY ON THIS APPLICATION, A SEPARATE LEGAL ESTATE FORM MUST BE EXECUTED FOR EACH OWNER.

NOTE: The Department of Mines does not have authority to adjudicate property title disputes.

SAVANNAH OWEN
NOTARY PUBLIC - STATE OF OKLAHOMA
MY COMMISSION EXPIRES JUN. 15, 2027
COMMISSION # 23009093

PUBLIC NOTIFICATION

(Applicable for all applications requiring public notice.)

Please provide the name, city, and county of the newspaper you intend to use for your notice:

Name of Newspaper: Guthrie News Leader
City/Town of Newspaper: Guthrie, OK
County of Newspaper: Logan

A copy of your application will be available on the Department of Mines website for public inspection once ODM rules the application complete. Your notice must disclose this information. A sample publication notice will be provided to you.

THIS NOTICE MUST NOT BE PUBLISHED UNTIL THE APPLICATION HAS BEEN RULED COMPLETE BY ODM AND MADE AVAILABLE FOR PUBLIC INSPECTION.

Submit under separate cover a copy of the Public Notice and the Publisher's Affidavit or other Proof of Publication as required by Title 45 § 724 H.1 a. & b. (1) through (6).

RECEIVED

MAR - 3 2026

DEPT. OF MINES

COMPLIANCE AND RELATED INFORMATION



Section 2

MAR - 3 2026

DEPT. OF MINES

ODM Permit Number 1887-F
(Office Use Only)

Date 04-Feb-2026

Dolese Bros. Co. (405) 235-2311

Name of Company, Corporation, Partnership, Individual Telephone Number

8300 N. Oklahoma Ave. Oklahoma City OK 73114

Mailing Address City State Zip Code

NOTE: Answer all questions on this form. (If no answer, write "none"). Properly identify and secure any attached exhibits, if used. Please refer to the specific item number of this form.

Identification of Interests – In compliance with Section 460:10-11-5 of the Rules and Regulations for Non-Coal Surface Mining and Reclamation, the APPLICANT is required to furnish the following:

460:10-11-5(b)

1. Applicant is (check one box below):

Sole Proprietorship LLC Corporation Partnership Other _____

2a. Please Provide the names of every officer, partner, director, or other person performing similar to director of the applicant.

See Attachment

Name Address City State Zip Position

Name Address City State Zip Position

Name Address City State Zip Position

Name Address City State Zip Position

Name Address City State Zip Position

460:10-11-5(c)

Did the applicant, partner, or corporation or subsidiary of, operate a non-coal surface mining operation in the State of Oklahoma within the five (5) years preceding the date of the application? Yes No

If yes, answer the following

See Attachment

Name of Mine	City	County	Legal Location of Mine	Permit #

Please include any additional mining operations on a separate sheet.

Compliance Information

460:10-11-6(1)

1. Has the applicant for the permit, or any subsidiary, affiliate or by or under common control with the applicant:

460:10-11-6(1)(A)

1a. Had a federal or state mining permit suspended or revoked in the last five (5) years? Yes No

460:10-11-6(1)(B)

1b. Forfeited a mining bond or similar security deposited in lieu of bond? Yes No

RECEIVED

MAR - 3 2026

DEPT. OF MINES

460:10-11-6(2)

2. If the answer to either 1a. or 1b. above was yes, applicant should provide the following information:

460:10-11-6(2)(A)

2a. Permit Identification # N/A, or Amount of Bond \$ N/A

2b. Provide the name of the authority that suspended or revoked a permit or forfeited a bond:

N/A

Provide the reason for such action: N/A

460:10-11-6(2)(B)

2c. What is the current status of the permit, bond or similar security involved?

N/A

460:10-11-6(2)(C)

2d. Provide the date, location and type of administrative or judicial proceedings initiated concerning the suspension, revocation or forfeiture:

	Location	Type
<u>N/A</u>		<u>N/A</u>

460:10-11-6(2)(D)

2e. What is the current status of these proceedings? N/A

RECEIVED

MAR - 3 2026

DEPT. OF MINES

460:10-11-5(b) 2a

Name	Address	City	State	Zip	Position
Mark Helm	8300 N. Oklahoma Ave.	Oklahoma City	Oklahoma	73114	Chief Executive Officer
Pete Simms	8300 N. Oklahoma Ave.	Oklahoma City	Oklahoma	73114	Chief Financial Officer
Kermit Frank	8300 N. Oklahoma Ave.	Oklahoma City	Oklahoma	73114	Vice President, Communications and Community Relations
Leland Meiser	8300 N. Oklahoma Ave.	Oklahoma City	Oklahoma	73114	President
Cheryl Ramirez	8300 N. Oklahoma Ave.	Oklahoma City	Oklahoma	73114	Vice President, Organizational Development
Cory Shreffler	8300 N. Oklahoma Ave.	Oklahoma City	Oklahoma	73114	Executive Director, Aggregate Division
Ryan Prugh	8300 N. Oklahoma Ave.	Oklahoma City	Oklahoma	73114	General Counsel & Corporate Secretary
Toni Ashley	8300 N. Oklahoma Ave.	Oklahoma City	Oklahoma	73114	Executive Director, Human Resources
David Finley	8300 N. Oklahoma Ave.	Oklahoma City	Oklahoma	73114	Executive Director, Information & Operational Technology
Scott Brewer	8300 N. Oklahoma Ave.	Oklahoma City	Oklahoma	73114	Executive Vice President, Chief Strategy Officer
Suzie Smith	8300 N. Oklahoma Ave.	Oklahoma City	Oklahoma	73114	Controller
Jeff Carlson	8300 N. Oklahoma Ave.	Oklahoma City	Oklahoma	73114	Procurement Director
Jake Hillemeier	8300 N. Oklahoma Ave.	Oklahoma City	Oklahoma	73114	Director, Learning & Organizational Development
Ryan Finley	8300 N. Oklahoma Ave.	Oklahoma City	Oklahoma	73114	Director, Health, Safety and Environmental
Robert Cote	8300 N. Oklahoma Ave.	Oklahoma City	Oklahoma	73114	Engineering Director
Garret King	8300 N. Oklahoma Ave.	Oklahoma City	Oklahoma	73114	Director, Technology Infrastructure & Service

RECEIVED

MAR - 3 2026

DEPT. OF MINES

460:10-11-5(c)

Name of Mine	City	County	Legal Location of Mine (Entrance)	Permit Number
7-Mile Mine	Ponca City	Kay	Sec 27, T27N, R3E	LE-1893-E
Ardmore Quarry	Ardmore	Carter	Sec 27, T5S, R1E	LE-1651-G
Big Canyon Quarry	Sulphur	Murray	Sec 19, T2S, R3E	LE-1656-B
Carnegie Quarry	Carnegie	Caddo	Sec 31, T6N, R13W	LE-1415-B
Coleman Quarry	Coleman	Atoka	Sec 33, T3S, R9E	LE-1170-F
Cooperton Quarry	Mountain View	Kiowa	Sec 32, T6N, R15W	LE-1653-D
Davis Quarry	Davis	Murray	Sec 9, T1S, R1E	LE-1646-D
Drumright Quarry	Drumright	Creek	Sec 36, T18N, R7E	LE-1636-M
Hartshorne Quarry	Hartshorne	Pittsburg	Sec 7, T4N, R17E	LE-1652-H
Little Rock Road Quarry	Coleman	Atoka	Sec 28, T3S, R9E	LE-1360-E
Pawnee Quarry	Pawnee	Pawnee	Sec 30, T22N, R6E	LE-1598-J
Richards Spur Quarry	Elgin	Comanche	Sec 6, T3N, R11W	LE-1654-H
Roosevelt Quarry	Roosevelt	Kiowa	Sec 18, T4N, R17W	LE-2489-C
Crescent Sand Plant	Crescent	Logan	Sec 19, T16N, R4W	LE-2066
Dover Sand Plant	Dover	Kingfisher	Sec 13, T17N, R7W	LE-1657-L
First Capital Sand Plant	Guthrie	Logan	Sec 04, T17N, R2W	LE-2813
Guthrie Sand Plant	Guthrie	Logan	Sec 21, T17N, R2W	LE-1887-E
Jones Sand Plant	Jones	Oklahoma	Sec 1, T12N, R1W	LE-1836-B
Oilton Sand Plant	Oilton	Creek	Sec 27, T19N, R7E	LE-1293-A
Shawnee Sand Plant	Shawnee	Pottawatomie	Sec 10, T10N, R4E	LE-2067-A
White Eagle Sand Plant	Ponca City	Kay	Sec 28, T25N, R2E	LE-2576-A

RECEIVED

MAR - 3 2026

DEPT. OF MINES

PROTECTION OF NATURAL RESOURCES

RECEIVED
MAR - 3 2026
DEPT. OF MINES

Section 3

ODM Permit Number 1887-F
(Office Use Only)

04-Feb-2026

Date

Dolese Bros. Co. (405) 235-2311

Name of Company, Corporation, Partnership, Individual

Telephone Number

8300 N. Oklahoma Ave. Oklahoma City OK 73114

Mailing Address

City

State

Zip Code

Yes No

1. Will this operation involve crushing, dry screening, or using any other means of mechanically altering the mined material or involve any other air contaminant emissions?

If you indicated Yes, please be advised that a permit may be required from the Air Quality Division of the Oklahoma Department of Environmental Quality. Please contact the agency for their respective requirements.

Yes No

2a. Will the operation involve classifying or wet screening, washing the material mined, recycling processed water, or other water handling

Yes No

2b. Will the operation involve dewatering the mine or discharging fresh or wastewater from the mine or plant?

Yes No

2c. Does this operation fall within the jurisdictional requirements of the stormwater regulations of the Oklahoma Department of Environmental Quality?

If you indicated Yes to either 2a., 2b., or 2c., please be advised that a permit may be required from either the Department of Environmental Quality, Oklahoma Water Resources Board, or the Army Corps of Engineers. Please contact each agency for its respective requirements

Yes No

3. Will this operation involve removing minerals from within any boundaries of river or streambed?

If you indicated Yes, please complete Questions 4 - 5. If you indicated No, please proceed to Question 6.

4a. What is the name of the stream or river? N/A

RECEIVED
MAR - 3 2026
DEPT. OF MINES

4b. Which of the following classifies this stream or river? Please refer to OAC 460:10-13-2 for descriptions of each.

- High Quality Water (HQW) Scenic River Area
 Outstanding Resources Waters (ORW) None of the above

Please note: Certain permitting and operating procedures are required for mining permits in these environmental areas. Please refer to 460:10-13-3 for the requirements.

- Yes No 5. Does your operation overlie a sensitive sole source groundwater basin or subbasin?

Effective August 1, 2011, if you indicated Yes, this operation falls within the permitting guidelines established by SB 597. You must contact the Oklahoma Water Resources Board to comply with additional permitting requirements.

- Yes No 6a. Will explosives be used?

If Yes, review the Blasting Regulations and complete the Blasting Plan. The plan should accompany the permit application upon submission. In order to purchase, use, or store explosives on a permit, the permittee must also have a Blasting Permit Exemption.

- Yes No 6b. Does the permittee have a current Blasting Permit Exemption?

If Yes, provide Blasting Permit Exemption Number: _____ . If No, complete the Blasting Permit Exemption in addition to the Blasting Plan. If explosives will be used, a mining permit will not be issued until a plan and exemption are secured.

- Yes No 7a. In accordance with O.S. 45, Section 730, will your buffer be, at minimum, at least twenty-five (25) feet plus one and one-half (1½) times the depth of such cut as measured from original ground surface to the top of consolidated material?

- 7b. How wide will the buffer be maintained between any mining activity, any mining permit boundaries, or right-of-way at this site? 75 Feet

Show all buffer locations and widths on the mine map(s). All buffers must be located within the permit boundaries.

O.S. Title 45, Chapter 8, Section 730 "In the case of strip mining operations which remove and do not replace lateral support, unless pursuant to written agreement between the operator and the adjacent property owner, the top of the consolidated material of the open cut adjacent to the property line of other property not owned or leased by the operator shall, at the time mining is completed, not be closer to such other property line than a distance of twenty-five (25) feet plus one and one-half (1½) times the depth of such cut as measured from original ground surface to the top of consolidated material."

OTHER LICENSES AND PERMITS

Yes No

8. Has any other agency, local, county, state, or federal, been contacted to ascertain the need for other licenses and permits with respect to this operation?

If you indicated no other agencies have been contacted, please be advised failure to obtain all the permits necessary for a mining operation may result in issuance of a permit violation or an interruption in mining activity until the required permits are secured.

Please refer to the Non-Coal Permitting Guidelines and Summary and the Notice below regarding other possible governing entities that may need to be contacted. Provide a list of all other licenses and permits needed for this mining operation. If a license or permit has been issued, please provide the Permit Identification Number and date of Approval or a copy of said permit or license. (Title 45 SS 724 I.) If a permit or license is pending, please provide copies of your applications or Notices of Intent (N.O.I.) that have been submitted to other agencies.

If this application is for a revision to an existing permit, copies of all issued permits must be included.

Agency	Identification Number	Date of Approval
Oklahoma Department of Environmental Quality, Water Quality Division	OKR051037	28-Nov-2022
Oklahoma Corporation Commission	4256930	01-Jul-2025

RECEIVED
 MAR - 3 2026
 DEPT. OF MINES

Please Note: A special permit to operate within certain municipalities or counties may be required. It is the responsibility of each applicant to contact the appropriate city or county officials to determine if the mining operation falls within their respective jurisdiction.

Specialized Processing or Manufacturing

Yes No

9. *Will specialized processing or manufacturing be conducted on site with the material mined that is not directly associated to mining? This includes specialized processing of the material **after** mining and processing by a plant site immediately after excavation of the material. This product would be unique in nature and produced from the material mined. This specialized processing or manufacturing facility might not be part of the mining process, and thereby, not included in the permit area requested in the application.*

If yes was indicated, please provide ODM with a detailed narrative of the activity. The location of the specialized processing facility will need to be disclosed on the mining map. The description should include the equipment used and a flow chart showing the process. Once the description of the process is reviewed, a determination of applicability will be made by the Department. If the Department finds that the process is not directly associated with the mining, this area may be removed from permit consideration.

RECEIVED
MAR - 3 2026
DEPT. OF MINES

November 28, 2022

Ryan McClanahan
Dolese Bros Co.
8300 N Oklahoma Ave.
Oklahoma City, OK 73114

Re: Authorization to Discharge Stormwater Associated with Industrial Activity
Dolese Bros. Co., Logan County, Oklahoma
DEQ Authorization Number: OKR051037

Dear Mr. McClanahan:

The Oklahoma Department of Environmental Quality (DEQ) processed your Notice of Intent that was received on September 27, 2022. Your authorization is enclosed with this letter, which allows you to discharge stormwater associated with industrial activity under the terms and conditions of OPDES General Permit OKR05 from the following site located in Logan County.

Facility:

Dolese Bros. Co. - Guthrie Sand Plant
5740 North Highway 77
Guthrie, OK 73044

This facility is required to submit annual numeric effluent limitation monitoring for Sector J. Your facility discharges into an impaired stream that is located within one mile of the point of discharge. You are required to conduct annual impaired waters monitoring for **total suspended solids (TSS), selenium, and E. coli.** Please see Part 4.2.3 of the OKR05 permit for impaired stream monitoring, data preservation, associated BMPs, and corrective action requirements.

A copy of the Stormwater Pollution Prevention Plan (SWP3) prepared pursuant to 2022 OKR05 permit must be available all the time at your facility. You must submit an **Annual Comprehensive Site Compliance Evaluation Report (ACSCER)** to DEQ using the Form 606-005 each year by March 1. Your first report is due on March 1, 2023. A site that remains active one year from the effective date of this authorization will be invoiced for the next full permit year.

If you have any question regarding this Authorization or the Stormwater Program, please call me at (405) 702-185.

Sincerely,



Vance Doan, Permit Writer
Municipal Discharge and Stormwater Permits Section
Water Quality Division
MBM/VD/cp

RECEIVED
MAR - 3 2026
DEPT. OF MINES

**Oklahoma Department of Environmental Quality
Authorization to Discharge Under the OPDES Stormwater Industrial
General Permit OKR05**

Authorization No. OKR051037

In compliance with the Oklahoma Pollution Discharge Elimination System (OPDES) Act, 27A OS §2-6-201, the Rules of the Oklahoma Department of Environmental Quality (DEQ), and in reliance on the certified statements and representations heretofore made in its application,

**Dolese Bros Co.
8300 N Oklahoma Ave.
Oklahoma City, OK 73114**

is authorized to discharge stormwater from an industrial site located in **Logan** County at

**Dolese Bros Co. – Guthrie Sand Plant
5740 North Highway 77
Guthrie, OK 73044**

The receiving body of water is the Cimarron River. This facility discharges into a 303(d) listed stream.

**This facility is required to submit annual numeric effluent limitation monitoring.
This facility is required to conduct annual impaired stream monitoring.**

The OPDES permit requires permittees to have a Stormwater Pollution Prevention Plan (SWP3) which includes a description of appropriate control measures on site and shall be available upon request.

These requirements are applicable to your industrial site, which is subject to inspection. Proof of this authorization must be available at the facility.

The authorization shall become effective **December 1, 2022** and will expire at midnight July 4, 2027.

All terms and conditions of the OPDES Stormwater Industrial General Permit OKR05, as published on July 5, 2022, shall apply to the recipient of this authorization.



Michael B. Moe, P.E., Engineering Manager
Municipal Discharge and Stormwater Permits Section
Water Quality Division

RECEIVED

MAR - 3 2026

DEPT. OF MINES



PETROLEUM STORAGE TANK PROGRAM PERMIT CERTIFICATE

*This certifies that this facility has been duly
registered with the State of Oklahoma and that the
tank permit fees have been remitted.*

*Permit Expires
The Last day of June, 2026*

Owner ID: 9738

Mailing Address:

Dolese Bros Co
8300 N. Oklahoma Ave.
Oklahoma City, OK 73114

Facility ID: 4256930

Facility Address:

Guthrie North Sand Plant
5740 Hwy 77
Guthrie, OK 73044

The following tank(s) have been duly registered at this facility:

<u>Tank NO.</u>	<u>Comp NO.</u>	<u>Status</u>	<u>Type</u>	<u>Capacity</u>	<u>Description</u>	<u>Substance</u>
1	1	CIU	AST	8500	Steel	Gasoline
1	2	CIU	AST	1500	Steel	Diesel

RECEIVED
MAR - 3 2026
DEPT. OF MINES

Must be prominently displayed at facility.

NON-COAL OPERATOR'S RECLAMATION PLAN

Section 4

RECEIVED

APR 21 2026

DEPT. OF MINES

ODM Permit Number

1887-1

(Office Use Only)

Date 04-Feb-26

Dolese Bros. Co.

Guthrie Sand Plant

Name of Company, Corporation, Partnership, Individual

Mine Name or No.

Reclamation Plan Covers: 1,033 Permitted Acres 761 Bonded Acres

General Reclamation Plan

Use of Land when Reclamation is Completed

(Check one or more; show acreage)

Please Note: Acreage must total the entire permitted acreage.

- 1. Pasture _____
- 2. Farmland _____
- 3. Forest _____
- 4. Water Reservoir _____
- 5. Recreation _____
- 6. Industrial _____
- 7. Residential _____
- 8. Other _____ Explain: See attachment to non-coal operator's reclamation plan
- 9. None _____ Explain: _____

What will you do to make land usable for purpose stated above?

(Check one or more)

- 10. Fill 11. Level 12. Grade
- 13. Plant Grass 14. Sprig or Sod Grass 15. Set out Trees
- 16. Build Dam 17. Stock with Fish 18. Stock with Game
- 19. Other See attachment to non-coal operator's reclamation plan
- 20. None (Explain) _____

Yes No 21. Does the mineral seam contain acid-forming materials?

If yes, please complete Question #3 on the Attachment forms.

Reclamation Attachments and Narratives addressing each and every issue as outlined in the Rules & Regulations must be part of your Reclamation Plan and attached to this form.

RECEIVED

MAR - 3 2026

DEPT. OF MINES

State of Oklahoma
Department of Mines
2915 N. Classen Blvd., Ste. 213
Oklahoma City, OK 73106

NON-COAL LOCATION MAP by SECTION

The Mining Land Reclamation Act, 45 O.S. 2016 § 721-728

If, for any reason whatsoever, you stop operating at the location you show here, notify the Department of Mines immediately as your liability continues in effect until the Department is notified and/or completed reclamation is approved.

Company: Dolese Bros. Co.

1887-F

Mineral to be Mined: Natural Sand

Acres in this Section that will be covered by permit: 591

And bond: 410

Section: 21

Township: 17N

Range: 02W

County: Logan

1. *A separate page is needed for every Section.*
2. *Each One Section is divided into 10-acre tracts.*
3. *Please show all permitted and bonded acreage. (Permitted, Bonded, Additional Permitted, Additional Bonded)*

NW

NE

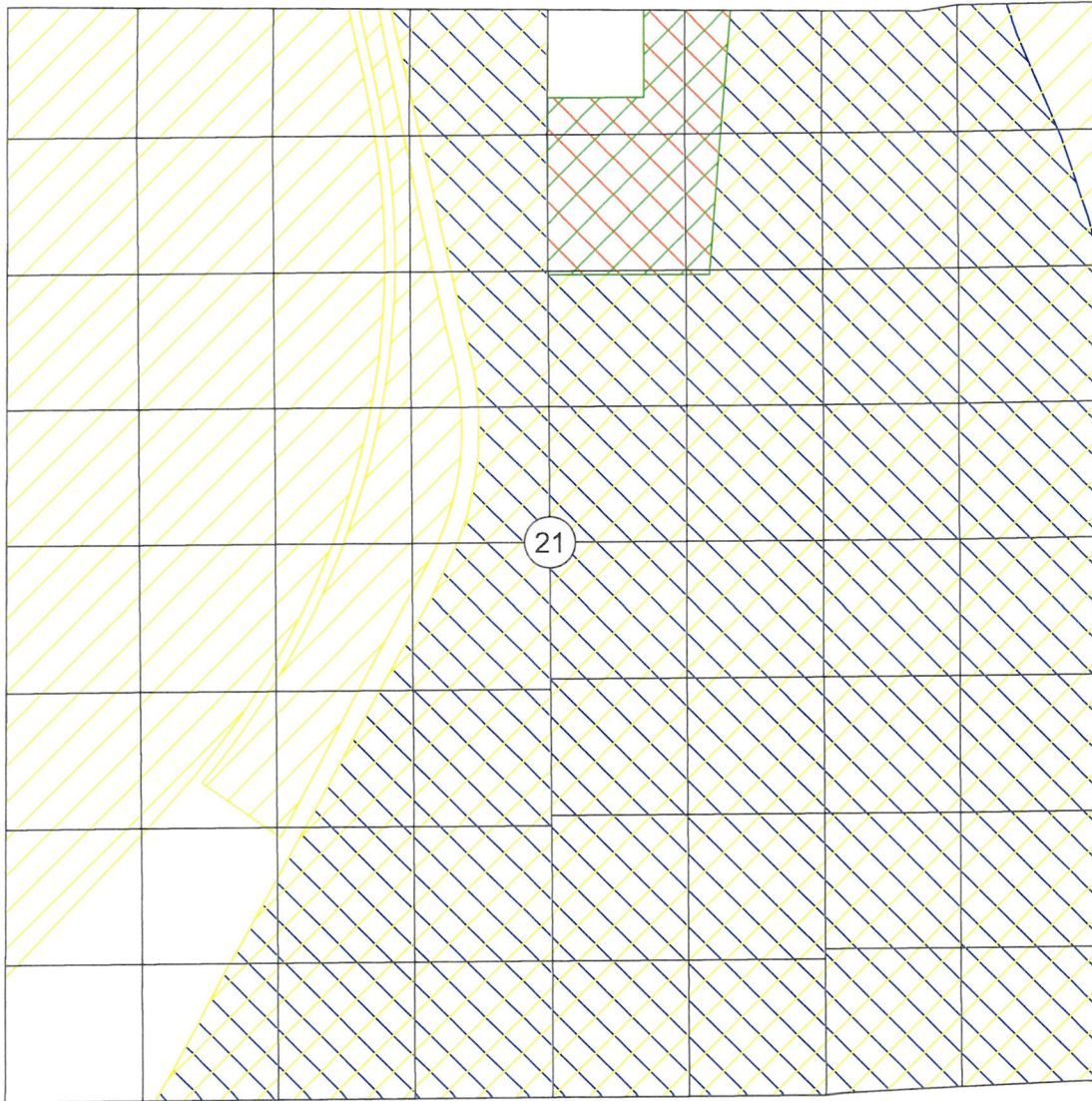

SW

SE

PLOT LOCATION as accurately as possible on map.

NOTE: PLOT ALL TRANSMISSION LINES (gas, water, electric, etc.) in accordance with HB 7135 of 1982

NON-COAL LOCATION MAP by SECTION

The Mining Land Reclamation Act, 45 O.S. 2016 § 721-728

If, for any reason whatsoever, you stop operating at the location you show here, notify the Department of Mines immediately as your liability continues in effect until the Department is notified and/or completed reclamation is approved.

Company: Dolese Bros. Co.

1887-F

Mineral to be Mined: Natural Sand

Acres in this Section that will be covered by permit: 93

And bond: 46

Section: 22

Township: 17N

Range: 02W

County: Logan

1. *A separate page is needed for every Section.*
2. *Each One Section is divided into 10-acre tracts.*
3. *Please show all permitted and bonded acreage. (Permitted, Bonded)*

NW

NE



SW

SE

PLOT LOCATION as accurately as possible on map.

NOTE: PLOT ALL TRANSMISSION LINES (gas, water, electric, etc.) in accordance with HB 7135 of 1982

NON-COAL LOCATION MAP by SECTION

The Mining Land Reclamation Act, 45 O.S. 2016 § 721-728

If, for any reason whatsoever, you stop operating at the location you show here, notify the Department of Mines immediately as your liability continues in effect until the Department is notified and/or completed reclamation is approved.

1887-F

Company: Dolese Bros. Co.

Mineral to be Mined: Natural Sand

Acres in this Section that will be covered by permit: 40 And bond: 40

Section: 27 Township: 17N Range: 02W County: Logan

1. A separate page is needed for every Section.
2. Each One Section is divided into 10-acre tracts.
3. Please show all permitted and bonded acreage. (Permitted, Bonded)

NW

NE

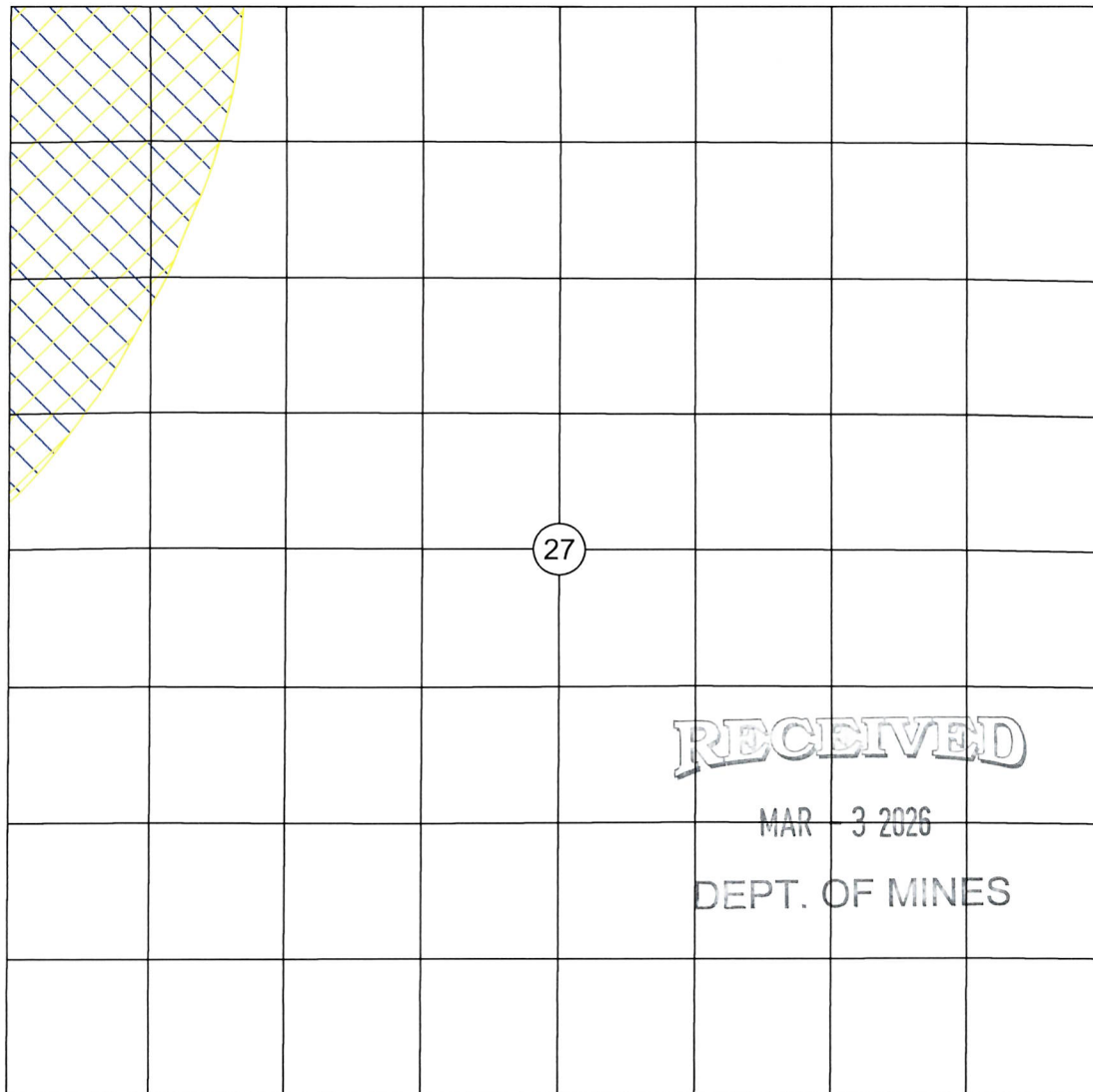

SW

SE

PLOT LOCATION as accurately as possible on map.

NOTE: PLOT ALL TRANSMISSION LINES (gas, water, electric, etc.) in accordance with HB 7135 of 1982

State of Oklahoma
Department of Mines
2915 N. Classen Blvd., Ste. 213
Oklahoma City, OK 73106

NON-COAL LOCATION MAP by SECTION

The Mining Land Reclamation Act, 45 O.S. 2016 § 721-728

If, for any reason whatsoever, you stop operating at the location you show here, notify the Department of Mines immediately as your liability continues in effect until the Department is notified and/or completed reclamation is approved.

Company: Dolese Bros. Co. 1887 F

Mineral to be Mined: Natural Sand

Acres in this Section that will be covered by permit: 309 And bond: 265

Section: 28 Township: 17N Range: 02W County: Logan

1. A separate page is needed for every Section.
2. Each One Section is divided into 10-acre tracts.
3. Please show all permitted and bonded acreage. (Permitted, Bonded)

NW

NE



SW

SE

PLOT LOCATION as accurately as possible on map.

NOTE: PLOT ALL TRANSMISSION LINES (gas, water, electric, etc.) in accordance with HB 7135 of 1982

RECEIVED

MAR - 3 2026

DEPT. OF MINES

STATEMENT OF CERTIFICATION

I, Leland Meiser _____ certify that the (Company,
(Company Official or Individual)

Corporation, Individual(s)) Dolese Bros. Co. _____

has the right and power by Legal Estate owned to mine the land for which this application is made. We hereby certify that all details contained in this Permit Application are true and correct to the best of knowledge. We fully understand that any willful misrepresentation of facts will be cause for permit Revocation.

Signature of Company Official

[Handwritten Signature]

Position President

Subscribed and sworn to before me this 9th day of February 20 26

My Commission expires 6-15-2027

Notary Public [Handwritten Signature]

NOTE: This application must be signed and notarized. This application must include one ORIGINAL copy of the Statement of Certification. Digital signatures will not be accepted. All questions must be addressed and all required documents and information provided before this application can be considered complete. Attach additional sheets as needed.

SAVANNAH OWEN
NOTARY PUBLIC - STATE OF OKLAHOMA
MY COMMISSION EXPIRES JUN. 15, 2027
COMMISSION # 23000093





EXISTING ACREAGE		ADDITIONAL ACREAGE	
PERMITTED	1,016	PERMITTED	17
BONDED	740	BONDED	21

21 Acres

740 Acres

1,016 Acres

- NOTES:**
- ALL LINES AS SHOWN ARE APPROXIMATE
 - PROPERTY OWNED OR LEASED BY DOLESE BROS. CO.

PROPERTY/LEASE LINE	
PERMIT AREA	
BONDED AREA	
ADDITIONAL PERMITTED	
ADDITIONAL BONDED	

DOLESE BROS. CO.
GUTHRIE SAND PLANT
BOCK PROPERTY ADDITION

PROPOSED BOUNDARIES

DESIGNED _____	DATE _____	SCALE: 1" = 300'
DESIGN CHECKED _____	DATE _____	PROJECT NO. _____
DRAWN REMINGTON BUTLER	DATE 21-Apr-26	SHEET 1 of 1
CHECKED _____	DATE _____	DRAWING NO. _____

REVISIONS	BY	DATE

RELEASE NO. _____