

Former City Hall
Hartshorne, OK
Owner: City of Hartshorne
Final Remediation Report



OKLAHOMA
Environmental
Quality

SITE CLEANUP ASSISTANCE PROGRAM

Brownfields performed sampling in September of 2021

- Asbestos located in building
- Over 280 sq.ft. of floor tile and mastic removed
- Abatement completed in April of 2022 and plan to use
- space for other city operations and police department
- expansion



Table of Contents

Deeds and Legal Documents

Inspection Reports

Scope of Work

Remediation Reports

Deeds and Legal Documents



Intergovernmental Agreement

This Intergovernmental Agreement (Agreement) between the Oklahoma Department of Environmental Quality (DEQ) and Hartshorne (City) is for environmental cleanup services provided by DEQ for the Property located at 1101 Pennsylvania Ave, Hartshorne, OK, Pittsburg County. The areas of responsibility and relationships presented herein provide the conceptual framework under which the project will be executed.

- I. **STATUTORY AUTHORITY AND EFFECTIVE DATE:** This Agreement is authorized pursuant to and in accordance with the provisions of Title 27A Okla. Stat. (O.S.) § 2-3-201, 27A O.S. § 2-3-202, 74 O.S. § 581, and 74 O.S. § 1008. This Agreement shall begin on March 1st, 2022 or when executed by all parties whichever date occurs of the later and will continue through February 28th, 2023 or until completion of project or through an amendment whichever occurs first.
- II. **ENVIRONMENTAL CLEANUP SERVICES:** The City has requested environmental cleanup assistance from DEQ. DEQ agrees to provide the environmental cleanup services outlined in the attached Statement of Work (**Exhibit "A"**) and the City agrees to these services.
- III. **RESPONSIBILITIES OF ALL PARTIES:** The City and DEQ mutually agree that the responsibilities shall be as stated below:
 - 1) City's Responsibilities: The City shall be responsible for the duties listed below and shall not hold DEQ responsible for any of the duties. Those duties shall include:
 - a) Appoint a representative to serve as the central point of contact on matters relating to this Agreement and submit said representatives name and contact information to DEQ within ten (10) days of the effective date of this Agreement;
 - b) Restrict occupant's use/presence in the facility during remediation, as requested. This could include but is not limited to removing equipment, vehicles and other items that may be in the way of cleanup activities;
 - c) Attend routine update calls with DEQ during the remediation process; and
 - d) Perform any continued operations and maintenance required to keep remedy protective. An Operations and Maintenance Plan will be provided by DEQ if necessary.
 - 2) DEQ's Responsibilities: DEQ shall be responsible for the duties listed below and shall not hold the City responsible for any of the duties. Those duties shall include:
 - a) Appoint a representative to serve as the central point of contact on matters relating to this Agreement and submit said representatives name and contact information to the City within ten (10) days of the effective date of this Agreement;
 - b) Provide regular verbal progress reports via calls with the City;
 - c) Manage work and cover costs associated with the environmental cleanup work outlined in the attached Statement of Work (**Exhibit "A"**);
 - d) Supply the City with a final report of all DEQ activities within 90 days of completion of work.

- IV. **ACCESS TO PROPERTY:** All access to property shall be enforced by the executed Environmental Access Permit that shall accompany this Agreement upon execution.
- V. **PUBLIC INFORMATION:** The City is generally responsible for all public information. The City shall acknowledge the DEQ cleanup services outlined in this Agreement when making public statements regarding this building. The City will allow DEQ to place signs on the property during the environmental cleanup work. DEQ may make public announcements and respond to all inquiries relating to the environmental cleanup work in this Agreement. DEQ reserves the right to approve all press releases and publications where the agency is mentioned or included before publication. The agency shall provide a contact for publicity approval within ten (10) days of execution of the Agreement. The City shall have the agency's approval before using the DEQ logo or moving any DEQ signs the agency has placed. The City and DEQ shall give the other party advance notice before making any public statement regarding work contemplated, undertaken, or completed pursuant to this Agreement.
- VI. **TERMINATION:** This Agreement is expressly contingent upon funding and shall terminate without penalty either in whole or in part if funds are not made available to DEQ. Either party may terminate this Agreement by giving written notice at least sixty (60) days prior to the desired date of cancellation.
- VII. **ACCEPTANCE OF AGREEMENT:** The parties acknowledge and agree that they have read the Agreement and that they accept the responsibilities with which they are charged. The City agrees to comply with the building use restrictions during cleanup and understands that failure to comply with said restrictions or failure to adhere to the responsibilities enumerated in this Agreement may result in delayed remediation. This Agreement shall not affect any pre-existing or independent relationships or obligations between the parties. The City's Acceptance of this Agreement from DEQ constitutes acceptance of all current DEQ Purchasing terms and conditions. Terms and conditions are subject to change and may be found at <https://www.deq.ok.gov/wp-content/uploads/deqmainresources/DEQ-Terms-and-Conditions.pdf>
- VIII. **UNAUTHORIZED OBLIGATION:** At no time during the performance of this Agreement shall the City have the authority to obligate DEQ for payment of any goods or services.

In witness whereof, this Agreement, consisting of four (4) pages has been executed and delivered effective as of the date first above written.

**City of Hartshorne
1101 Pennsylvania Ave
Hartshorne, OK, 74547**

Authorized Representative Signature Date

ASHLEY FAULKNER - MAYOR
Authorized Representative Name, Title

**Oklahoma Department of Environmental Quality
707 N. Robinson, P.O. Box 1677,
Oklahoma City, Oklahoma 73101-1677**

Authorized Representative Signature Date

Catherine Sharp, Director – Administrative Services Division
Authorized Representative Name, Title



Environmental Access Permit

THIS PERMIT made and entered into by and between **City of Hartshorne**, hereinafter called the PERMITOR, and the **DEPARTMENT OF ENVIRONMENTAL QUALITY**, hereinafter called the PERMITTEE.

WITNESSETH, PERMITTEE is hereby granted permission and authority to enter upon the following described property, situated in Pittsburg County, Oklahoma, hereinafter referred to as the "Property":

1101 Pennsylvania Ave, Hartshorne, OK, 74547

Attached and incorporated by reference as Exhibit "A": Property Location Map

TERMS AND CONDITIONS OF PERMIT:

1. **TERM**: This Permit shall be for a period of 1 year beginning March 1, 2022, and ending February 28, 2023.
2. **USE OF PROPERTY**: PERMITTEE and its consultants or contractors may enter upon said property for the performance of remedial activities, install, erect, operate, maintain, remove, and perform all work associated with said remedial activities. PERMITTEE and its consultants and contractors shall have the right of ingress and egress, to and from said site across adjoining lands of the PERMITOR. PERMITOR and PERMITTEE acknowledge that all equipment and improvements of PERMITTEE to support the said operations shall be deemed personal property of PERMITTEE.
3. **MAINTENANCE**: PERMITTEE agrees that no other changes shall be made to the Property without prior written permission of the PERMITOR other than what is necessary for the purpose of the Permit.
4. **INDEMNIFICATION**: PERMITOR agrees on its behalf and that of any successors or assigns to hold harmless, defend and indemnify the PERMITTEE, its officers, agents, employees, representatives, successors, and assigns, from and against any and all losses, liabilities, expenses, claims, demands, injuries, damages, fines, penalties, costs or judgments, including, without limitation, attorney's fees and costs of any kind. Without waiving any defense or immunity, and subject to the Oklahoma Governmental Tort Claims Act, such indemnification shall exclude any such liability to the extent caused by the negligence or willful misconduct of the PERMITTEE, its officers, agents, employees, representatives, successors, and assigns while acting within the scope of their employment.
5. **NO WARRANTIES**: The PERMITTEE makes no representations or warranties of any kind in connection with this Permit. This Permit is subject to all existing conditions, restrictions, reservations, easements, servitudes and right of ways of record.
6. **ASSIGNMENT**: This Permit cannot be assigned in whole or in part without the written approval of the PERMITTEE.
7. **TERMINATION**: Either party may terminate this Permit, or any renewals of this Permit, by giving written notice at least sixty (60) days prior to the desired date of cancellation.
8. **APPLICABLE LAW**: This Permit shall supersede any and all previous agreements whether oral or written and shall be governed by the laws of the State of Oklahoma.
9. **NON-WAIVER**: Failure of either the PERMITOR or PERMITTEE to exercise any right given hereunder or to insist upon strict compliance with regard to any term, condition or covenant specified herein, shall not constitute a waiver of the PERMITOR or PERMITTEE'S right to exercise such right or to demand strict compliance with any term, condition or covenant under this Agreement.

10. **ENTIRE AGREEMENT:** This Permit constitutes the sole and entire agreement of the parties and is binding upon the PERMITOR and the PERMITTEE, their heirs successors, legal representatives and assigns.

PERMITOR: City of Hartshorne
(Type or Print)

By: 
(Signature)
Ashley Faulkner - Mayor
(Print Name and Title)

Date: 3/9/22

PERMITTEE: Oklahoma Department of Environmental Quality

By: _____
(Signature)
Catherine Sharp
(Print Name)

Director, Administrative Services Division

Date: _____

Exhibit "A"
Property Location Map



Inspection Reports

HARTSHORNE CITY HALL

1101 PENNSYLVANIA AVENUE

HARTSHORNE, OK 74547

AUGUST 20, 2021

ASBESTOS INSPECTION

SERVICES PROVIDED FOR:

Oklahoma Department of Environmental Quality

Attention: Heather Mallory, Project Manager

707 North Robinson Avenue

Oklahoma City OK 73102

405.702.5135 | heather.mallory@deq.ok.gov

SERVICES PROVIDED BY:

Marshall Environmental Management, Incorporated

Attention: Jamie Marshall, Asbestos Management Planner

1301 N Martin Luther King Avenue

Oklahoma City, OK 73117

405.616.0401 | mem@marshallenvironmental.com

TABLE OF CONTENTS

CERTIFICATION..... 3

LABORATORY ANALYSIS PERFORMED BY 3

EXECUTIVE SUMMARY 4

SAMPLING STRATEGY & METHODOLOGY 5

OBSERVATIONS & FINDINGS..... 6

REGULATED ASBESTOS-RESPONSE ACTIONS..... 7

REGULATORY REVIEW 8

LIMITATIONS OF SURVEY..... 9

ATTACHMENTS 10

ANALYTICAL DATA..... 10

CHAIN OF CUSTODY..... 10

ANALYTICAL REPORTS..... 10

AREA DIAGRAM..... 10

PHOTOGRAPHS 10

CERTIFICATION | LICENSURE..... 10

CERTIFICATION

This is to certify that Marshall Environmental Management, Incorporated (MEM) was contracted by Heather Mallory, on behalf of the Oklahoma Department of Environmental Quality to conduct an Asbestos Inspection of the Hartshorne City Hall Building located at 1101 Pennsylvania Avenue in Hartshorne, Oklahoma. This inspection was performed between July 22nd – 23rd, 2021, by an Asbestos Hazard Emergency Response Act (AHERA) Inspector, certified by the Environmental Protection Agency (EPA) and licensed by the Oklahoma Department of Labor (ODOL) and under the direction of an AHERA Management Planner certified by the EPA and licensed by the ODOL. The findings and analytical data resulting from this inspection are believed to accurately depict the condition and location of material(s) that contain asbestos on the date this inspection was conducted.

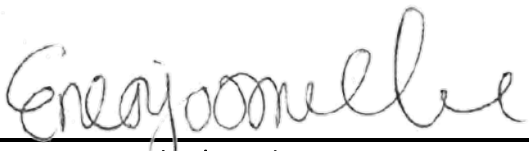

Eneajo Onuche | MEd**Industrial Hygienist***EPA AHERA Asbestos Inspector | Certification #: 804131**ODOL Asbestos Inspector | License #: 401505*

August 20, 2021

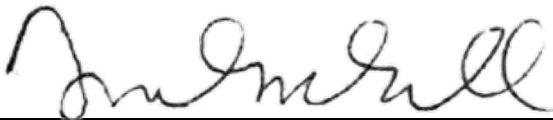
Report Date

Jamie Marshall | MS | CIH**President***EPA AHERA Asbestos Inspector/Management Planner | Certification #: 703958**ODOL Asbestos Inspector/Management Planner | License #: 400477**EPA AHERA Asbestos Project Designer | Certification #: 17023 0266**ODOL Asbestos Project Designer | License #: 400478*

August 20, 2021

Report Date**LABORATORY ANALYSIS PERFORMED BY***Marshall Environmental Management, Inc.**1301 N Martin Luther King Avenue**Oklahoma City, Oklahoma 73117**Laboratory Accreditation: AIHA PAT ID #: 102334*

HARTSHORNE CITY HALL BUILDING

ASBESTOS INSPECTION

EXECUTIVE SUMMARY

Between July 22nd – 23rd, 2021, MEM conducted an Asbestos Inspection of the Hartshorne City Hall Building located at 1101 Pennsylvania Avenue in Hartshorne, Oklahoma so that a strategy that follows the regulations set forth by the EPA may be prepared for the management and/or abatement (i.e. the removal and disposal) of material(s) that contain asbestos. As such, ***asbestos-containing floor tile and floor tile mastic*** were identified within various locations throughout the building as a result of this inspection.

Hartshorne City Hall is a one-story building with the office section vacant while the maintenance shop was still in use at the time of this inspection. While on site, most of the building materials appeared intact and in good condition throughout the building, though water damage was observed on a couple of the building materials. The EPA and the Oklahoma Department of Labor (ODOL) define an Asbestos-Containing Material (ACM) as any material that contains asbestos in concentrations greater than one percent (>1%). In accordance with the EPA, the ***asbestos-containing floor tile and floor-tile mastic are considered non-friable***, that which cannot be rendered to a powder via hand pressure. Accordingly, the asbestos-containing ***floor tile and floor-tile mastic are categorized as Category I Non-Friable ACM***. Materials that contain asbestos can exist in a structure as long as they remain undisturbed and in good condition. However, ***the asbestos-containing floor tile and floor-tile mastic must be abated prior to the commencement of renovation and/or demolition activities that would render these ACM friable***.

In accordance with the Occupational Safety and Health Administration (OSHA), the abatement of the ***asbestos-containing floor tile and floor-tile mastic are required to be carried out as Class II Work***. In addition to this, an ***EPA National Emission Standard for Hazardous Air Pollutants (NESHAP) Notification must be submitted to and approved by the Oklahoma Department of Environmental Quality (ODEQ)*** ten business-days prior to the commencement of certain renovations and any demolition activities. Lastly, ***the ODOL requires Third-Party Asbestos-Abatement Air Monitoring to take place*** while asbestos-abatement activities are taking place. The sampling location, condition, type, and quantity of material(s) identified as asbestos-containing are summarized in the Observations and Findings portion of this report. The remainder of this report is comprised of the Sampling Strategy and Methodology, the Observations and Findings, Response Actions, Regulatory Review, Limitations of the Survey, and the Appendix to this report.

SAMPLING STRATEGY & METHODOLOGY

In order to collect materials suspected of containing asbestos, each accessible area, limited to the scope of work, was systematically inspected. The sample collection process included documenting the location, condition, classification, and estimated quantity of material(s) suspected to contain asbestos. A specified number of samples were collected from material(s) that are uniform in color and texture and believed to be applied during the same period (i.e., homogenous material). If laboratory analyses determined that the sample(s) contain asbestos, the entirety of the homogenous material(s) is considered asbestos containing. This asbestos inspection was conducted in accordance with NESHAP 40-Code of Federal Regulation (CFR) 61 Subpart M. Additionally, each sample collected was submitted for analysis in accordance with the EPA authorized method 600 49-CFR Part 61 § M Asbestos NESHAP Rules. The following are examples of the types of materials that were visually inspected and/or sampled during this inspection:

SURFACING MATERIAL

- Examples include, but are not limited to, blown, or troweled on surfacing material commonly observed on ceilings, walls, or structural steel.

THERMAL SYSTEM INSULATION (TSI)

- Examples include, but are not limited to, insulation on piping, thermal process or Heating Ventilation and Air Conditioning (HVAC) equipment and components.

MISCELLANEOUS MATERIAL

- Examples include, but are not limited to, floor and ceiling tiles, mastics, vinyl sheet-flooring, wallboard, wallboard-tape, and mud or joint compounds.

OBSERVATIONS & FINDINGS

This Asbestos Inspection was performed throughout the Hartshorne City Hall Building located at 1101 Pennsylvania Avenue in Hartshorne, Oklahoma. Based on visual inspection, it appeared several modifications were made on the building over the years. The building exterior is mostly comprised of metal panel with bricks and a flat roof. The interior is comprised of concrete, wood, drywall, metal panel, acoustic ceiling tiles, vinyl sheet flooring, floor tiles, and carpeted floor. While onsite, suspect asbestos containing materials identified and sampled included floor tile, floor tile mastic, drywall systems, wall texture, insulation materials, plaster, and window glaze. As a result of this inspection, asbestos-containing 12x12 floor tile and floor tile mastic were identified within the north corner in Room 7 (Kitchen). The remaining portion of the kitchen floor comprised of ceramic floor tiles. Any floor tile or mastic identified beneath the ceramic tile should be assumed ACM until laboratory analysis determines otherwise. The following tables summarize the location, condition, type, percent asbestos, estimated quantity, and cost of abatement (used for budgeting purposes only) of the materials that were identified as asbestos containing. The correlating analytical data, area diagram (illustrating the asbestos-containing homogenous areas) and photographs are included in the appendix to this report.

CATEGORY I NON-FRIABLE ASBESTOS-CONTAINING MATERIALS

TABLE I: FLOOR TILE AND/OR BLACK FLOOR TILE MASTIC

LOCATION	CONDITION	TYPE	% ASBESTOS	ESTIMATED QUANTITY	ESTIMATED ABATEMENT COST
ROOM 7 (KITCHEN) - NORTH	GOOD	MISCELLANEOUS	5-7% CHRYSOTILE	280-FT ²	\$2,500

TOTAL ESTIMATED PRICE FOR ABATEMENT	~\$2,500
TOTAL ESTIMATED COST OF PROJECT DESIGN & THIRD-PARTY AIR MONITORING	~\$1000
TOTAL ESTIMATED COST OF ABATEMENT TO INCLUDE THIRD-PARTY AIR MONITORING	~\$3,500

REGULATED ASBESTOS-RESPONSE ACTIONS

- The asbestos-containing floor tile and floor-tile mastic must be abated prior to the commencement of renovation and/or demolition activities that would render these Asbestos-Containing Materials (ACM) friable
- The abatement of the asbestos-containing floor tile and floor-tile mastic are required to be carried out as Class II Work In accordance with the Occupational Safety and Health Administration (OSHA)
- An EPA National Emission Standard for Hazardous Air Pollutants (NESHAP) Notification must be submitted to and approved by the Oklahoma Department of Environmental Quality (ODEQ) ten business-days prior to the commencement of certain renovations and any demolition activities
- The Oklahoma Department of Labor (ODOL) requires Third-Party Asbestos-Abatement Air Monitoring to take place while asbestos-abatement activities are taking place

REGULATORY REVIEW

Asbestos Containing Materials are any materials which consist of >1% asbestos, as defined by the EPA-Approved Analytical Method 40 CFR Chapter I, Part 763, Subpart F, Appendix C, referred to as *Interim Method for determination of Asbestos in Bulk Insulation Samples*, using Polarized Light Microscopy (PLM), US EPA 600/M4-82-020 1982. Prior to 1980, asbestos was commonly utilized during construction in addition to being found in various building materials. In 1994, OSHA required employers to identify ACM in pre-1980 construction as part of its Standard for Occupational Exposure to Asbestos in Construction (29 CFR 1926.1101). This OSHA standard covers maintenance, repair, and removal functions involving ACM or Presumed ACM (PACM). In addition, the OSHA General Industry Standard (29 CFR 1910.1001) also requires employers to notify employees who would be performing housekeeping activities in public and commercial buildings around ACM or PACM. Without asbestos inspections, owners and/or operators must treat suspected ACM as asbestos-containing.

As part of the ODOL Public Employees Occupational Safety and Health (PEOSH) Program, the Oklahoma Occupational Health and Safety Standards Act and Administrative Rules (OAC 380:40) adopts most of the Federal OSHA Standards. In accordance with 29 CFR 1910.1001, the OSHA Asbestos Standard, when a building owner or employer identifies previously installed ACM and/or PACM, labels or signs shall be affixed or posted so that employees will be notified of what materials contain ACM and/or PACM. Warning signs shall be provided and displayed at all approaches to and inside regulated areas so that an employee may read the signs and take necessary protective steps before entering the area. The asbestos warning labels are to be readily visible and include the following warning:

**DANGER
ASBESTOS
MAY CAUSE CANCER
ASBESTOS CAUSES DAMAGE TO LUNGS
AUTHORIZED PERSONNEL ONLY**

The EPA requires asbestos inspections in school buildings in grades Kindergarten through 12 as part of the Asbestos Hazard Emergency Response Act (AHERA), which is authorized in 40 CFR 763.6. The AHERA sampling protocol addresses the systematic sample collection of all forms of ACM in addition to categorizing ACM materials as friable Category I or II non-friable. An AHERA Inspection must also evaluate the condition and the potential for disturbance of ACM. If asbestos is present within school facilities grades K-12, an Asbestos Management Plan is required by the Local Educational Authority (LEA) to be in place.

Along with AHERA, the EPA also regulates commercial asbestos abatement activities. A NESHAP notification must be submitted to the Oklahoma Department of Environmental Quality (ODEQ) ten-business days prior to the initiation of certain abatement/renovation and any demolition activities where ACM are present in quantities that meet or exceed 160-square feet (ft.²), 260-linear ft. or 35-cubic ft. (ft.³). Instructions regarding NESHAP notification requirements and ODEQ compliance are provided on the DEQ website: <http://www.deq.state.ok.us/aqdnew/asbestos/index.htm>. Land disposal requirements are also regulated by the EPA through State Landfill Permits. These efforts are now administered by the ODEQ Air Quality and Land Protection regulations. The ODEQ requires the advance filing of a NESHAP notification when any demolition or renovation

activities take place. The NESHAP notification process tracks abated ACM to an ODEQ approved landfill on a project-by-project basis.

The ODOL Asbestos Division regulates asbestos abatement by implementing the rules that govern the abatement of friable ACM. Under the ODOL asbestos rule, OAC 380:50, only adequately licensed contractors can perform asbestos abatement, develop management plans, and project designs. All abatement supervisors, abatement workers and asbestos inspectors must be licensed by the ODOL. The ODOL Rules are available on the ODOL web site: <http://www.ok.gov/odol/>.

LIMITATIONS OF SURVEY

This asbestos inspection was limited to certain aspects of the buildings construction. Certain limitations can restrict and/or prevent the complete inspection of hidden or inaccessible building materials. Furthermore, locations presenting a hazard to bystanders, or the inspector were not assessed. The findings resulting from this inspection are valid as of the date this inspection was performed. However, changes in the condition of a structure may certainly occur with the passage of time, whether due to natural processes or the works of man. Additionally, changes in applicable or appropriate standards may also occur possibly resulting from legislation or the expansion of knowledge.

Our investigation was conducted using the degree of care and skill ordinarily exercised by professional consultants under similar circumstances practicing in this or similar localities. Professional services have been performed; results associated with this inspection were obtained and reported in accordance with generally accepted principles and practices. No other representations, either expressed or implied, are made. Marshall Environmental Management, Incorporated is not responsible for independent conclusions, opinions or recommendations made by others. It should also be noted that as-built plans were not available for review or use in the planning of this asbestos inspection.

ATTACHMENTS

ANALYTICAL DATA

*CHAIN OF CUSTODY
ANALYTICAL REPORTS*

AREA DIAGRAM

ILLUSTRATING SAMPLING LOCATIONS

PHOTOGRAPHS

CERTIFICATION | LICENSURE



MARSHALL ENVIRONMENTAL MANAGEMENT, INC.

1301 N MARTIN LUTHER KING AVENUE
OKLAHOMA CITY, OK 73117
405.616.0401 | FAX: 405.681.6753 | MEM@marshallenvironmental.com
MARSHALL ENVIRONMENTAL MANAGEMENT, INC. www.marshallenvironmental.com

CHAIN OF CUSTODY

PROJECT INFORMATION				CONTACT INFORMATION				FUNGI			ASBESTOS		OTHER		
PROJECT ID. NO.	0168-AB-072221-J0			COMPANY	OK DEQ			TOTAL-AIRBORNE FUNGI (ENUMERATION & GENUS ID)	CULTURABLE AIRBORNE FUNGI (ENUMERATION & GENUS ID)	TOTAL-SURFACE FUNGI (SEMI-QUANTITATIVE ENUMERATION & GENUS ID)	AIRBORNE FIBER COUNT (NIOSH 7400)	BULK MATERIAL (EPA METHOD 600/R-93-116)			
PROJECT NAME	Hartshorne City Hall			ATTENTION	Heather Mallory										
ADDRESS	1101 Penn Avenue			ADDRESS	707 N Robinson Ave										
CITY STATE ZIP	Hartshorne OK 74547			CITY STATE ZIP	OKC OK 73102										
CONTACT	Elizabeth Wilson			PHONE NUMBER	405-702-5135										
PHONE NUMBER	918-297-2544			ALTERNATE NO.											
EMAIL ADDRESS				EMAIL ADDRESS	heather.mallory@deq.ok.gov										
SAMPLE TURN-AROUND-TIME				SAMPLE MATRIX / MEDIA											
<input checked="" type="checkbox"/> STANDARD (5-7 business)				<input type="checkbox"/> NEXT DAY				<input type="checkbox"/> SAME DAY				MP MOLD PLATE ST SPORE TRAP TL TAPE LIFT B BULK O OTHER			
SAMPLE IDENTIFICATION NUMBER				SAMPLE LOCATION / DESCRIPTION						TIME / UNITS / CONDITION					
LABID.	DATE COLLECTED	MATRIX/MEDIA	FIELD ID.												
0228	7/22/21	PLM	01	Room 11 - West wall texture						Good					
			02	Room 11 - wall texture - North											
			03	Room 12 - wall texture - South											
			04	Room 11 - Ceiling system - N											
			05	Room 11 - ↓ ↓ - W											
			06	Room 10 - Ceiling system - W											
			07	Room 2 - wall system - SW SE											
			08	Room 5 - wall system - SW											
			09	Room 5 - Ceiling system - E											
			10	Room 1 - wall system - N											
COLLECTED BY	Enego Onuche			DATE	7/22/21			RELINQUISHED BY	Celeste			DATE	7/23/21		
RECEIVED BY				TIME	1000pm			LABORATORY	accept			TIME	2pm		
IN LABORATORY				DATE	07/23/21			NOTES							
				TIME	1410										
FIELD NOTES				METHOD OF SHIPMENT				hand delivery				PAGE NUMBER 1 OF 5			



MARSHALL ENVIRONMENTAL MANAGEMENT, INC.

1301 N MARTIN LUTHER KING AVENUE

OKLAHOMA CITY, OK 73117

405.616.0401 | FAX: 405.681.6753 | MEM@marshallenvironmental.com

MARSHALL ENVIRONMENTAL MANAGEMENT, INC. www.marshallenvironmental.com

CHAIN OF CUSTODY

PROJECT INFORMATION				CONTACT INFORMATION				FUNGI		ASBESTOS	OTHER		
PROJECT ID. NO.				COMPANY				TOTAL-AIRBORNE FUNGI (ENUMERATION & GENUS ID)	CULTURABLE AIRBORNE FUNGI (ENUMERATION & GENUS ID)	TOTAL-SURFACE FUNGI (SEMI-QUANTITATIVE ENUMERATION & GENUS ID)	AIRBORNE FIBER COUNT (NIOSH 7400)	BULK MATERIAL (EPA METHOD 600/R-93-116)	
PROJECT NAME				ATTENTION									
ADDRESS				ADDRESS									
CITY STATE ZIP				CITY STATE ZIP									
CONTACT				PHONE NUMBER									
PHONE NUMBER				ALTERNATE NO.									
EMAIL ADDRESS				EMAIL ADDRESS									
SAMPLE TURN-AROUND-TIME				SAMPLE MATRIX / MEDIA									
<input checked="" type="checkbox"/> STANDARD (5-7 business)				<input type="checkbox"/> NEXT DAY				<input type="checkbox"/> SAME DAY					
<input type="checkbox"/> STANDARD				<input type="checkbox"/> MP MOLD PLATE	<input type="checkbox"/> ST SPORE TRAP	<input type="checkbox"/> TL TAPE LIFT	<input type="checkbox"/> B BULK	<input type="checkbox"/> O OTHER					
SAMPLE IDENTIFICATION NUMBER				SAMPLE LOCATION / DESCRIPTION				TIME / UNITS / CONDITION					
LAB ID.	DATE COLLECTED	MATRIX/MEDIA	FIELD ID.										
0228	7/22/21	PLM	11	Room 1 - Ceiling system-W				Good					
			12	Room 7 - Gwall system - S									
			13	Room 7 Ceiling system-W									
			14	Room 7 - 12x12 floor tile - N									
			15	↓ - NE									
			16	↓ - NW									
			17	Room 6 - wall system - East									
			18	↓ - SE									
			19	↓ - NE									
			20	Room 6 Ceiling system - N									
COLLECTED BY: Enejo Onuche				DATE: 7/22/21	RELINQUISHED BY: C. O. Orellana				DATE: 7/29/21				
RECEIVED BY: [Signature]				TIME: 1:30 PM	LABORATORY NOTES: [Signature]				TIME: 2 PM				
FIELD NOTES:				METHOD OF SHIPMENT: Hand delivery				PAGE NUMBER: 2 OF 6					



MARSHALL ENVIRONMENTAL MANAGEMENT, INC.

1301 N MARTIN LUTHER KING AVENUE

OKLAHOMA CITY, OK 73117

405.616.0401 | FAX: 405.681.6753 | MEM@marshallenvironmental.com

MARSHALL ENVIRONMENTAL MANAGEMENT, INC. www.marshallenvironmental.com

CHAIN OF CUSTODY

PROJECT INFORMATION				CONTACT INFORMATION				FUNGI		ASBESTOS	OTHER			
PROJECT ID. NO.				COMPANY				TOTAL-AIRBORNE FUNGI (ENUMERATION & GENUS ID)	CULTURABLE AIRBORNE FUNGI (ENUMERATION & GENUS ID)	TOTAL-SURFACE FUNGI (SEMI-QUANTITATIVE ENUMERATION & GENUS ID)	AIRBORNE FIBER COUNT (NIOSH 7400)	BULK MATERIAL (EPA METHOD 600/R-93-116)		
PROJECT NAME				ATTENTION										
ADDRESS				ADDRESS										
CITY STATE ZIP				CITY STATE ZIP										
CONTACT				PHONE NUMBER										
PHONE NUMBER				ALTERNATE NO.										
EMAIL ADDRESS				EMAIL ADDRESS										
SAMPLE TURN-AROUND-TIME				SAMPLE MATRIX / MEDIA										
<input checked="" type="checkbox"/> STANDARD (5-7 business)		NEXT DAY		SAME DAY										
				MP MOLD PLATE	ST SPORE TRAP	TL TAPE LIFT	B BULK	O OTHER						
SAMPLE IDENTIFICATION NUMBER				SAMPLE LOCATION / DESCRIPTION				TIME / UNITS / CONDITION						
LAB ID.	DATE COLLECTED	MATRIX/MEDIA	FIELD ID.											
0228	7/22/21	PLM	21	Room 6 - Ceiling system - W				GOOD						
			22	↓				↓ - S						
			23	Main Hallway - wall system - NW										
			24	Room 20 wall system - N										
			25	↓				↓ - W						
			26	↓				↓ - S						
			27	Room 20 Ceiling system - W										
			28	↓				↓ - S						
			29	↓				↓ - E						
			30	Room 19 wall system - E										
COLLECTED BY	Enejo Onuche			DATE	7/22/21		RELINQUISHED BY	Caleynell		DATE	7/23/21			
RECEIVED BY				TIME	10:10 AM		LABORATORY			TIME	2 PM			
IN LABORATORY				DATE	07/23/21		NOTES							
				TIME	1910									
FIELD NOTES					METHOD OF SHIPMENT				Hand delivery		PAGE NUMBER	3	OF	5



MARSHALL ENVIRONMENTAL MANAGEMENT, INC.

1301 N MARTIN LUTHER KING AVENUE

OKLAHOMA CITY, OK 73117

405.616.0401 | FAX: 405.681.6753 | MEM@marshallenvironmental.com

MARSHALL ENVIRONMENTAL MANAGEMENT, INC. www.marshallenvironmental.com

CHAIN OF CUSTODY

PROJECT INFORMATION				CONTACT INFORMATION				FUNGI		ASBESTOS	OTHER				
PROJECT ID. NO.				COMPANY				TOTAL-AIRBORNE FUNGI (ENUMERATION & GENUS ID)	CULTURABLE AIRBORNE FUNGI (ENUMERATION & GENUS ID)	TOTAL-SURFACE FUNGI (SEMI-QUANTITATIVE ENUMERATION & GENUS ID)	AIRBORNE FIBER COUNT (NIOSH 7400)	BULK MATERIAL (EPA METHOD 600/R-93-116)			
PROJECT NAME				ATTENTION											
ADDRESS	See page 1			ADDRESS	See page 1										
CITY STATE ZIP															
CONTACT															
PHONE NUMBER															
EMAIL ADDRESS															
PHONE NUMBER				ALTERNATE NO.											
EMAIL ADDRESS				EMAIL ADDRESS											
SAMPLE TURN-AROUND-TIME				SAMPLE MATRIX / MEDIA											
<input checked="" type="checkbox"/> STANDARD (5-7 business) <input type="checkbox"/> NEXT DAY <input type="checkbox"/> SAME DAY				<input type="checkbox"/> MP MOLD PLATE <input type="checkbox"/> ST SPORE TRAP <input type="checkbox"/> TL TAPE LIFT <input type="checkbox"/> B BULK <input type="checkbox"/> O OTHER											
SAMPLE IDENTIFICATION NUMBER				SAMPLE LOCATION / DESCRIPTION				TIME / UNITS / CONDITION							
LAB ID.	DATE COLLECTED	MATRIX/MEDIA	FIELD ID.												
0228	7/22/21	PLM	31	Room 19 - Wall System - W				Good						X	
			32	↓ - Ceiling System - N											
			33	Room 14 - wall system - East											
			34	Room 9 - wall system - W											
			35	↓ - ↓ - N											
			36	↓ - Ceiling system											
	7/23/21		37	Room 23 - wall system - North											
			38	↓ - South											
			39	↓ - SE											
			40	Room 23 - Ceiling insulation N											
COLLECTED BY		Enajo Onuche		DATE	7/23/21		RELINQUISHED BY	Callejuello		DATE	7/23/21				
RECEIVED BY				TIME	9:50 AM		LABORATORY			TIME	2 PM				
IN LABORATORY				DATE	07/23/21		NOTES	nem							
TIME				1410											
FIELD NOTES				METHOD OF SHIPMENT				Hand delivery		PAGE NUMBER		4 of 6			
										4		of 5			



1301 N MARTIN LUTHER KING AVENUE

OKLAHOMA CITY, OK 73117

405.616.0401 | FAX: 405.681.6753 | MEM@marshallenvironmental.com

MARSHALL ENVIRONMENTAL MANAGEMENT, INC. www.marshallenvironmental.com

[illegible]

PROJECT INFORMATION						CONTACT INFORMATION						FUNGUS		ASBESTOS		OTHER					
PROJECT ID. NO.						COMPANY						TOTAL AIRBORNE FUNGI (ENUMERATION & GENUS ID)		CULTURABLE AIRBORNE FUNGI (ENUMERATION & GENUS ID)		TOTAL SURFACE FUNGI (SEMI-QUANTITATIVE ENUMERATION & GENUS ID)		AIRBORNE FIBER COUNT (NIOSH 7400)		BULK MATERIAL (EPA METHOD 600/R-93-116)	
PROJECT NAME						ATTENTION															
ADDRESS						ADDRESS															
CITY STATE ZIP						CITY STATE ZIP															
CONTACT						PHONE NUMBER															
PHONE NUMBER						ALTERNATE NO.															
EMAIL ADDRESS						EMAIL ADDRESS															
SAMPLE TURN-AROUND-TIME						SAMPLE MATRIX / MEDIA															
<input checked="" type="checkbox"/> STANDARD (5-7 business days) <input type="checkbox"/> NEXT DAY <input type="checkbox"/> SAME DAY						<input type="checkbox"/> MP MOLD PLATE <input type="checkbox"/> ST SPORE TRAP <input type="checkbox"/> TL TAPE LIFT <input type="checkbox"/> B BULK <input type="checkbox"/> O OTHER _____															
SAMPLE IDENTIFICATION NUMBER				SAMPLE LOCATION / DESCRIPTION				TIME / UNITS / CONDITION													
LAB ID.	DATE COLLECTED	MATRIX/MEDIA	FIELD ID.																		
28	7/23/21	Plm	41	Room 23 - wall insulation - N				Good													
			42	Room 27 - wall insulation - N																	
			43	Room 24 Bathroom Shower Floorings																	
			44					-S													
			45					-W													
			46	Jail Cell Exterior window glass - N				Damage													
			47					-W													
			48					-S													
			49	Rm 5 Exterior window perimeter layer - N				Good													
			50					+E													
COLLECTED BY		Ernesto Oruche		DATE		7/23/21		RELINQUISHED BY		Olyne [Signature]		DATE		7/23/21							
RECEIVED BY		[Signature]		TIME		9:40 PM		LABORATORY		[Signature]		TIME		2 PM							
FIELD NOTES				DATE		07/22/21		NOTES		[Signature]											
				TIME		1410															
				METHOD OF SHIPMENT				Hand delivery				PAGE NUMBER				5 of 6					



405.616.0401 | FAX: 405.681.6753 | MEM@marshallenvironmental.com

CHAIN OF CUSTODY

PROJECT INFORMATION						CONTACT INFORMATION								FUNGI		ASBESTOS		OTHER	
PROJECT ID. NO.						COMPANY								TOTAL-AIRBORNE FUNGI (ENUMERATION & GENUS ID)	CULTURABLE AIRBORNE FUNGI (ENUMERATION & GENUS ID)	TOTAL-SURFACE FUNGI (SEMI-QUANTITATIVE ENUMERATION & GENUS ID)	AIRBORNE FIBER COUNT (NIOSH 7400)	BULK MATERIAL (EPA METHOD 600/R-93-116)	
PROJECT NAME						ATTENTION													
ADDRESS						ADDRESS													
CITY STATE ZIP						CITY STATE ZIP													
CONTACT						PHONE NUMBER													
PHONE NUMBER						ALTERNATE NO.													
EMAIL ADDRESS						EMAIL ADDRESS													
SAMPLE TURN-AROUND-TIME						SAMPLE MATRIX / MEDIA													
<input checked="" type="checkbox"/> STANDARD (5-7 business) <input type="checkbox"/> NEXT DAY <input type="checkbox"/> SAME DAY						<input type="checkbox"/> MP MOLD PLATE <input type="checkbox"/> ST SPORE TRAP <input type="checkbox"/> TL TAPE LIFT <input type="checkbox"/> B BULK <input type="checkbox"/> O OTHER _____													
SAMPLE IDENTIFICATION NUMBER						SAMPLE LOCATION / DESCRIPTION										TIME / UNITS / CONDITION			
LAB ID.	DATE COLLECTED	MATRIX/MEDIA	FIELD ID.																
0228	7/23/21	Pbm	50	RM 5 exterior window perimeter inspection GOOD															
↓	↓	↓	52	Exterior wall system - NW															
			53	- SW															
↓	↓	↓	54	- S															
COLLECTED BY		Energetic One One				DATE		7/23/21		RELINQUISHED BY		ceegmellu		DATE		7/23/21			
RECEIVED BY		[Signature]				TIME		11:00 AM		LABORATORY NOTES		[Signature]		TIME		2 PM			
FIELD NOTES						METHOD OF SHIPMENT		Hand delivery		PAGE NUMBER		6		OF		6			



MARSHALL ENVIRONMENTAL MANAGEMENT, INC.

1301 N MARTIN LUTHER KING AVENUE
OKLAHOMA CITY, OK 73117
405.616.0401 | FAX: 405.681.6753 | MEM@marshallenvironmental.com
www.marshallenvironmental.com

BULK ASBESTOS ANALYSIS

PROJECT INFORMATION		CONTACT INFORMATION	
PROJECT ID. NO.	0168-AB-072221-JO	COMPANY	OK DEQ
PROJECT NAME	Hartshorne City Hall	ATTENTION	Heather Mallory
ADDRESS	1101 Penn Avenue	ADDRESS	707 N Robinson Ave.
CITY STATE ZIP	Hartshorne, OK 74547	CITY STATE ZIP	Oklahoma City, OK 73102
SITE CONTACT	Elizabeth Wilson	PHONE NO.	405.702.5135
PHONE NO.	918.297.2544	ALTERNATE NO.	
EMAIL ADDRESS		EMAIL ADDRESS	heather.mallory@deq.ok.gov

SAMPLE ID. NO.	SAMPLE DESCRIPTION	COLOR	% ASBESTOS				% MATRIX			
0028-072221-PLM-01A	Texture	White	NO ASBESTOS DETECTED				90%	Calcium Carbonate		
							10%	Paint		
0028-072221-PLM-01B	Scratch Coat	Gray	NO ASBESTOS DETECTED				40%	Sand	20%	Quartz
							40%	Silica		
0028-072221-PLM-02	Scratch Coat	Gray	NO ASBESTOS DETECTED				40%	Sand	20%	Quartz
							40%	Silica		
0028-072221-PLM-03	Scratch Coat	Gray	NO ASBESTOS DETECTED				40%	Sand	20%	Quartz
							40%	Silica		
0028-072221-PLM-04	Ceiling Texture	White	NO ASBESTOS DETECTED				90%	Calcium Carbonate		
							10%	Paint		
0028-072221-PLM-05	Scratch Coat	Gray	NO ASBESTOS DETECTED				40%	Sand	20%	Quartz
							30%	Silica	10%	Paint
0028-072221-PLM-06A	Ceiling Texture	White	NO ASBESTOS DETECTED				90%	Calcium Carbonate		
							10%	Paint		
0028-072221-PLM-06B	Scratch Coat	Gray	NO ASBESTOS DETECTED				40%	Sand	20%	Quartz
							40%	Silica		
0028-072221-PLM-07A	Texture	White	NO ASBESTOS DETECTED				90%	Calcium Carbonate		
							10%	Paint		
0028-072221-PLM-07B	Tape	White	NO ASBESTOS DETECTED				100%	Cellulose		

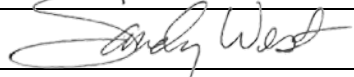
ANALYST NAME	Sandy West	ANALYST SIGNATURE		DATE ANALYZED	7/29/2021
ANALYTICAL METHODOLOGY	Test Methods: EPA/600/M4-82-020 as amended in 40 CFR, Part 763, Subpart E, Appendix E "Interim Method for determination of Asbestos in Bulk Insulation Samples", referred to as the US EPA 600/R-93/116 Method for the Determination of Asbestos in Bulk Building Materials by Polarized Light Microscopy (PLM).			LAB ACCREDITATION	American Industrial Hygiene Association (AIHA) Bulk Asbestos Proficiency Analytical Testing (BAPAT) Programs: Participant # 102334



MARSHALL ENVIRONMENTAL MANAGEMENT, INC.

1301 N MARTIN LUTHER KING AVENUE
OKLAHOMA CITY, OK 73117
405.616.0401 | FAX: 405.681.6753 | MEM@marshallenvironmental.com
www.marshallenvironmental.com

BULK ASBESTOS ANALYSIS

PROJECT INFORMATION				CONTACT INFORMATION			
PROJECT ID. NO.	0168-AB-072221-JO			COMPANY	OK DEQ		
PROJECT NAME	Hartshorne City Hall			ATTENTION	Heather Mallory		
ADDRESS	1101 Penn Avenue			ADDRESS	707 N Robinson Ave.		
CITY STATE ZIP	Hartshorne, OK 74547			CITY STATE ZIP	Oklahoma City, OK 73102		
SITE CONTACT	Elizabeth Wilson			PHONE NO.	405.702.5135		
PHONE NO.	918.297.2544			ALTERNATE NO.			
EMAIL ADDRESS				EMAIL ADDRESS	heather.mallory@deq.ok.gov		

SAMPLE ID. NO.	SAMPLE DESCRIPTION	COLOR	% ASBESTOS				% MATRIX			
0028-072221-PLM-07C	Joint Compound	White	NO ASBESTOS DETECTED				100%	Calcium Carbonate		
0028-072221-PLM-07D	Drywall	White	NO ASBESTOS DETECTED				85%	Gypsum		
							15%	Cellulose		
0028-072221-PLM-08A	Texture	White	NO ASBESTOS DETECTED				90%	Calcium Carbonate		
							10%	Paint		
0028-072221-PLM-08B	Tape	White	NO ASBESTOS DETECTED				100%	Cellulose		
0028-072221-PLM-08C	Joint Compound	White	NO ASBESTOS DETECTED				100%	Calcium Carbonate		
0028-072221-PLM-08D	Drywall	White	NO ASBESTOS DETECTED				85%	Gypsum		
							15%	Cellulose		
0028-072221-PLM-09A	Texture	White	NO ASBESTOS DETECTED				90%	Calcium Carbonate		
							10%	Paint		
0028-072221-PLM-09B	Tape	White	NO ASBESTOS DETECTED				100%	Cellulose		
0028-072221-PLM-09C	Joint Compound	White	NO ASBESTOS DETECTED				100%	Calcium Carbonate		
0028-072221-PLM-09D	Drywall	White	NO ASBESTOS DETECTED				85%	Gypsum		
							15%	Cellulose		

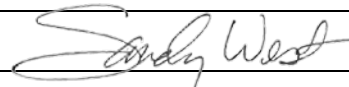
ANALYST NAME	Sandy West	ANALYST SIGNATURE		DATE ANALYZED	7/29/2021
ANALYTICAL METHODOLOGY	Test Methods: EPA/600/M4-82-020 as amended in 40 CFR, Part 763, Subpart E, Appendix E "Interim Method for determination of Asbestos in Bulk Insulation Samples", referred to as the US EPA 600/R-93/116 Method for the Determination of Asbestos in Bulk Building Materials by Polarized Light Microscopy (PLM).			LAB ACCREDITATION	American Industrial Hygiene Association (AIHA) Bulk Asbestos Proficiency Analytical Testing (BAPAT) Programs: Participant # 102334



MARSHALL ENVIRONMENTAL MANAGEMENT, INC.

1301 N MARTIN LUTHER KING AVENUE
OKLAHOMA CITY, OK 73117
405.616.0401 | FAX: 405.681.6753 | MEM@marshallenvironmental.com
www.marshallenvironmental.com

BULK ASBESTOS ANALYSIS

PROJECT INFORMATION		CONTACT INFORMATION	
PROJECT ID. NO.	0168-AB-072221-JO	COMPANY	OK DEQ
PROJECT NAME	Hartshorne City Hall	ATTENTION	Heather Mallory
ADDRESS	1101 Penn Avenue	ADDRESS	707 N Robinson Ave.
CITY STATE ZIP	Hartshorne, OK 74547	CITY STATE ZIP	Oklahoma City, OK 73102
SITE CONTACT	Elizabeth Wilson	PHONE NO.	405.702.5135
PHONE NO.	918.297.2544	ALTERNATE NO.	
EMAIL ADDRESS		EMAIL ADDRESS	heather.mallory@deq.ok.gov

SAMPLE ID. NO.	SAMPLE DESCRIPTION	COLOR	% ASBESTOS				% MATRIX			
0028-072221-PLM-10A	Texture	White	NO ASBESTOS DETECTED				90%	Calcium Carbonate		
							10%	Paint		
0028-072221-PLM-10B	Tape	White	NO ASBESTOS DETECTED				100%	Cellulose		
0028-072221-PLM-10C	Joint Compound	White	NO ASBESTOS DETECTED				100%	Calcium Carbonate		
0028-072221-PLM-10D	Drywall	White	NO ASBESTOS DETECTED				85%	Gypsum		
							15%	Cellulose		
0028-072221-PLM-11A	Texture	White	NO ASBESTOS DETECTED				90%	Calcium Carbonate		
							10%	Paint		
0028-072221-PLM-11B	Tape	White	NO ASBESTOS DETECTED				100%	Cellulose		
0028-072221-PLM-11C	Joint Compound	White	NO ASBESTOS DETECTED				100%	Calcium Carbonate		
0028-072221-PLM-11D	Drywall	White	NO ASBESTOS DETECTED				85%	Gypsum		
							15%	Cellulose		
0028-072221-PLM-12A	Texture	White	NO ASBESTOS DETECTED				90%	Calcium Carbonate		
							10%	Paint		
0028-072221-PLM-12B	Tape	White	NO ASBESTOS DETECTED				100%	Cellulose		

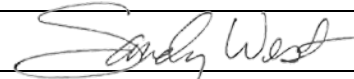
ANALYST NAME	Sandy West	ANALYST SIGNATURE		DATE ANALYZED	7/29/2021
ANALYTICAL METHODOLOGY	Test Methods: EPA/600/M4-82-020 as amended in 40 CFR, Part 763, Subpart E, Appendix E "Interim Method for determination of Asbestos in Bulk Insulation Samples", referred to as the US EPA 600/R-93/116 Method for the Determination of Asbestos in Bulk Building Materials by Polarized Light Microscopy (PLM).			LAB ACCREDITATION	American Industrial Hygiene Association (AIHA) Bulk Asbestos Proficiency Analytical Testing (BAPAT) Programs: Participant # 102334



MARSHALL ENVIRONMENTAL MANAGEMENT, INC.

1301 N MARTIN LUTHER KING AVENUE
OKLAHOMA CITY, OK 73117
405.616.0401 | FAX: 405.681.6753 | MEM@marshallenvironmental.com
www.marshallenvironmental.com

BULK ASBESTOS ANALYSIS

PROJECT INFORMATION				CONTACT INFORMATION			
PROJECT ID. NO.	0168-AB-072221-JO			COMPANY	OK DEQ		
PROJECT NAME	Hartshorne City Hall			ATTENTION	Heather Mallory		
ADDRESS	1101 Penn Avenue			ADDRESS	707 N Robinson Ave.		
CITY STATE ZIP	Hartshorne, OK 74547			CITY STATE ZIP	Oklahoma City, OK 73102		
SITE CONTACT	Elizabeth Wilson			PHONE NO.	405.702.5135		
PHONE NO.	918.297.2544			ALTERNATE NO.			
EMAIL ADDRESS				EMAIL ADDRESS	heather.mallory@deq.ok.gov		

SAMPLE ID. NO.	SAMPLE DESCRIPTION	COLOR	% ASBESTOS				% MATRIX			
0028-072221-PLM-12C	Joint Compound	White		NO ASBESTOS DETECTED			100%	Calcium Carbonate		
0028-072221-PLM-12D	Drywall	White		NO ASBESTOS DETECTED			85%	Gypsum		
							15%	Cellulose		
0028-072221-PLM-13A	Texture	White		NO ASBESTOS DETECTED			90%	Calcium Carbonate		
							10%	Paint		
0028-072221-PLM-13B	Tape	White		NO ASBESTOS DETECTED			100%	Cellulose		
0028-072221-PLM-13C	Joint Compound	White		NO ASBESTOS DETECTED			100%	Calcium Carbonate		
0028-072221-PLM-14D	Drywall	White		NO ASBESTOS DETECTED			85%	Gypsum		
							15%	Cellulose		
0028-072221-PLM-14A	Floor Tile	Tan	5%	Chrysotile			95%	Vinyl Aggregate		
0028-072221-PLM-14B	Mastic	Black	7%	Chrysotile			93%	Tar		
0028-072221-PLM-15A	Floor Tile	Tan	5%	Chrysotile			95%	Vinyl Aggregate		
0028-072221-PLM-15B	Mastic	Black	7%	Chrysotile			93%	Tar		

ANALYST NAME	Sandy West	ANALYST SIGNATURE		DATE ANALYZED	7/29/2021
ANALYTICAL METHODOLOGY	Test Methods: EPA/600/M4-82-020 as amended in 40 CFR, Part 763, Subpart E, Appendix E "Interim Method for determination of Asbestos in Bulk Insulation Samples", referred to as the US EPA 600/R-93/116 Method for the Determination of Asbestos in Bulk Building Materials by Polarized Light Microscopy (PLM).				LAB ACCREDITATION
					American Industrial Hygiene Association (AIHA) Bulk Asbestos Proficiency Analytical Testing (BAPAT) Programs: Participant # 102334



MARSHALL ENVIRONMENTAL MANAGEMENT, INC.

1301 N MARTIN LUTHER KING AVENUE
OKLAHOMA CITY, OK 73117
405.616.0401 | FAX: 405.681.6753 | MEM@marshallenvironmental.com
www.marshallenvironmental.com

BULK ASBESTOS ANALYSIS

PROJECT INFORMATION				CONTACT INFORMATION			
PROJECT ID. NO.	0168-AB-072221-JO			COMPANY	OK DEQ		
PROJECT NAME	Hartshorne City Hall			ATTENTION	Heather Mallory		
ADDRESS	1101 Penn Avenue			ADDRESS	707 N Robinson Ave.		
CITY STATE ZIP	Hartshorne, OK 74547			CITY STATE ZIP	Oklahoma City, OK 73102		
SITE CONTACT	Elizabeth Wilson			PHONE NO.	405.702.5135		
PHONE NO.	918.297.2544			ALTERNATE NO.			
EMAIL ADDRESS				EMAIL ADDRESS	heather.mallory@deq.ok.gov		

SAMPLE ID. NO.	SAMPLE DESCRIPTION	COLOR	% ASBESTOS				% MATRIX			
0028-072221-PLM-16A	Floor Tile	Tan	5%	Chrysotile			95%	Vinyl Aggregate		
0028-072221-PLM-16B	Mastic	Black	7%	Chrysotile			93%	Tar		
0028-072221-PLM-17A	Texture	White	NO ASBESTOS DETECTED				90%	Calcium Carbonate		
							10%	Paint		
0028-072221-PLM-17B	Tape	White	NO ASBESTOS DETECTED				100%	Cellulose		
0028-072221-PLM-17C	Joint Compound	White	NO ASBESTOS DETECTED				100%	Calcium Carbonate		
0028-072221-PLM-17D	Drywall	White	NO ASBESTOS DETECTED				85%	Gypsum		
							15%	Cellulose		
0028-072221-PLM-18A	Texture	White	NO ASBESTOS DETECTED				90%	Calcium Carbonate		
							10%	Paint		
0028-072221-PLM-18B	Tape	White	NO ASBESTOS DETECTED				100%	Cellulose		
0028-072221-PLM-18C	Joint Compound	White	NO ASBESTOS DETECTED				100%	Calcium Carbonate		
0028-072221-PLM-18D	Drywall	White	NO ASBESTOS DETECTED				85%	Gypsum		
							15%	Cellulose		

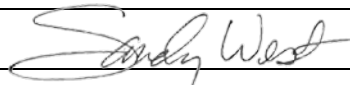
ANALYST NAME	Sandy West	ANALYST SIGNATURE		DATE ANALYZED	7/29/2021
ANALYTICAL METHODOLOGY	Test Methods: EPA/600/M4-82-020 as amended in 40 CFR, Part 763, Subpart E, Appendix E "Interim Method for determination of Asbestos in Bulk Insulation Samples", referred to as the US EPA 600/R-93/116 Method for the Determination of Asbestos in Bulk Building Materials by Polarized Light Microscopy (PLM).			LAB ACCREDITATION	American Industrial Hygiene Association (AIHA) Bulk Asbestos Proficiency Analytical Testing (BAPAT) Programs: Participant # 102334



MARSHALL ENVIRONMENTAL MANAGEMENT, INC.

1301 N MARTIN LUTHER KING AVENUE
OKLAHOMA CITY, OK 73117
405.616.0401 | FAX: 405.681.6753 | MEM@marshallenvironmental.com
www.marshallenvironmental.com

BULK ASBESTOS ANALYSIS

PROJECT INFORMATION		CONTACT INFORMATION	
PROJECT ID. NO.	0168-AB-072221-JO	COMPANY	OK DEQ
PROJECT NAME	Hartshorne City Hall	ATTENTION	Heather Mallory
ADDRESS	1101 Penn Avenue	ADDRESS	707 N Robinson Ave.
CITY STATE ZIP	Hartshorne, OK 74547	CITY STATE ZIP	Oklahoma City, OK 73102
SITE CONTACT	Elizabeth Wilson	PHONE NO.	405.702.5135
PHONE NO.	918.297.2544	ALTERNATE NO.	
EMAIL ADDRESS		EMAIL ADDRESS	heather.mallory@deq.ok.gov

SAMPLE ID. NO.	SAMPLE DESCRIPTION	COLOR	% ASBESTOS				% MATRIX			
0028-072221-PLM-19A	Texture	White	NO ASBESTOS DETECTED				90%	Calcium Carbonate		
							10%	Paint		
0028-072221-PLM-19B	Tape	White	NO ASBESTOS DETECTED				100%	Cellulose		
0028-072221-PLM-19C	Joint Compound	White	NO ASBESTOS DETECTED				100%	Calcium Carbonate		
0028-072221-PLM-19D	Drywall	White	NO ASBESTOS DETECTED				85%	Gypsum		
							15%	Cellulose		
0028-072221-PLM-20A	Texture	White	NO ASBESTOS DETECTED				90%	Calcium Carbonate		
							10%	Paint		
0028-072221-PLM-20B	Tape	White	NO ASBESTOS DETECTED				100%	Cellulose		
0028-072221-PLM-20C	Joint Compound	White	NO ASBESTOS DETECTED				100%	Calcium Carbonate		
0028-072221-PLM-20D	Drywall	White	NO ASBESTOS DETECTED				85%	Gypsum		
							15%	Cellulose		
0028-072221-PLM-21A	Texture	White	NO ASBESTOS DETECTED				90%	Calcium Carbonate		
							10%	Paint		
0028-072221-PLM-21B	Tape	White	NO ASBESTOS DETECTED				100%	Cellulose		

ANALYST NAME	Sandy West	ANALYST SIGNATURE		DATE ANALYZED	7/29/2021
ANALYTICAL METHODOLOGY	Test Methods: EPA/600/M4-82-020 as amended in 40 CFR, Part 763, Subpart E, Appendix E "Interim Method for determination of Asbestos in Bulk Insulation Samples", referred to as the US EPA 600/R-93/116 Method for the Determination of Asbestos in Bulk Building Materials by Polarized Light Microscopy (PLM).			LAB ACCREDITATION	American Industrial Hygiene Association (AIHA) Bulk Asbestos Proficiency Analytical Testing (BAPAT) Programs: Participant # 102334



MARSHALL ENVIRONMENTAL MANAGEMENT, INC.

1301 N MARTIN LUTHER KING AVENUE
OKLAHOMA CITY, OK 73117
405.616.0401 | FAX: 405.681.6753 | MEM@marshallenvironmental.com
www.marshallenvironmental.com

BULK ASBESTOS ANALYSIS

PROJECT INFORMATION				CONTACT INFORMATION			
PROJECT ID. NO.	0168-AB-072221-JO			COMPANY	OK DEQ		
PROJECT NAME	Hartshorne City Hall			ATTENTION	Heather Mallory		
ADDRESS	1101 Penn Avenue			ADDRESS	707 N Robinson Ave.		
CITY STATE ZIP	Hartshorne, OK 74547			CITY STATE ZIP	Oklahoma City, OK 73102		
SITE CONTACT	Elizabeth Wilson			PHONE NO.	405.702.5135		
PHONE NO.	918.297.2544			ALTERNATE NO.			
EMAIL ADDRESS				EMAIL ADDRESS	heather.mallory@deq.ok.gov		

SAMPLE ID. NO.	SAMPLE DESCRIPTION	COLOR	% ASBESTOS				% MATRIX					
			NO ASBESTOS DETECTED									
0028-072221-PLM-21C	Joint Compound	White					100%	Calcium Carbonate				
0028-072221-PLM-21D	Drywall	White					85%	Gypsum				
							15%	Cellulose				
0028-072221-PLM-22A	Texture	White					90%	Calcium Carbonate				
							10%	Paint				
0028-072221-PLM-22B	Tape	White					100%	Cellulose				
0028-072221-PLM-22C	Joint Compound	White					100%	Calcium Carbonate				
0028-072221-PLM-22D	Drywall	White					85%	Gypsum				
							15%	Cellulose				
0028-072221-PLM-23A	Texture	White					90%	Calcium Carbonate				
							10%	Paint				
0028-072221-PLM-23B	Drywall	White					85%	Gypsum				
							15%	Cellulose				
0028-072221-PLM-24A	Texture	White					90%	Calcium Carbonate				
							10%	Paint				
0028-072221-PLM-24B	Drywall	White					85%	Gypsum				
							15%	Cellulose				

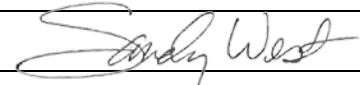
ANALYST NAME	Sandy West	ANALYST SIGNATURE		DATE ANALYZED	7/29/2021
ANALYTICAL METHODOLOGY	Test Methods: EPA/600/M4-82-020 as amended in 40 CFR, Part 763, Subpart E, Appendix E "Interim Method for determination of Asbestos in Bulk Insulation Samples", referred to as the US EPA 600/R-93/116 Method for the Determination of Asbestos in Bulk Building Materials by Polarized Light Microscopy (PLM).			LAB ACCREDITATION	American Industrial Hygiene Association (AIHA) Bulk Asbestos Proficiency Analytical Testing (BAPAT) Programs: Participant # 102334



MARSHALL ENVIRONMENTAL MANAGEMENT, INC.

1301 N MARTIN LUTHER KING AVENUE
OKLAHOMA CITY, OK 73117
405.616.0401 | FAX: 405.681.6753 | MEM@marshallenvironmental.com
www.marshallenvironmental.com

BULK ASBESTOS ANALYSIS

PROJECT INFORMATION		CONTACT INFORMATION	
PROJECT ID. NO.	0168-AB-072221-JO	COMPANY	OK DEQ
PROJECT NAME	Hartshorne City Hall	ATTENTION	Heather Mallory
ADDRESS	1101 Penn Avenue	ADDRESS	707 N Robinson Ave.
CITY STATE ZIP	Hartshorne, OK 74547	CITY STATE ZIP	Oklahoma City, OK 73102
SITE CONTACT	Elizabeth Wilson	PHONE NO.	405.702.5135
PHONE NO.	918.297.2544	ALTERNATE NO.	
EMAIL ADDRESS		EMAIL ADDRESS	heather.mallory@deq.ok.gov

SAMPLE ID. NO.	SAMPLE DESCRIPTION	COLOR	% ASBESTOS				% MATRIX				
0028-072221-PLM-25A	Texture	White	NO ASBESTOS DETECTED				90%	Calcium Carbonate			
							10%	Paint			
0028-072221-PLM-25B	Tape	White	NO ASBESTOS DETECTED				100%	Cellulose			
0028-072221-PLM-25C	Joint Compound	White	NO ASBESTOS DETECTED				100%	Calcium Carbonate			
0028-072221-PLM-25D	Drywall	White	NO ASBESTOS DETECTED				85%	Gypsum			
							15%	Cellulose			
0028-072221-PLM-26	Texture	White	NO ASBESTOS DETECTED				90%	Calcium Carbonate			
							10%	Paint			
0028-072221-PLM-27A	Texture	White	NO ASBESTOS DETECTED				90%	Calcium Carbonate			
							10%	Paint			
0028-072221-PLM-27B	Tape	White	NO ASBESTOS DETECTED				100%	Cellulose			
0028-072221-PLM-27C	Joint Compound	White	NO ASBESTOS DETECTED				100%	Calcium Carbonate			
0028-072221-PLM-27D	Drywall	White	NO ASBESTOS DETECTED				85%	Gypsum			
							15%	Cellulose			
0028-072221-PLM-28A	Texture	White	NO ASBESTOS DETECTED				90%	Calcium Carbonate			
							10%	Paint			

ANALYST NAME	Sandy West	ANALYST SIGNATURE		DATE ANALYZED	7/29/2021
ANALYTICAL METHODOLOGY	Test Methods: EPA/600/M4-82-020 as amended in 40 CFR, Part 763, Subpart E, Appendix E "Interim Method for determination of Asbestos in Bulk Insulation Samples", referred to as the US EPA 600/R-93/116 Method for the Determination of Asbestos in Bulk Building Materials by Polarized Light Microscopy (PLM).			LAB ACCREDITATION	American Industrial Hygiene Association (AIHA) Bulk Asbestos Proficiency Analytical Testing (BAPAT) Programs: Participant # 102334



MARSHALL ENVIRONMENTAL MANAGEMENT, INC.

1301 N MARTIN LUTHER KING AVENUE
OKLAHOMA CITY, OK 73117
405.616.0401 | FAX: 405.681.6753 | MEM@marshallenvironmental.com
www.marshallenvironmental.com

BULK ASBESTOS ANALYSIS

PROJECT INFORMATION		CONTACT INFORMATION	
PROJECT ID. NO.	0168-AB-072221-JO	COMPANY	OK DEQ
PROJECT NAME	Hartshorne City Hall	ATTENTION	Heather Mallory
ADDRESS	1101 Penn Avenue	ADDRESS	707 N Robinson Ave.
CITY STATE ZIP	Hartshorne, OK 74547	CITY STATE ZIP	Oklahoma City, OK 73102
SITE CONTACT	Elizabeth Wilson	PHONE NO.	405.702.5135
PHONE NO.	918.297.2544	ALTERNATE NO.	
EMAIL ADDRESS		EMAIL ADDRESS	heather.mallory@deq.ok.gov

SAMPLE ID. NO.	SAMPLE DESCRIPTION	COLOR	% ASBESTOS				% MATRIX			
0028-072221-PLM-28B	Tape	White	NO ASBESTOS DETECTED				100%	Cellulose		
0028-072221-PLM-28C	Joint Compound	White	NO ASBESTOS DETECTED				100%	Calcium Carbonate		
0028-072221-PLM-28D	Drywall	White	NO ASBESTOS DETECTED				85%	Gypsum		
							15%	Cellulose		
0028-072221-PLM-29A	Texture	White	NO ASBESTOS DETECTED				90%	Calcium Carbonate		
							10%	Paint		
0028-072221-PLM-29B	Drywall	White	NO ASBESTOS DETECTED				85%	Gypsum		
							15%	Cellulose		
0028-072221-PLM-30A	Texture	White	NO ASBESTOS DETECTED				90%	Calcium Carbonate		
							10%	Paint		
0028-072221-PLM-30B	Tape	White	NO ASBESTOS DETECTED				100%	Cellulose		
0028-072221-PLM-30C	Joint Compound	White	NO ASBESTOS DETECTED				100%	Calcium Carbonate		
0028-072221-PLM-30D	Drywall	White	NO ASBESTOS DETECTED				85%	Gypsum		
							15%	Cellulose		
0028-072221-PLM-31A	Texture	White	NO ASBESTOS DETECTED				90%	Calcium Carbonate		
							10%	Paint		

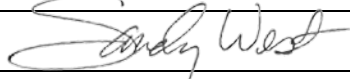
ANALYST NAME	Sandy West	ANALYST SIGNATURE		DATE ANALYZED	7/29/2021
ANALYTICAL METHODOLOGY	Test Methods: EPA/600/M4-82-020 as amended in 40 CFR, Part 763, Subpart E, Appendix E "Interim Method for determination of Asbestos in Bulk Insulation Samples", referred to as the US EPA 600/R-93/116 Method for the Determination of Asbestos in Bulk Building Materials by Polarized Light Microscopy (PLM).			LAB ACCREDITATION	American Industrial Hygiene Association (AIHA) Bulk Asbestos Proficiency Analytical Testing (BAPAT) Programs: Participant # 102334



MARSHALL ENVIRONMENTAL MANAGEMENT, INC.

1301 N MARTIN LUTHER KING AVENUE
OKLAHOMA CITY, OK 73117
405.616.0401 | FAX: 405.681.6753 | MEM@marshallenvironmental.com
www.marshallenvironmental.com

BULK ASBESTOS ANALYSIS

PROJECT INFORMATION		CONTACT INFORMATION	
PROJECT ID. NO.	0168-AB-072221-JO	COMPANY	OK DEQ
PROJECT NAME	Hartshorne City Hall	ATTENTION	Heather Mallory
ADDRESS	1101 Penn Avenue	ADDRESS	707 N Robinson Ave.
CITY STATE ZIP	Hartshorne, OK 74547	CITY STATE ZIP	Oklahoma City, OK 73102
SITE CONTACT	Elizabeth Wilson	PHONE NO.	405.702.5135
PHONE NO.	918.297.2544	ALTERNATE NO.	
EMAIL ADDRESS		EMAIL ADDRESS	heather.mallory@deq.ok.gov

SAMPLE ID. NO.	SAMPLE DESCRIPTION	COLOR	% ASBESTOS				% MATRIX			
0028-072221-PLM-31B	Drywall	White	NO ASBESTOS DETECTED				85%	Gypsum		
							15%	Cellulose		
0028-072221-PLM-32A	Texture	White	NO ASBESTOS DETECTED				90%	Calcium Carbonate		
							10%	Paint		
0028-072221-PLM-32B	Tape	White	NO ASBESTOS DETECTED				100%	Cellulose		
0028-072221-PLM-32C	Joint Compound	White	NO ASBESTOS DETECTED				100%	Calcium Carbonate		
0028-072221-PLM-32D	Drywall	White	NO ASBESTOS DETECTED				85%	Gypsum		
							15%	Cellulose		
0028-072221-PLM-33A	Texture	White	NO ASBESTOS DETECTED				90%	Calcium Carbonate		
							10%	Paint		
0028-072221-PLM-33B	Tape	White	NO ASBESTOS DETECTED				100%	Cellulose		
0028-072221-PLM-33C	Joint Compound	White	NO ASBESTOS DETECTED				100%	Calcium Carbonate		
0028-072221-PLM-34A	Texture	White	NO ASBESTOS DETECTED				90%	Calcium Carbonate		
							10%	Paint		
0028-072221-PLM-34B	Drywall	White	NO ASBESTOS DETECTED				85%	Gypsum		
							15%	Cellulose		

ANALYST NAME	Sandy West	ANALYST SIGNATURE		DATE ANALYZED	7/29/2021
ANALYTICAL METHODOLOGY	Test Methods: EPA/600/M4-82-020 as amended in 40 CFR, Part 763, Subpart E, Appendix E "Interim Method for determination of Asbestos in Bulk Insulation Samples", referred to as the US EPA 600/R-93/116 Method for the Determination of Asbestos in Bulk Building Materials by Polarized Light Microscopy (PLM).			LAB ACCREDITATION	American Industrial Hygiene Association (AIHA) Bulk Asbestos Proficiency Analytical Testing (BAPAT) Programs: Participant # 102334



MARSHALL ENVIRONMENTAL MANAGEMENT, INC.

1301 N MARTIN LUTHER KING AVENUE
OKLAHOMA CITY, OK 73117
405.616.0401 | FAX: 405.681.6753 | MEM@marshallenvironmental.com
www.marshallenvironmental.com

BULK ASBESTOS ANALYSIS

PROJECT INFORMATION				CONTACT INFORMATION			
PROJECT ID. NO.	0168-AB-072221-JO			COMPANY	OK DEQ		
PROJECT NAME	Hartshorne City Hall			ATTENTION	Heather Mallory		
ADDRESS	1101 Penn Avenue			ADDRESS	707 N Robinson Ave.		
CITY STATE ZIP	Hartshorne, OK 74547			CITY STATE ZIP	Oklahoma City, OK 73102		
SITE CONTACT	Elizabeth Wilson			PHONE NO.	405.702.5135		
PHONE NO.	918.297.2544			ALTERNATE NO.			
EMAIL ADDRESS				EMAIL ADDRESS	heather.mallory@deq.ok.gov		

SAMPLE ID. NO.	SAMPLE DESCRIPTION	COLOR	% ASBESTOS				% MATRIX			
0028-072221-PLM-35A	Texture	White	NO ASBESTOS DETECTED				90%	Calcium Carbonate		
							10%	Paint		
0028-072221-PLM-35B	Tape	White	NO ASBESTOS DETECTED				100%	Cellulose		
0028-072221-PLM-35C	Joint Compound	White	NO ASBESTOS DETECTED				100%	Calcium Carbonate		
0028-072221-PLM-35D	Drywall	White	NO ASBESTOS DETECTED				85%	Gypsum		
							15%	Cellulose		
0028-072221-PLM-36A	Texture	White	NO ASBESTOS DETECTED				90%	Calcium Carbonate		
							10%	Paint		
0028-072221-PLM-36B	Tape	White	NO ASBESTOS DETECTED				100%	Cellulose		
0028-072221-PLM-36C	Joint Compound	White	NO ASBESTOS DETECTED				100%	Calcium Carbonate		
0028-072221-PLM-36D	Drywall	White	NO ASBESTOS DETECTED				85%	Gypsum		
							15%	Cellulose		
0028-072221-PLM-37	Drywall	White	NO ASBESTOS DETECTED				85%	Gypsum		
							15%	Cellulose		
0028-072221-PLM-38A	Texture	White	NO ASBESTOS DETECTED				90%	Calcium Carbonate		
							10%	Paint		

ANALYST NAME	Sandy West	ANALYST SIGNATURE		DATE ANALYZED	7/29/2021
ANALYTICAL METHODOLOGY	Test Methods: EPA/600/M4-82-020 as amended in 40 CFR, Part 763, Subpart E, Appendix E "Interim Method for determination of Asbestos in Bulk Insulation Samples", referred to as the US EPA 600/R-93/116 Method for the Determination of Asbestos in Bulk Building Materials by Polarized Light Microscopy (PLM).			LAB ACCREDITATION	American Industrial Hygiene Association (AIHA) Bulk Asbestos Proficiency Analytical Testing (BAPAT) Programs: Participant # 102334



MARSHALL ENVIRONMENTAL MANAGEMENT, INC.

1301 N MARTIN LUTHER KING AVENUE
OKLAHOMA CITY, OK 73117
405.616.0401 | FAX: 405.681.6753 | MEM@marshallenvironmental.com
www.marshallenvironmental.com

BULK ASBESTOS ANALYSIS

PROJECT INFORMATION		CONTACT INFORMATION	
PROJECT ID. NO.	0168-AB-072221-JO	COMPANY	OK DEQ
PROJECT NAME	Hartshorne City Hall	ATTENTION	Heather Mallory
ADDRESS	1101 Penn Avenue	ADDRESS	707 N Robinson Ave.
CITY STATE ZIP	Hartshorne, OK 74547	CITY STATE ZIP	Oklahoma City, OK 73102
SITE CONTACT	Elizabeth Wilson	PHONE NO.	405.702.5135
PHONE NO.	918.297.2544	ALTERNATE NO.	
EMAIL ADDRESS		EMAIL ADDRESS	heather.mallory@deq.ok.gov

SAMPLE ID. NO.	SAMPLE DESCRIPTION	COLOR	% ASBESTOS				% MATRIX			
0028-072221-PLM-38B	Tape	White	NO ASBESTOS DETECTED				100%	Cellulose		
0028-072221-PLM-38C	Joint Compound	White	NO ASBESTOS DETECTED				100%	Calcium Carbonate		
0028-072221-PLM-38D	Drywall	White	NO ASBESTOS DETECTED				85%	Gypsum		
							15%	Cellulose		
0028-072221-PLM-39A	Texture	White	NO ASBESTOS DETECTED				90%	Calcium Carbonate		
							10%	Paint		
0028-072221-PLM-39B	Drywall	White	NO ASBESTOS DETECTED				85%	Gypsum		
							15%	Cellulose		
0028-072221-PLM-40A	Wrap	Cream	NO ASBESTOS DETECTED				100%	Vinyl		
0028-072221-PLM-40B	Insulation	Yellow	NO ASBESTOS DETECTED				100%	Fibrous Glass		
0028-072221-PLM-41A	Wrap	Cream	NO ASBESTOS DETECTED				100%	Vinyl		
0028-072221-PLM-41B	Insulation	Yellow	NO ASBESTOS DETECTED				100%	Fibrous Glass		
0028-072221-PLM-42A	Wrap	Cream	NO ASBESTOS DETECTED				100%	Vinyl		

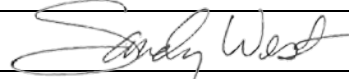
ANALYST NAME	Sandy West	ANALYST SIGNATURE		DATE ANALYZED	7/29/2021
ANALYTICAL METHODOLOGY	Test Methods: EPA/600/M4-82-020 as amended in 40 CFR, Part 763, Subpart E, Appendix E "Interim Method for determination of Asbestos in Bulk Insulation Samples", referred to as the US EPA 600/R-93/116 Method for the Determination of Asbestos in Bulk Building Materials by Polarized Light Microscopy (PLM).			LAB ACCREDITATION	American Industrial Hygiene Association (AIHA) Bulk Asbestos Proficiency Analytical Testing (BAPAT) Programs: Participant # 102334



MARSHALL ENVIRONMENTAL MANAGEMENT, INC.

1301 N MARTIN LUTHER KING AVENUE
OKLAHOMA CITY, OK 73117
405.616.0401 | FAX: 405.681.6753 | MEM@marshallenvironmental.com
www.marshallenvironmental.com

BULK ASBESTOS ANALYSIS

PROJECT INFORMATION				CONTACT INFORMATION			
PROJECT ID. NO.	0168-AB-072221-JO			COMPANY	OK DEQ		
PROJECT NAME	Hartshorne City Hall			ATTENTION	Heather Mallory		
ADDRESS	1101 Penn Avenue			ADDRESS	707 N Robinson Ave.		
CITY STATE ZIP	Hartshorne, OK 74547			CITY STATE ZIP	Oklahoma City, OK 73102		
SITE CONTACT	Elizabeth Wilson			PHONE NO.	405.702.5135		
PHONE NO.	918.297.2544			ALTERNATE NO.			
EMAIL ADDRESS				EMAIL ADDRESS	heather.mallory@deq.ok.gov		

SAMPLE ID. NO.	SAMPLE DESCRIPTION	COLOR	% ASBESTOS				% MATRIX			
0028-072221-PLM-42B	Insulation	Yellow	NO ASBESTOS DETECTED				100%	Fibrous Glass		
0028-072221-PLM-43A	Floor Tile	Blue/Gray	NO ASBESTOS DETECTED				100%	Vinyl Aggregate		
0028-072221-PLM-43B	Mastic	Light Yellow	NO ASBESTOS DETECTED				100%	Adhesive		
0028-072221-PLM-44A	Floor Tile	Blue/Gray	NO ASBESTOS DETECTED				100%	Vinyl Aggregate		
0028-072221-PLM-44B	Mastic	Yellow	NO ASBESTOS DETECTED				100%	Adhesive		
0028-072221-PLM-45A	Floor Tile	Blue/Gray	NO ASBESTOS DETECTED				100%	Vinyl Aggregate		
0028-072221-PLM-45B	Mastic	Yellow	NO ASBESTOS DETECTED				100%	Adhesive		
0028-072221-PLM-46	Window Caulk	Light Gray	NO ASBESTOS DETECTED				90%	Aggregate		
							10%	Paint		
0028-072221-PLM-47	Window Caulk	Light Gray	NO ASBESTOS DETECTED				90%	Aggregate		
							10%	Paint		
0028-072221-PLM-48	Window Caulk	Light Gray	NO ASBESTOS DETECTED				90%	Aggregate		
							10%	Paint		

ANALYST NAME	Sandy West			ANALYST SIGNATURE				DATE ANALYZED	7/29/2021
ANALYTICAL METHODOLOGY	Test Methods: EPA/600/M4-82-020 as amended in 40 CFR, Part 763, Subpart E, Appendix E "Interim Method for determination of Asbestos in Bulk Insulation Samples", referred to as the US EPA 600/R-93/116 Method for the Determination of Asbestos in Bulk Building Materials by Polarized Light Microscopy (PLM).						LAB ACCREDITATION	American Industrial Hygiene Association (AIHA) Bulk Asbestos Proficiency Analytical Testing (BAPAT) Programs: Participant # 102334	



MARSHALL ENVIRONMENTAL MANAGEMENT, INC.

1301 N MARTIN LUTHER KING AVENUE
OKLAHOMA CITY, OK 73117
405.616.0401 | FAX: 405.681.6753 | MEM@marshallenvironmental.com
www.marshallenvironmental.com

BULK ASBESTOS ANALYSIS

PROJECT INFORMATION		CONTACT INFORMATION	
PROJECT ID. NO.	0168-AB-072221-JO	COMPANY	OK DEQ
PROJECT NAME	Hartshorne City Hall	ATTENTION	Heather Mallory
ADDRESS	1101 Penn Avenue	ADDRESS	707 N Robinson Ave.
CITY STATE ZIP	Hartshorne, OK 74547	CITY STATE ZIP	Oklahoma City, OK 73102
SITE CONTACT	Elizabeth Wilson	PHONE NO.	405.702.5135
PHONE NO.	918.297.2544	ALTERNATE NO.	
EMAIL ADDRESS		EMAIL ADDRESS	heather.mallory@deq.ok.gov

SAMPLE ID. NO.	SAMPLE DESCRIPTION	COLOR	% ASBESTOS				% MATRIX			
0028-072221-PLM-49	Transite	Light Gray	NO ASBESTOS DETECTED				95%	Aggregate		
							5%	Cellulose		
0028-072221-PLM-50	Transite	Light Gray	NO ASBESTOS DETECTED				95%	Aggregate		
							5%	Cellulose		
0028-072221-PLM-51	Transite	Light Gray	NO ASBESTOS DETECTED				95%	Aggregate		
							5%	Cellulose		
0028-072221-PLM-52	Scratch Coat	Gray	NO ASBESTOS DETECTED				40%	Sand	20%	Quartz
							30%	Silica	10%	Paint
0028-072221-PLM-53	Scratch Coat	Gray	NO ASBESTOS DETECTED				40%	Sand	20%	Quartz
							30%	Silica	10%	Paint
0028-072221-PLM-54	Scratch Coat	Gray	NO ASBESTOS DETECTED				40%	Sand	20%	Quartz
							30%	Silica	10%	Paint

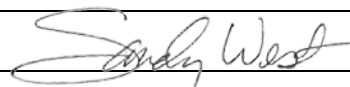
ANALYST NAME	Sandy West	ANALYST SIGNATURE		DATE ANALYZED	7/29/2021
ANALYTICAL METHODOLOGY	Test Methods: EPA/600/M4-82-020 as amended in 40 CFR, Part 763, Subpart E, Appendix E "Interim Method for determination of Asbestos in Bulk Insulation Samples", referred to as the US EPA 600/R-93/116 Method for the Determination of Asbestos in Bulk Building Materials by Polarized Light Microscopy (PLM).			LAB ACCREDITATION	American Industrial Hygiene Association (AIHA) Bulk Asbestos Proficiency Analytical Testing (BAPAT) Programs: Participant # 102334

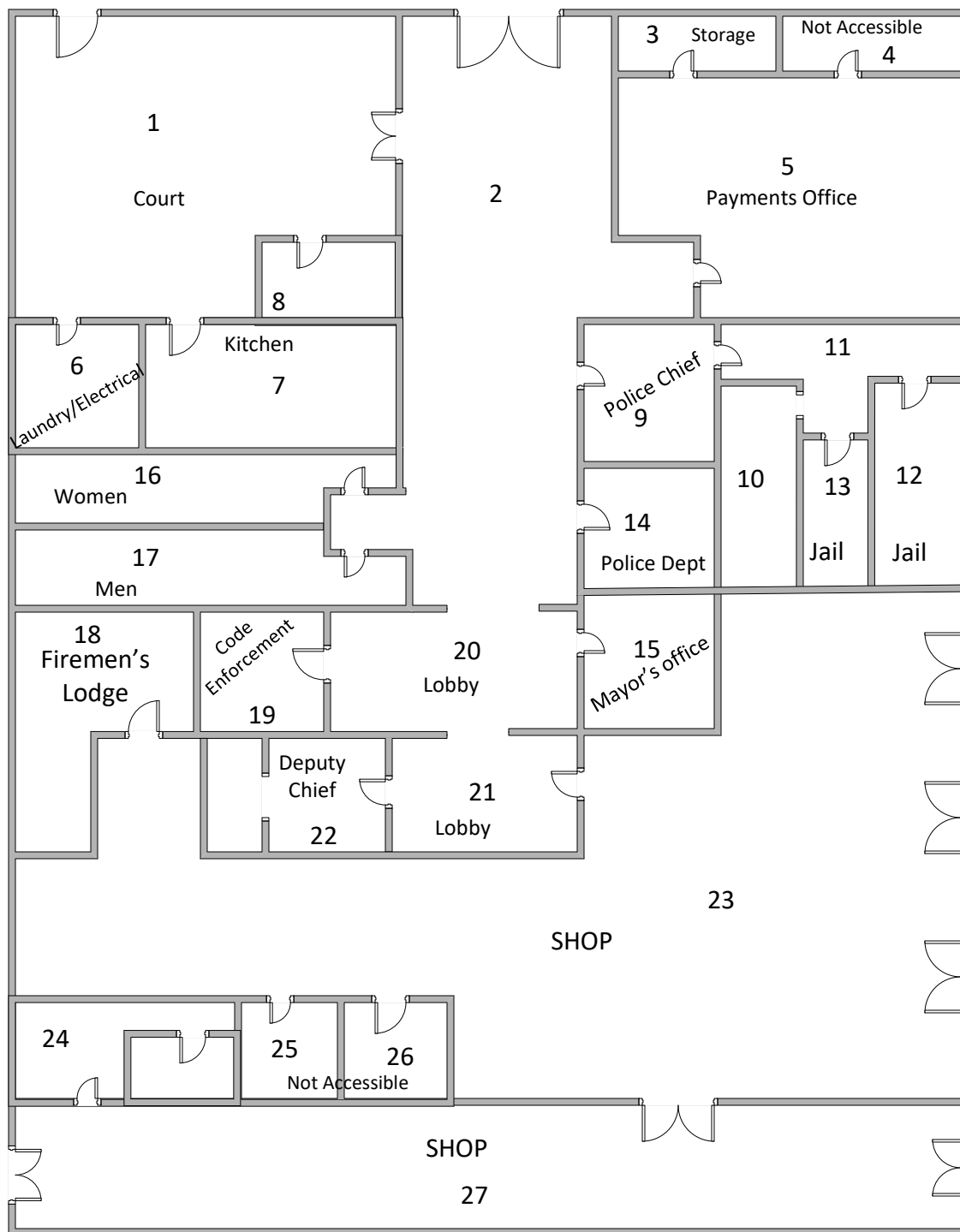

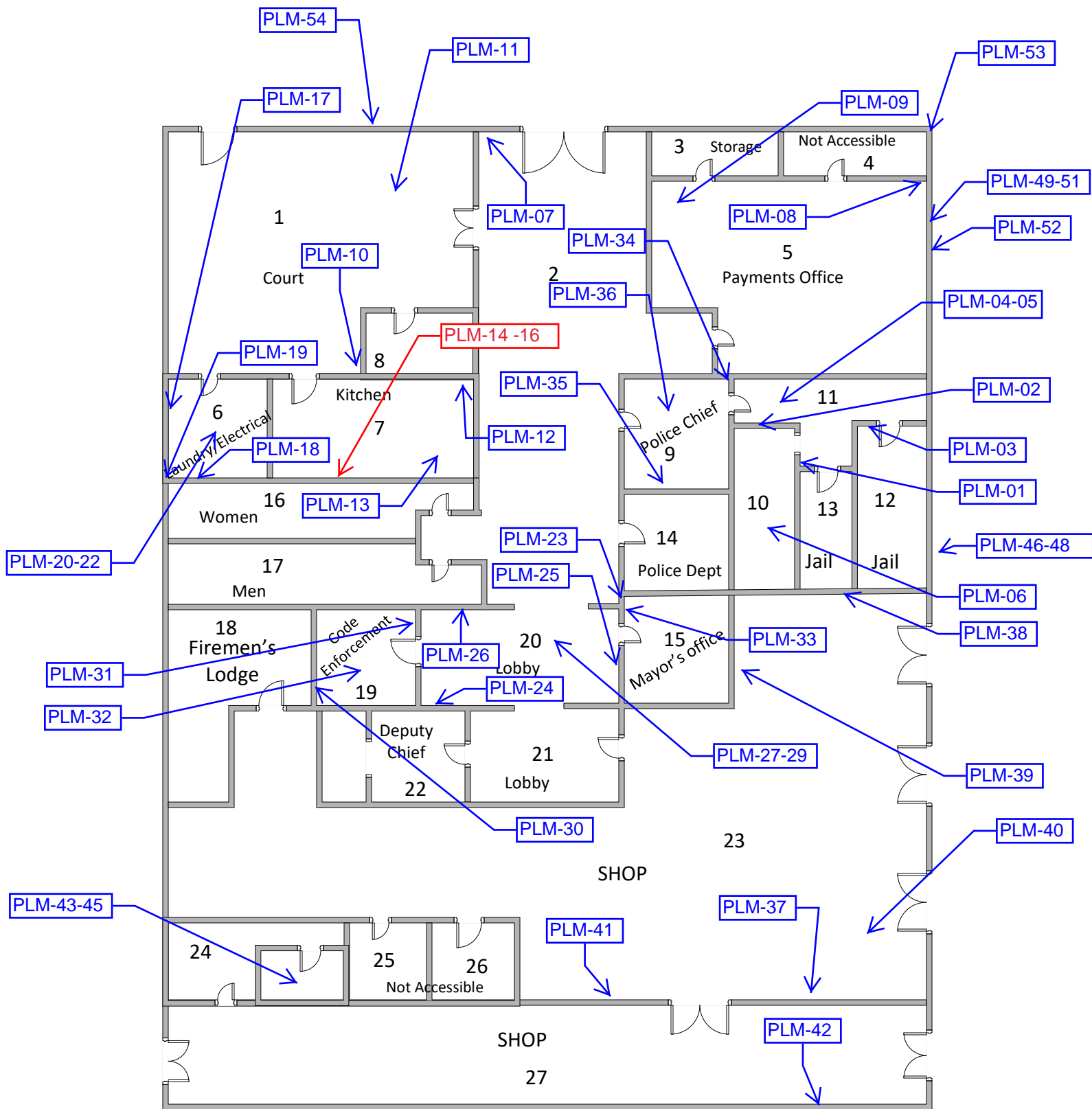

SAMPLE LOCATIONS

HARTSHORNE CITY HALL
1101 PENN AVENUE
HARTSHORNE, OK 74547

ACM Floor tile and mastic (ACM mastic is assumed to be underneath ceramic tiles throughout the kitchen)



ACM LOCATIONS
HARTSHORNE CITY HALL
1101 PENN AVENUE
HARTSHORNE, OK 74547

3
FIGURE

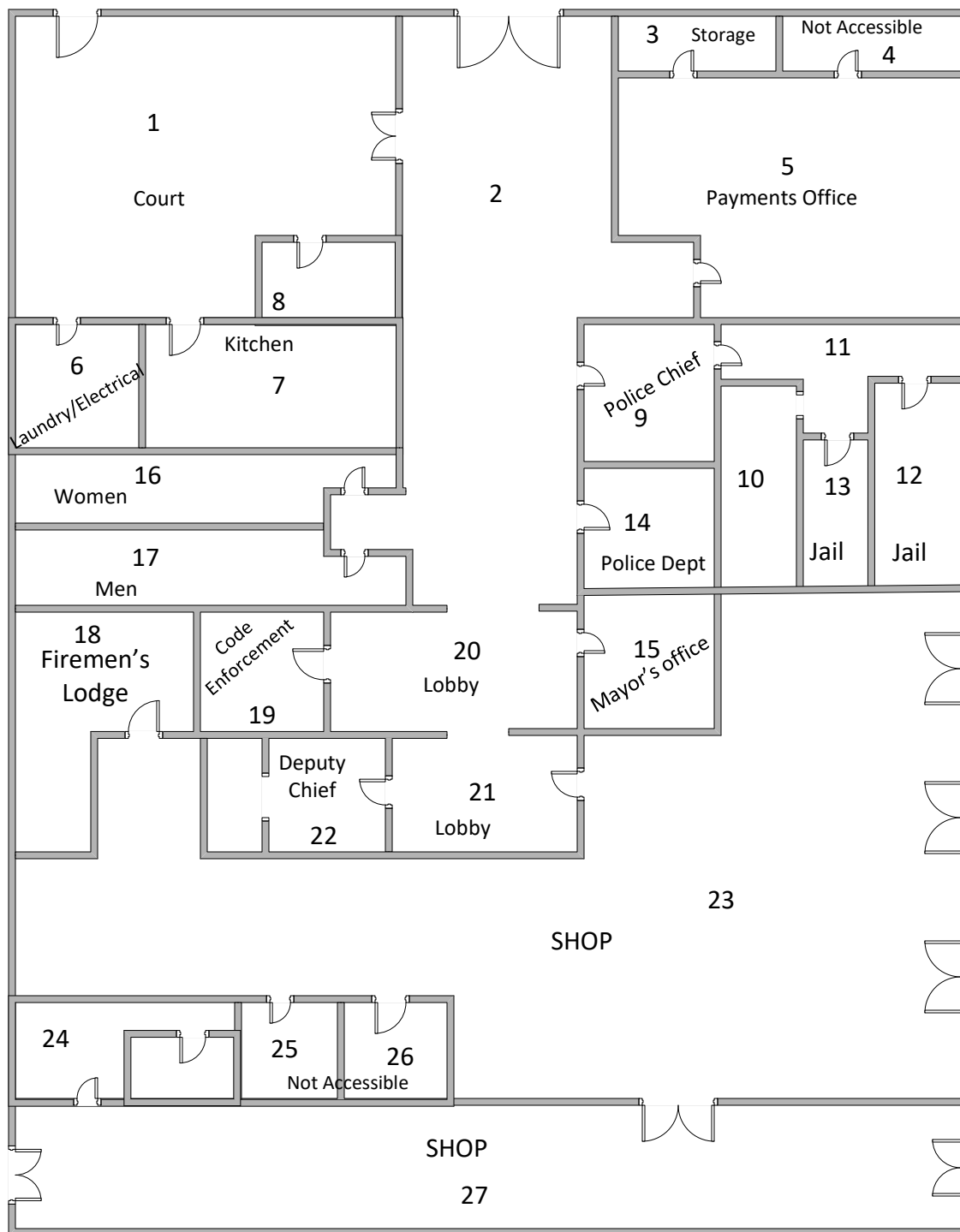

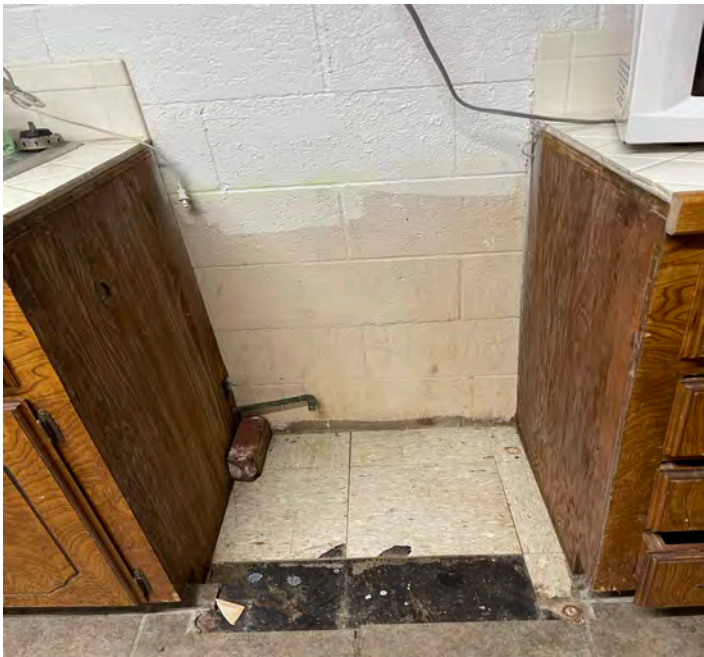

Room 7 (Kitchen): ACM Floor tile and black mastic

Oklahoma Department of Labor

Asbestos License

This certifies that Enejo Onuche
has successfully met the certification requirements under
the Oklahoma Asbestos Control Act 40 O.S. § 450, et seq.
Abatement of Friable Asbestos Materials Rules OAC
380:50 in the following:

Inspector



Leslie Osborn
Labor Commissioner



License # : 401505

Expires : 06/16/2022

Issued : 06/22/2021

Not intended for identification purposes

Oklahoma Department of Labor

Asbestos License

This certifies that **Jamie Marshall**
has successfully met the certification requirements under
the Oklahoma Asbestos Control Act 40 O.S. § 450, et seq.
Abatement of Friable Asbestos Materials Rules OAC
380:50 in the following:

Management Planner



Leslie Osborn

Leslie Osborn
Labor Commissioner

License # : 400477

Expires : 03/10/2022

Issued : 03/18/2021

Not intended for identification purposes

Scope of Work

STATEMENT OF WORK

For

Asbestos Abatement at the Hartshorne City Hall

The Oklahoma Department of Environmental Quality (DEQ) is requesting a work plan and cost estimate for remediation services at City Hall located in Hartshorne, Oklahoma. This statement of work (SOW) describes the removal and proper disposal of asbestos-containing material (ACM). A mandatory pre-bid site visit and walk through will be held at the site.

The building is located at 1101 Pennsylvania Ave, Hartshorne, OK, 74547. The building will have available water and electricity to use during remediation.

SPECIAL PROVISIONS:

- Work Schedule: The contractor shall schedule all work to be completed within 30 calendar days after date of the written “Notice to Proceed.” Coordination of work shall be scheduled with DEQ.
 - A pre-construction meeting shall be held at the site if deemed necessary after the Notice to Proceed date to review Statement of Work and answer any questions the contractor may have.
 - All on-site work shall be completed by the contractor five (5) days prior to the scheduled contract completion date, with the remaining five (5) days utilized for final inspection and correction of all deficiencies.
- Conditions of Work: The following conditions of work will apply in accomplishment of this contract:
 - All work shall be performed in accordance with all applicable State and Federal regulations.
 - All work shall be performed in such a manner that it does not put workers’ health and safety at risk.
 - Disposal of Removed Materials: All materials removed by the Contractor under this contract shall be disposed of in accordance with State and Federal regulations.

CONTRACTOR SHALL:

- Attend mandatory pre-bid meeting and site walk through;
- Follow all appropriate OSHA requirements;

Submit with Bid:

- Copy of ODOL Asbestos Abatement Contractor License;
- Three references with name, type of project, phone number, and location of similar work in the last three years;

Submit after Notice to Proceed:

- A Work Plan with planned activities and schedule to DEQ for approval;

ASBESTOS ABATEMENT INSTRUCTIONS:

- The following non-friable Asbestos Containing Material (ACM) shall be removed as listed in the Asbestos Inspection Report (**Attachment 1**).
 - Approximately 280 square feet of floor tile and mastic (5-7% Chrysotile)
- Once Asbestos Abatement is complete, DEQ shall be contacted for final inspection to confirm abatement has been appropriately performed and all asbestos has been removed.

FINAL REPORT:

Write final report and submit to DEQ;

- Final report shall include:
 - A detailed summary of work including any warranties and data;
 - Waste manifests (if any); and
 - Photo documentation of work
 - Photo documentation of work will have color digital photos with captions describing photo;
- Final report will be submitted electronically.

DEQ CONTACT:

Trenton Wilhelm
Oklahoma Dept of Environmental Quality
Land Protection Division
707 N. Robinson
P.O. Box 1677
Oklahoma City, OK 73101-1677

Phone Numbers:

405-702-5108 (Office)

405-702-5101 (Fax)

Trenton.Wilhelm@deq.ok.gov

ATTACHMENT 1

Asbestos Inspection Report

Remediation Reports