

OHCETA

Simulation Conference

“Clinical Judgment: More Than Just Simulation”

May 17th, 2022

Moore-Norman Technology Center-South Penn Campus
13301 S Pennsylvania Ave., OKC, OK 73170

Presented by:

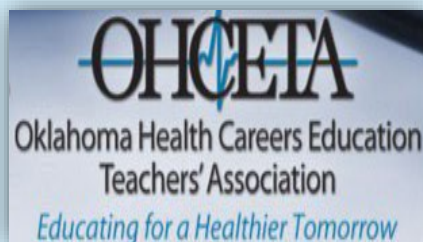

Who Should Attend?

Those responsible for training and evaluating nurses,
emergency responders, allied health professionals, and any
healthcare professional in
either an academic or practice setting.

REGISTER HERE:

<https://ohcwc.wufoo.com/forms/ohceta-2022-simulation-conference/>

Keynote

“Clinical Judgment: In the Classroom and Beyond”

Karin J. Sherrill, MSN, RN, CNE, CHSE, ANEF, FAADN



Karin is passionate about faculty development, student success, and using clinical judgment as a teaching pedagogy. Her teaching experience has spanned over three decades and included Associate Degree and BSN completion programs. She has developed courses and facilitated traditional, hybrid, Online, lab, simulation, and clinical classrooms. As an educator, she has been involved with a plethora of projects including informatics, Next Gen NCLEX®, scrambled teaching strategies, test, and item writing, and the

integration of classroom, lab, and simulation technologies. She has co-authored several books and products for NurseTim®, Inc. Karin chairs the Maricopa Nursing Testing and Student Success Committees and is a past president of the Arizona League for Nursing. She was the founding president of the Arizona Simulation Network. In addition to facilitating consultations with NurseTim® Inc., consulting work includes the National League for Nurses Testing Services, National Council State Board of Nursing, and several publishing companies. In her spare time, Karin and her family have discovered a love and commitment for serving and supporting the people of Leogane, Haiti.

Agenda

8:30a-9:00a	Registration Check-In
9:00a-9:10a	Welcome, Introductions, Review Agenda
9:10a-10:00a	Keynote: "Clinical Judgment"-Karin Sherrill
10:00a-10:15a	Break
10:15a-11:10a	Keynote: "Clinical Judgment"- Karin Sherrill
11:10a-12:45p	Lunch Presentation: TeamSTEPPS- S Scott Atkinson
12:45p-1:00p	Break
1:00p-1:50p	Breakout Sessions: <ul style="list-style-type: none">• <i>Laerdal Simulators</i>-Bud Abbott• <i>Gaumard Simulators</i>• <i>Clinical Judgment: Hands-On Session</i>-Karin Sherrill• <i>Moulage</i>-Josie Scott• <i>INACSL Standards</i>-Nichole Jackson
1:50p-2:00p	Break
2:00p-2:50p	Breakout Sessions: <ul style="list-style-type: none">• <i>Laerdal Simulators</i>-Bud Abbott• <i>Gaumard Simulators</i>• <i>Simulation Certification</i> -S Scott Atkinson• <i>Debriefing Models</i>-Nichole Jackson• <i>Panel-Simulation in other Healthcare fields</i>
2:50p-3:00p	Break
3:00p-3:45p	Final thoughts/resources - wrap up Q&A
3:45p-4:00p	Wrap Up, Survey, Certificates

Session Information:

KEYNOTE ADDRESS:

“Clinical Judgment: In the Classroom and Beyond”

Karin J. Sherrill, MSN, RN, CNE, CHSE, ANEF, FAADN (Nurse Tim ®)

The purpose of this keynote is to present an overview of clinical judgment, discuss strategies for using simulation in the classroom to facilitate clinical judgment, assist those in both academia and clinical settings to use simulation in building clinical judgment skills.

Lunch Session:

TeamSteps Presentation: “Communication”

*S Scott Atkinson, Lead Simulation Technology Operations Specialist
SimGhosts Representative TeamSteps Educator*

The purpose of this lunch presentation is to educate and equip all healthcare professionals to communicate with one another effectively and efficiently in a non-hostile, non-judgmental manner. This will be presented during our lunch break.

Breakout Sessions:

“Bringing Clinical to the Classroom.”

Karin J. Sherrill, MSN, RN, CNE, CHSE, ANEF, FAADN (Nurse Tim ®)

The purpose of this workshop is to assist those in academia to bring clinical into the classroom. Understanding that simulation and clinical judgment is not for clinical alone but needs to be used in the classroom setting as well. This is an interactive, hands-on experience.

“Hands-on Training with an Expert”

Bud Abbott, Laerdal Client Executive II

The purpose of this workshop is to allow for hands-on training with real simulators. This will be designed so that both novice and experienced alike, will be able to learn something. This will also be a great opportunity to see the new products coming out from Laerdal.

“Training with Gaumard Experts”

Gaumard

The purpose of this workshop is to allow for hands-on training with real simulators. This will be a great opportunity to work with product experts and fellow healthcare professionals. This will be interactive and will be designed for both novices and experienced participants.

“Moulage”

Josie Scott, RN, MSN, M. Ed

This interactive, hands-on workshop will give you tips and tricks from a simulation expert on ways to enhance realism in simulation using moulage. It will cover ideas that are useful for nursing, respiratory therapy, EMS, CNA/CMA, and more!

“INACSL Healthcare Simulation Standards: Not just for nurses”

Nichole Jackson, DNP, MSN, RN, CNE, CHSE

INACSL has updated its simulation standards and updated the verbiage of the standards to include all healthcare, not just nursing. Not only did they update the name, but two new standards were added. What does this mean for the simulation community? How can you make sure your program is meeting all these standards? What if I do not even know what INACSL is? This workshop can help you with all these questions and more.

“What certification is right for me?”

S Scott Atkinson. Lead Simulation Technology Operations Specialist. SimGhosts Representative. TeamStepps Educator.

As simulation continues to grow in popularity for use in healthcare, the need for standardized national certifications will also increase. There are several simulation certifications available, but how do you know which one is right for you? Scott will review the different types of certifications and what each certification has to offer.

“Debriefing Models: Which one is right for your organization?” Nichole Jackson, DNP, MSN, RN, CNE, CHSE

There are several different debriefing models available, so how do you choose which one is right for your program? Dr. Jackson will review the different models and discuss the pros and cons of each. This will be interactive and will give hands-on experience with the different models.

Panel Discussion: “Finally, something for me!!!”

Dustin Hicks, MSN, RN (Moderator)

This panel is comprised of professionals that use simulation well outside of nursing. It includes surgical techs, respiratory therapy, CNA/CMA, EMS, and those in clinical education positions outside of academia. Hear from experts in your own profession discussing methods they have used for simulation that work.

Location Address

Moore-Norman Technology Ctr. (South Penn campus)
13301 S. Pennsylvania Ave. Oklahoma City, OK 73170
(405) 364-5763

Directions

Southbound & Northbound from I-35:

Take Exit 117 at SW 4th St, Moore, then travel west
Approximately 3 miles to SW 134th and S. Pennsylvania.
The street name changes from SW 4th in Moore to
SW 134th Street in Oklahoma City.

Southbound & Northbound on I-44:

Take Exit 110 at SW 134th St. Travel east 2.5 miles to SW 134th and
S. Pennsylvania. The campus is located on the northwest corner.

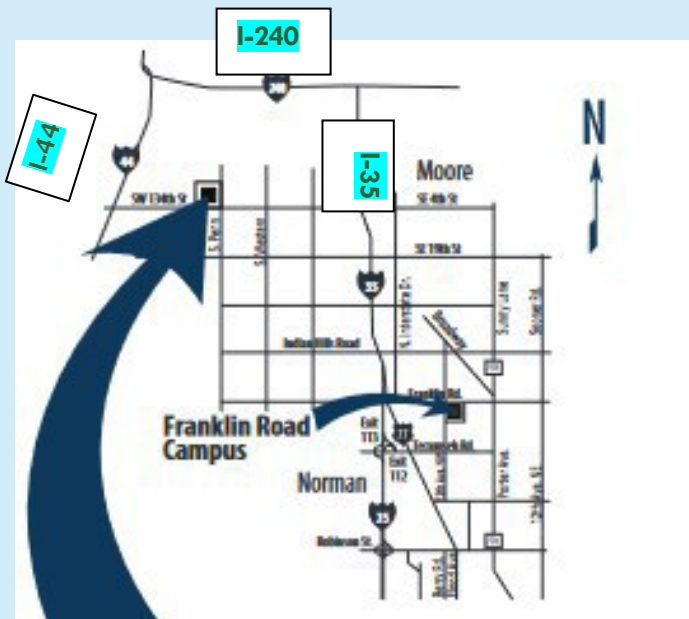

Parking and Campus Maps

Attendees can park in north or west parking lots (See **red** circles on map).

Registration will be on the 1st Floor of the Main Building, Lower Level in the Conference Center (See **yellow** circle on map).

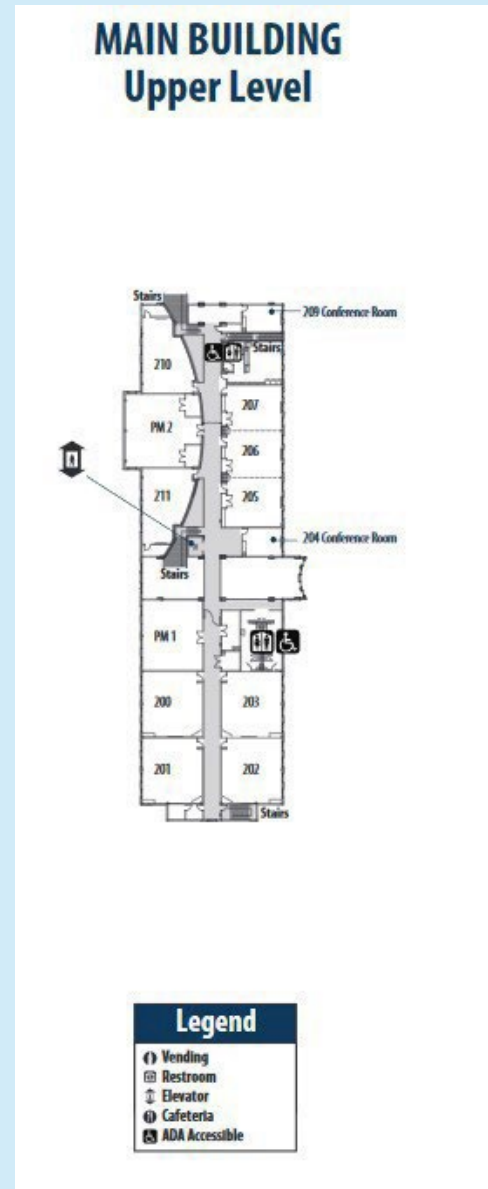
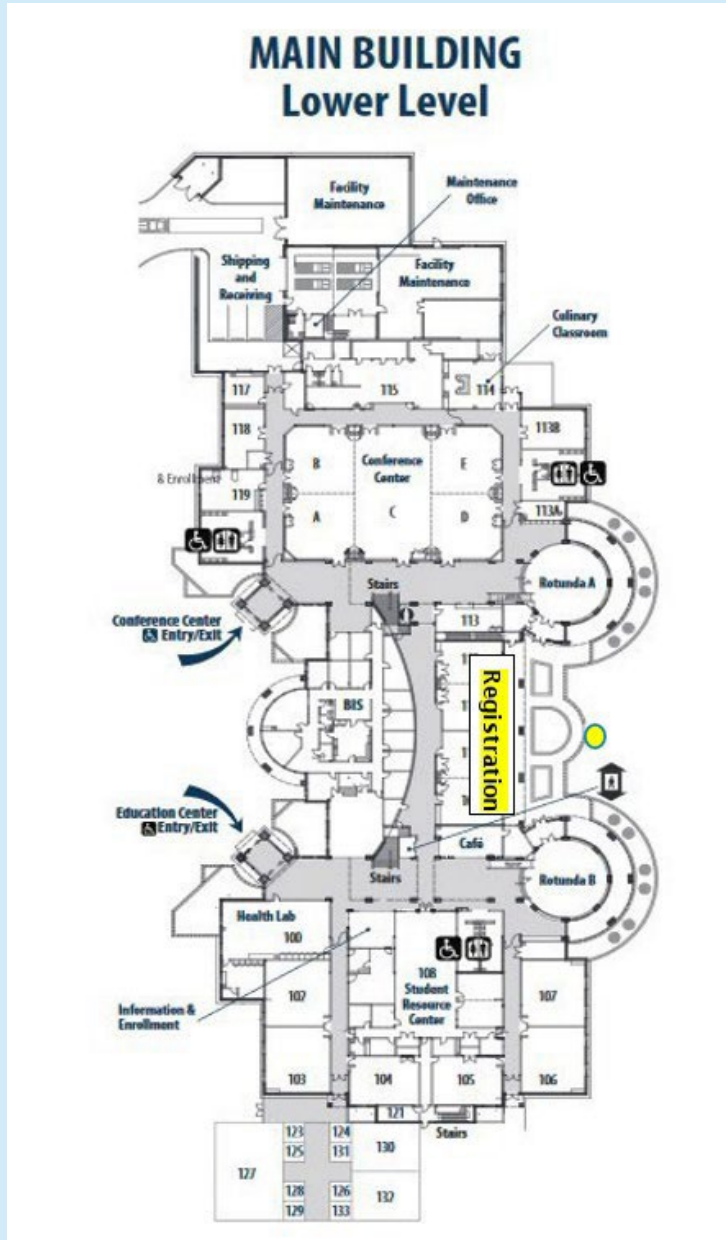

Parking

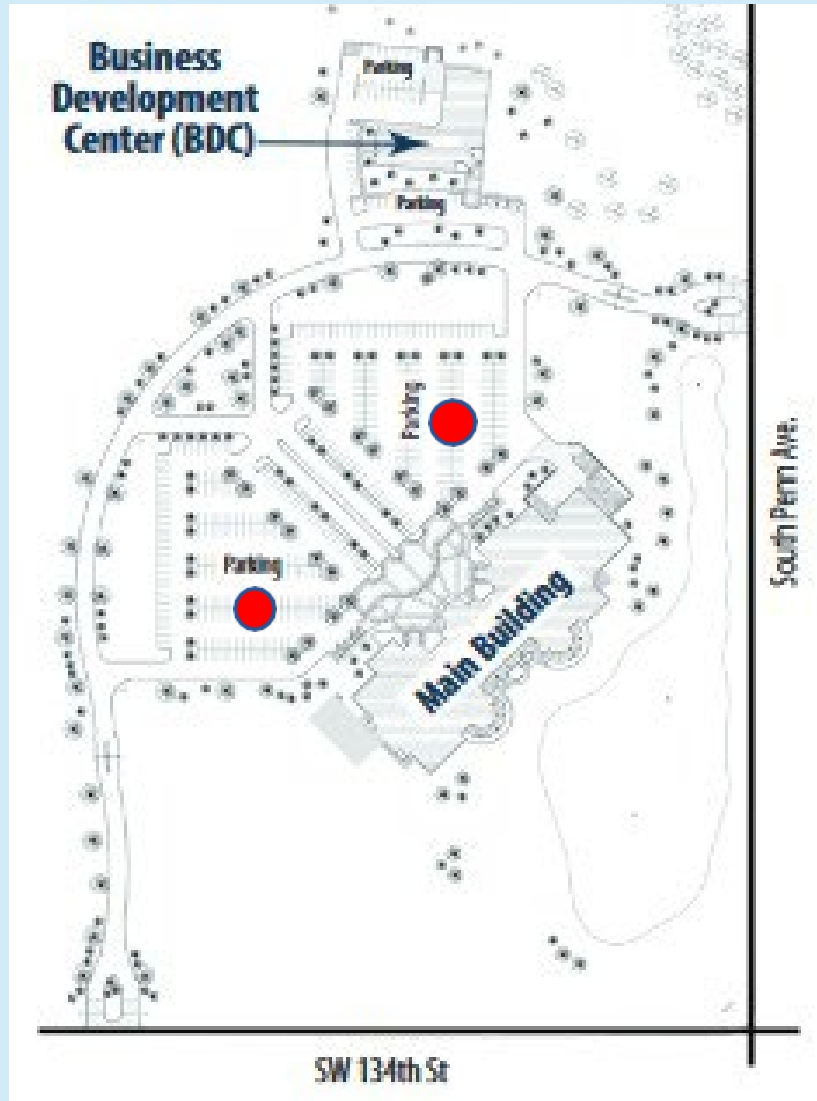

Payment Information

Registration Cost: The cost of the conference is \$150 per person or \$125 per person for groups of 4 or more, registered prior to May 1, 2022 and includes breakfast, lunch, and snacks. For those registering on or after May 1, 2022, the cost of the conference will be \$200. Those using purchase orders will be invoiced after the conference. For questions about registration or payment, please contact:
[Lara Morris, lara.morris@careertech.ok.gov](mailto:lara.morris@careertech.ok.gov) 405-743-5106

Cancellation Policy: If you are registered and will be unable to attend, your payment will be applied to next year's Spring Simulation Conference.

Hotel Information

Holiday Inn and Suites-Moore
621 NW 8th St
Moore, OK 73160
405.735.9400

Room rate: \$95 + tax,
mention OHC room block

ctYOU.org

Simulation Resources: <https://tinyurl.com/mu9jp5hf>

Resource code: **sim22**



REGISTER HERE:

<https://ohcwc.wufoo.com/forms/ohceta-2022-simulation-conference/>